



KREESE TRACT

AIKEN COUNTY, SC

93.70+/- ACRES

\$426,000



PROPERTY DESCRIPTION

The Kreese tract offering is located along Hunt Road in Aiken, SC. The landscape of the property is comprised entirely of well stocked 3-year-old longleaf pine plantation. The property boasts over 2,600 feet of frontage along both sides of Hunt Road allowing for ease of access. In addition to being an excellent timber and pine straw investment. The property is well suited for recreational pursuits and even a permanent residential site in a quiet rural setting.

PROPERTY FEATURES:

- 17 miles from Aiken
- 43 miles from Columbia
- Over 2,600 feet of Hunt Road frontage
- 2.3 miles from I-20

DIRECTIONS

From Aiken take US-1 N for 5.9 miles then turn right to merge onto I-20 east. Continue for 7.1 miles then take exit 29 to Wire Road. In 0.2 miles take a left onto Hutto Pond Rd and continue for 0.3 miles, then take a slight right onto Hunt Rd. In 0.5 miles the property begins on both sides of the road.

CONTACT

Jared Griffith

O: 843-782-5700 ~ M: 864-314-1801

Email: jaredgriffith@crosbylandco.com

www.CrosbyLandCo.com

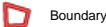

Disclaimer: All information provided is assumed accurate and correct but no assumptions of liability are intended. Neither the seller nor the agent of the seller represent the accuracy of the information provided. No representations or warranties are expressed or implied as to the property, its condition, usage, acreage, or boundaries. This offering is subject to errors and omissions as well as changes including price or withdrawal without notice.



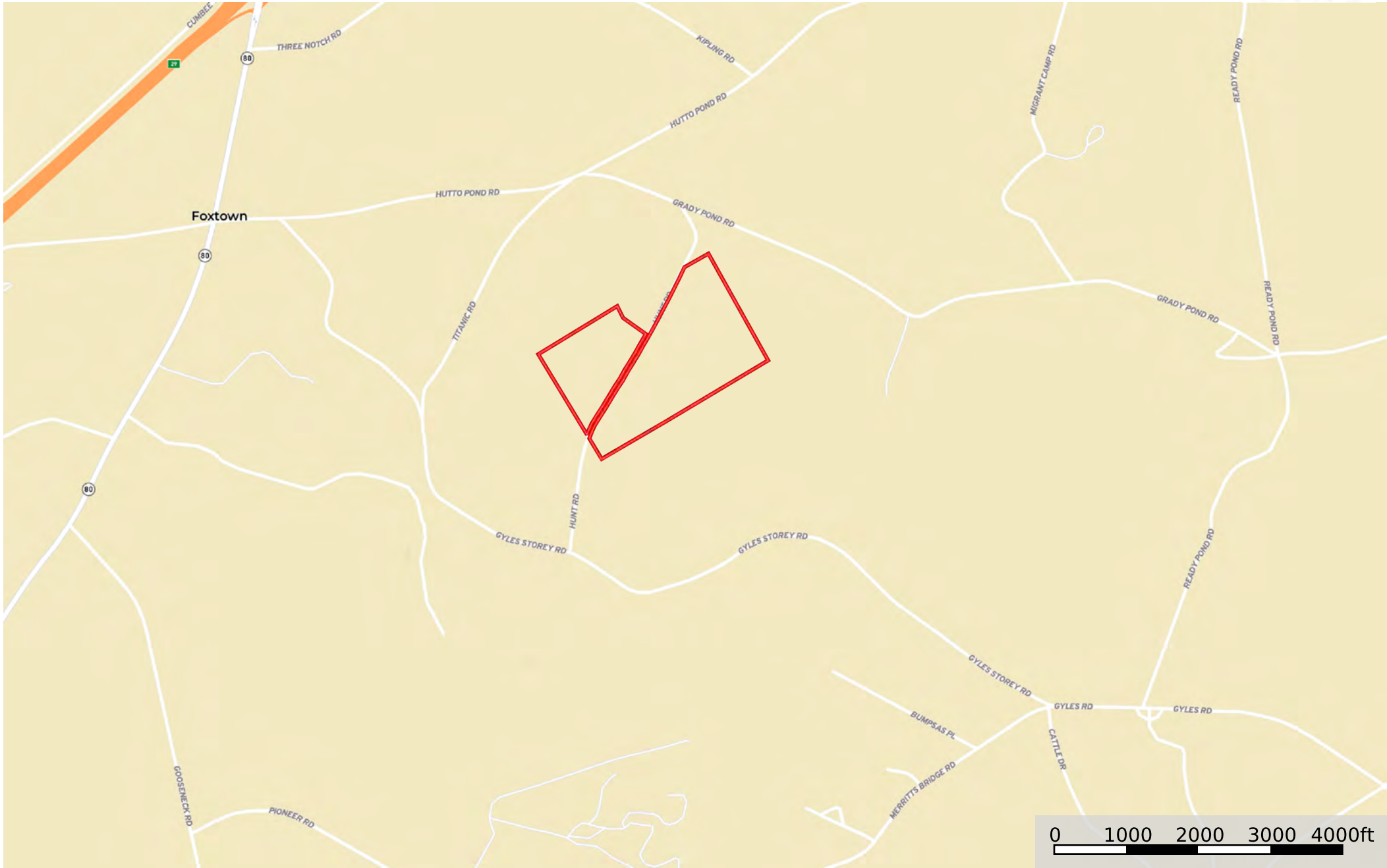



Boundary

Disclaimer: All information provided is assumed accurate and correct but no assumptions of liability are intended. Neither the seller nor the agent of the seller represent the accuracy of the information provided. No representations or warranties are expressed or implied as to the property, its condition, usage, acreage, or boundaries. This offering is subject to errors and omissions as well as changes including price or withdrawal without notice.

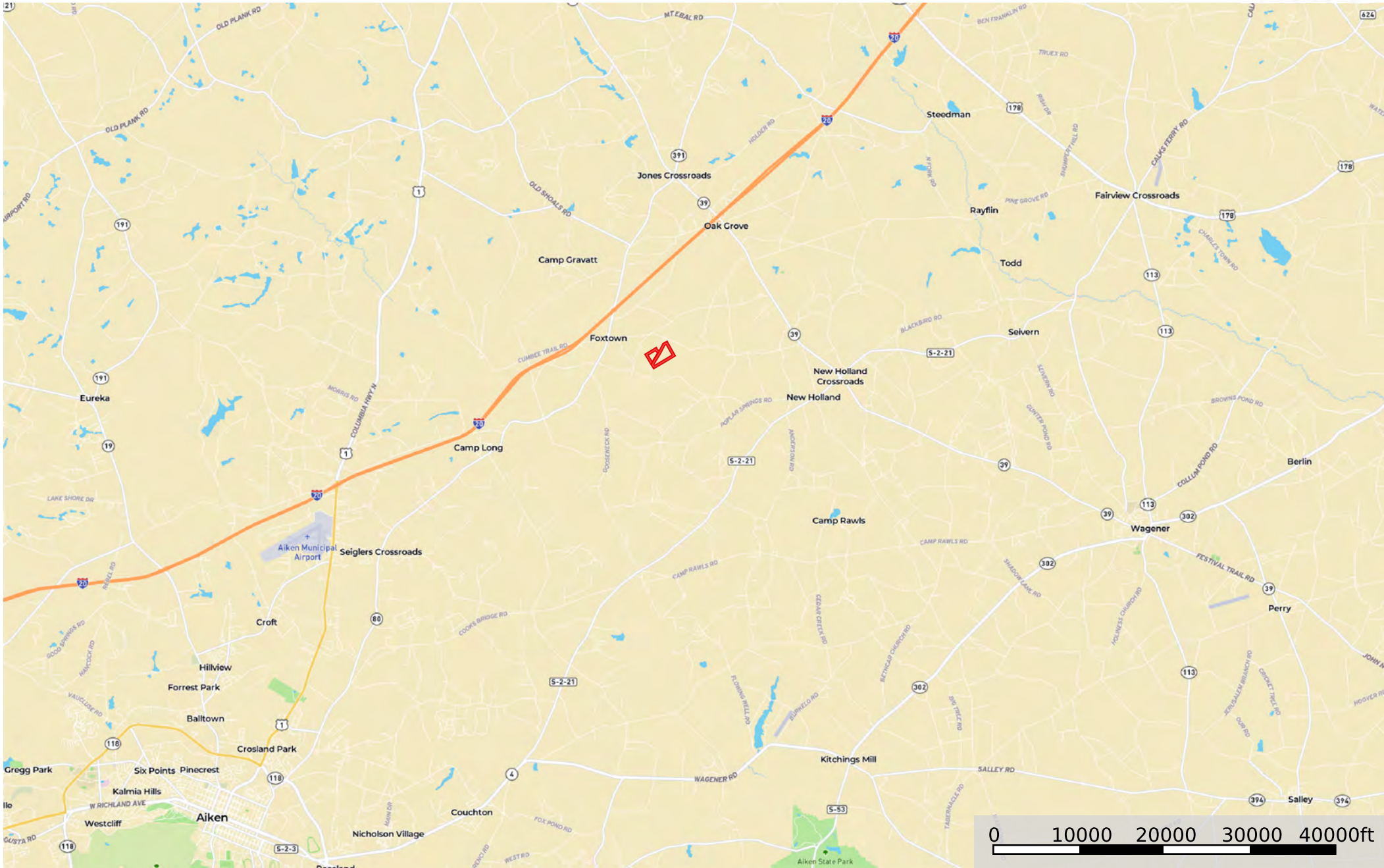
Kreese Tract
Aiken County, South Carolina, 93.7 AC +/-



 Boundary

Disclaimer: All information provided is assumed accurate and correct but no assumptions of liability are intended. Neither the seller nor the agent of the seller represent the accuracy of the information provided. No representations or warranties are expressed or implied as to the property, its condition, usage, acreage, or boundaries. This offering is subject to errors and omissions as well as changes including price or withdrawal without notice.