

22.862 Acres

Tract No. 14

Tract No. 15

LAKE WOOD LANE
(50' Wide Road)

Deawain Henrichs
Tract No. 23A, 23B, 24A & 24 B
Volume 427, Page 815
Official Records

Alvin Marie Henrichs
Tract No. 25A - 14.761 Acres
Volume 551, Page 332
Official Records

Leroy & Marjorie Rycklit
Tract No. 25B - 14.544 Acres
Volume 498, Page 70
Deed Records

Clifford F. Hubenak
Tract No. 16 - 7.725 Acres
Volume 354, Page 788
Official Records

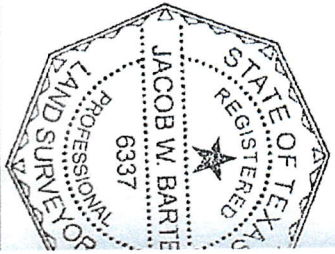

TEXAS LAND SYSTEMS
Surveying & Mapping

STATE OF TEXAS
COUNTY OF COLORADO

Kimberly Menke
COUNTY CLERK
Date: September 22, 2015

Being a 22.862 acre tract of land located in the Ludwig Lidstrand Survey, Abstract No. 384, in Colorado County, Texas; and being all of Tract No. 14 and Tract No. 15 of a subdivision of part of a 439.07 acre tract of land made for John Everett Anderson on April 24, 1978 by Leonard W. Frank RPLS 1669 and sometimes called Sheridan Woods Subdivision. Said 22.862 acre tract also being a part or portion of that land described in Deed dated January 22, 1988 from William M. Hester and wife, Diane Hester to Ervin B. Hernichs and wife, Alvia M. Henrichs, recorded in Volume 551, Page 332 of the Colorado County Deed Records, to which a copy of said subdivision plat was attached and which reference was made for all purposes; said 22.862 acre tract being more particularly described by metes and bounds as follows:

BEGINNING at a 1/2" iron rod found in the North line of a 439.07 acre tract of land conveyed to Don Edd Wiesner et al in Volume 747, Page 138 of the Colorado County Official Records for the Southwest corner of Tract No. 16 a 7.725 acre tract conveyed to Clifford F. Hubenak in Volume 354, Page 788 of the Colorado County Official Records, same being the Southeast corner of Tract No. 15 and the Southeast corner of the herein described tract.

THENCE with the North line of the 439.07 acre Wiesner Tract and the South line of Tract No. 15 and Tract No. 14, S89°53'30"W distance of 1089.23 feet (Basis of Bearing - Called S89°53'30"W 1090.00') to a 1/2" iron rod found for the Southeast corner of Tract No. 13 a 14.441 acre tract conveyed to Jerry L. Brocker et al in Volume 464, Page 277 of the Colorado County Deed Records, same being the Southwest corner of Tract No. 14 and the Southwest corner of the herein described tract.

THENCE with the East line of Tract No. 13 and the West line of Tract No. 14, N01°13'51"E at a distance of 1109.00 feet passing 1/2" iron rod found for reference at the base of a fence corner post, and continuing N01°13'51"E a distance of 19.03 feet for a total distance of 1128.03 feet (Called N01°53'51"E 1111.95' total distance) to a 1/2" iron rod found within the margins of Lake Wood Lane (A 50' wide roadway easement described in Volume 551, Page 332 D.R.) for the Northeast corner of Tract No. 13, same being the Northwest corner of Tract No. 14 and the Northwest corner of the herein described tract.

THENCE with the North line of Tract No. 14 and Tract No. 15, S68°24'03"E a distance of 1000.00 feet (Called S68°35'00"E 1000.00') to point for corner angle in the North line of Tract No. 15 and the herein described tract.

THENCE continuing with the North line of Tract No. 15, S75°52'11"E a distance of 155.00 feet (Called S76°05'00"E 155.00') to a point for the Northwest corner of Tract No. 16, same being the Northeast corner of Tract No. 15 and the Northeast corner of the herein described tract.

THENCE with the West line of Tract No. 16 and the East line of Tract No. 15, S01°12'04"W at a distance of 21.81 feet passing a 1/2" iron rod found for reference, and continuing S01°12'04"W a distance of 698.10 feet for a total distance of 719.91 feet (Called S02°17'11"W 707.42') to the PLACE OF BEGINNING containing 22.862 acres of land.

This survey is valid for this transaction only. All original prints paid for by the client and supplied to the client remain the property of the client. Texas Land Systems retains copyright to all survey documents produced. No part of this document may be reproduced or altered. Survey Plat accompanies these field notes.

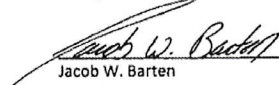
Jacob W. Barten
R.P.L.S. 6337
Firm Registration No. 10193708

STATE OF TEXAS COUNTY OF COLORADO
I hereby certify that this instrument was FILED on the date and time stamped hereon by me, and was duly RECORDED to the Volume and Page of the OFFICIAL RECORDS of Colorado County, Texas and stamped hereon by me, on

OCT 07 2015

Exhibit "A"



KIMBERLY MENKE
COUNTY CLERK, COLORADO COUNTY, TEXAS

VOL 793 PAGE 281