

Whitetail Hunting/ Waterfowl Potential
West 301ST ST S
Depew, OK 74028

\$85,000
27.250± Acres
Creek County



Whitetail Hunting/ Waterfowl Potential Depew, OK / Creek County

SUMMARY

Address

West 301ST ST S

City, State Zip

Depew, OK 74028

County

Creek County

Type

Hunting Land, Undeveloped Land, Recreational Land

Latitude / Longitude

35.724 / -96.5094

Acreage

27.250

Price

\$85,000

Property Website

<https://arrowheadlandcompany.com/property/whitetail-hunting-waterfowl-potential-creek-oklahoma/55068/>

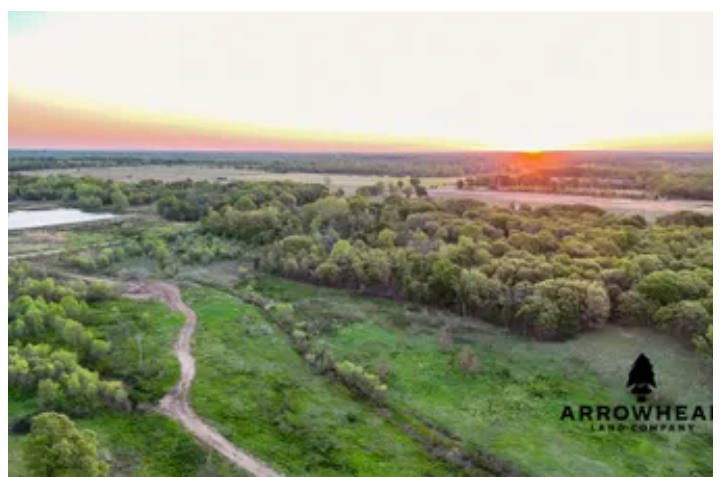

Whitetail Hunting/ Waterfowl Potential Depew, OK / Creek County

PROPERTY DESCRIPTION

Introducing 27.25 +/- acres located in Creek County, Oklahoma. This stunning property offers many opportunities for hunting! There are a few areas where you could plant little food/kill plots to attract wildlife. Also, you can hang a couple of rut stands in the timber to catch mature bucks cruising. What is so appealing about this property is that you could build an 8 +/- acre wetland for waterfowl. Around 8 +/- acres tend to hold water so with some dirt work and building dikes, you could have your very own duck hunting paradise. Don't miss out on owning this versatile property! All showings are by appointment only. If you would like more information or would like to schedule a private viewing, please contact Owen Bellis at [\(918\) 367-7050](tel:9183677050). *Seller is a licensed real estate agent and is immediate family of the listing agent.*



Whitetail Hunting/ Waterfowl Potential
Depew, OK / Creek County

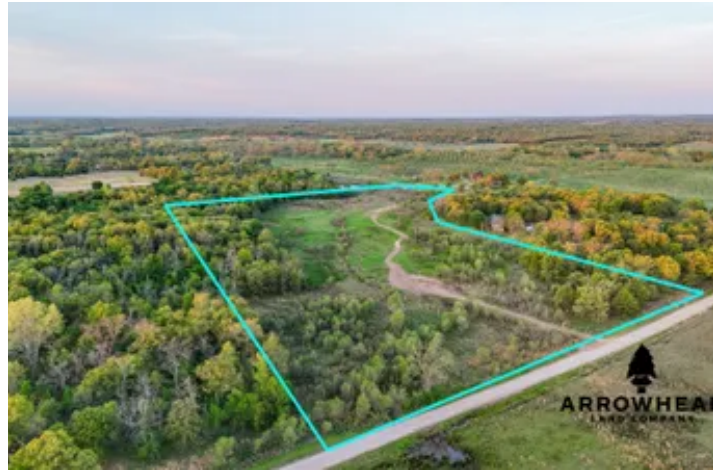
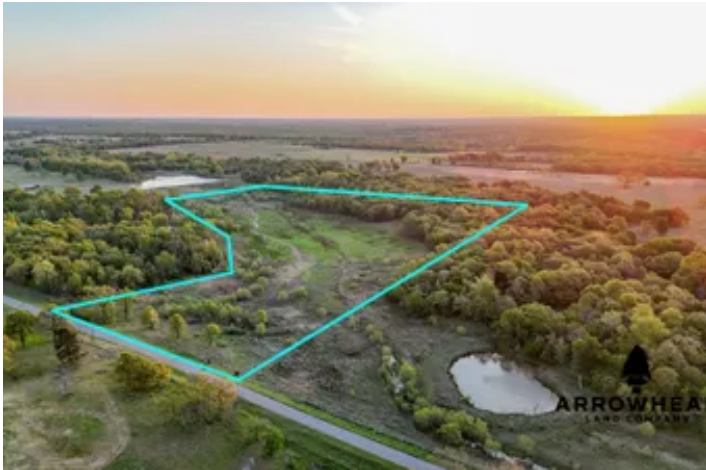

Locator Map

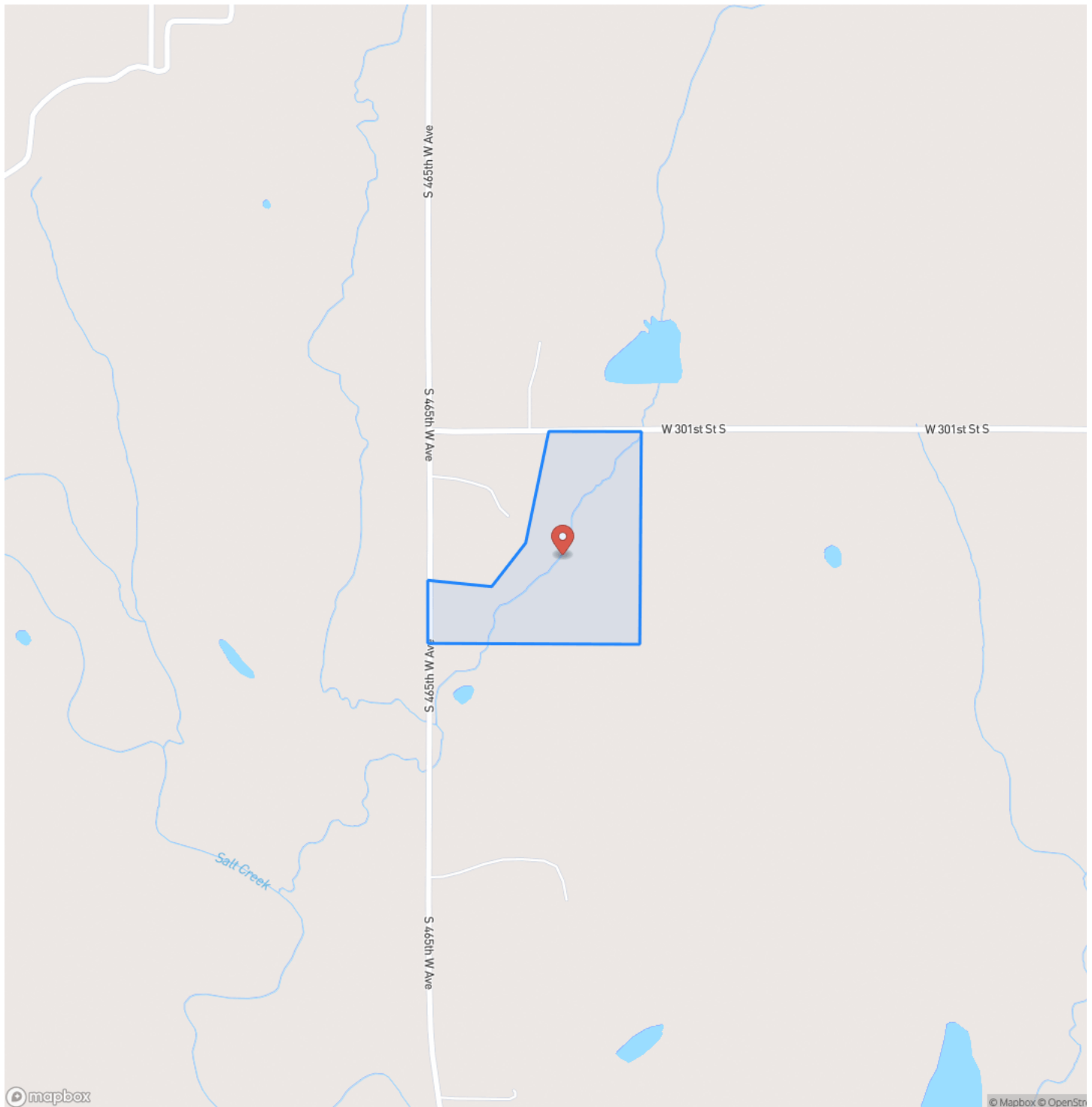

Locator Map

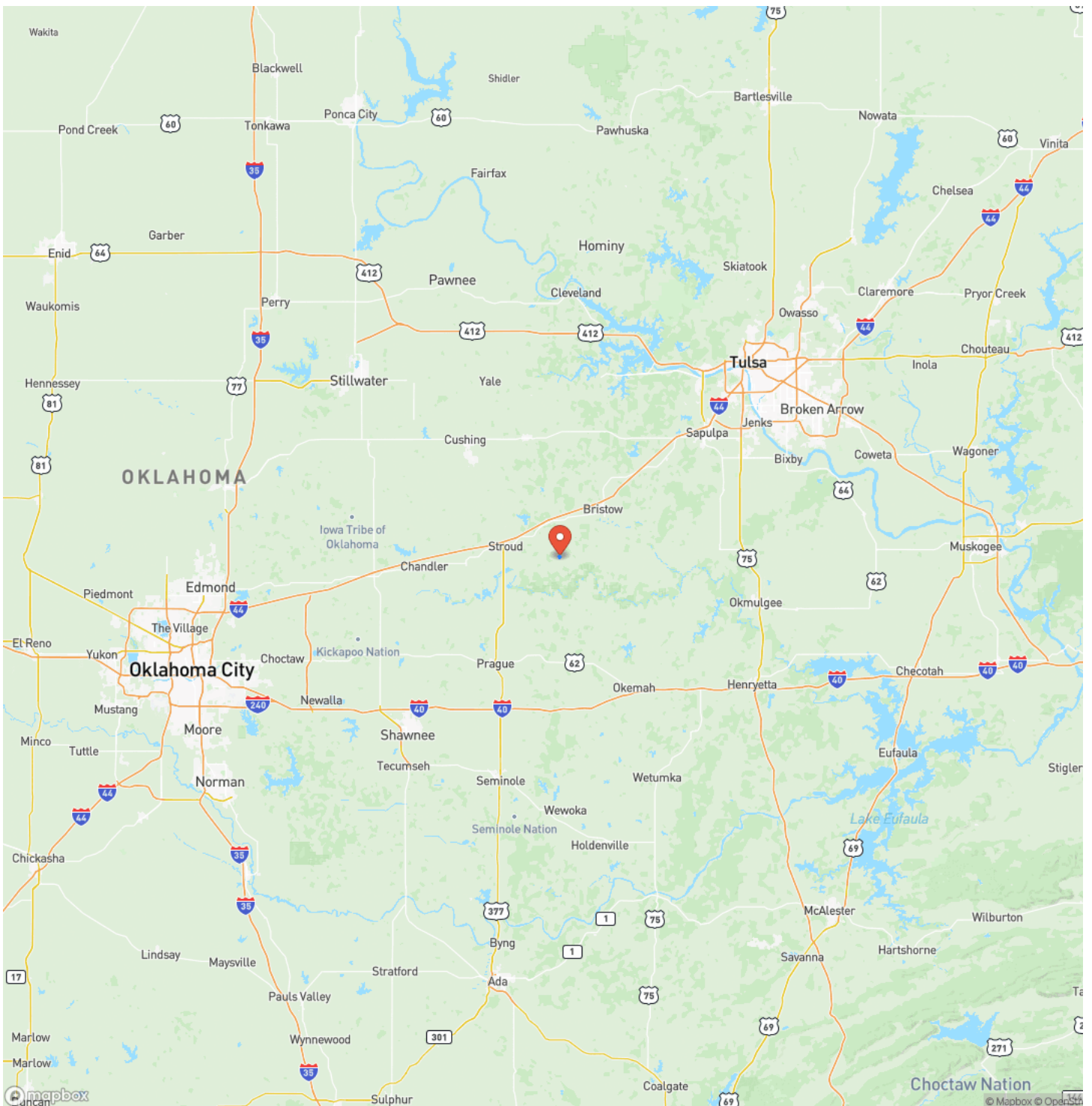

Satellite Map



Whitetail Hunting/ Waterfowl Potential

Depew, OK / Creek County

LISTING REPRESENTATIVE

For more information contact:



Representative

Owen Bellis

Mobile

(918) 367-7050

Email

owen.bellis@arrowheadlandcompany.com

Address

City / State / Zip

Kellyville, OK 74039

NOTES

[illegible]

This image shows a blank sheet of white paper with horizontal ruling lines. The lines are evenly spaced and run across the width of the page. There are no margins, text, or other markings on the paper.



DISCLAIMERS

Information in this brochure is provided solely for information purposes and does not constitute an offer to sell or advertise real estate outside the states in which broker or agent licensed. The information presented has been obtained from sources deemed to be reliable, but is not guaranteed or warranted by the agent, broker, or the sellers of these properties. This offering is subject to errors, omissions, prior sale, price change, correction or withdrawal from the market without notice. All references to age, square footage, income, expenses, acreage, carrying capacity, and land classification, etc. are approximate. Prospective buyers are chargeable with and expected to conduct their own independent investigation of the information and the property and to rely only on those results. Sellers reserve the right to accept or reject any and all offers without liability to any buyer or cooperating broker.

Maps are provided for illustration purposes only, the accuracy is not warranted. Parcels on interactive maps are not adjusted to match aerial backgrounds. This information is for reference purposes only and is not a legal document. Data maps contain errors. The seller and seller's agent are making known to all potential buyers that there may be variations between the location of the existing fence lines and the legal description of the deeded property. Seller and seller's agent make no warranties with regard to the location of the fence lines in relationship to the deeded property lines, nor does the Seller make any warranties or representations with regard to the specific acreage contained within the fenced property lines. Seller is selling the property in an "as is" condition, which includes the location of the fences as they exist. Boundaries shown on the accompanying maps are approximate, based on county parcel data. The maps are not to scale. The accuracy of the maps is not guaranteed. Prospective buyers are encouraged to verify fence lines, deeded property lines and acreages using a licensed surveyor at their own expense.



Arrowhead Land Company
205 E Dewey Ave
Sapulpa, OK 74066
(405) 415-5977
www.arrowheadlandcompany.com

