

Miami Tillable Farm
E 110 Rd
Miami, OK 74354

\$264,600
63± Acres
Ottawa County

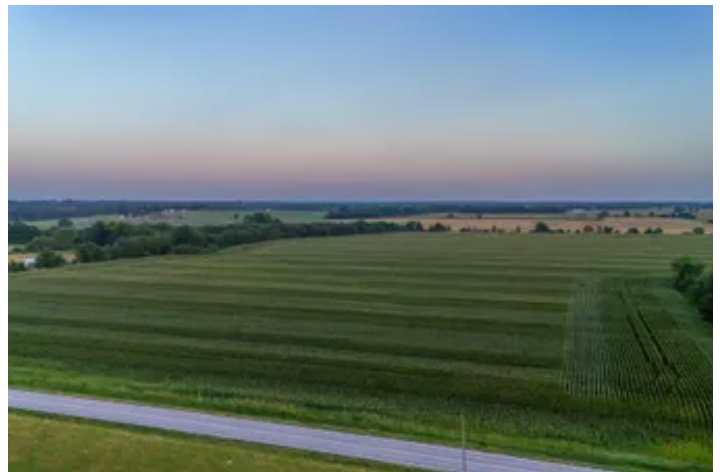
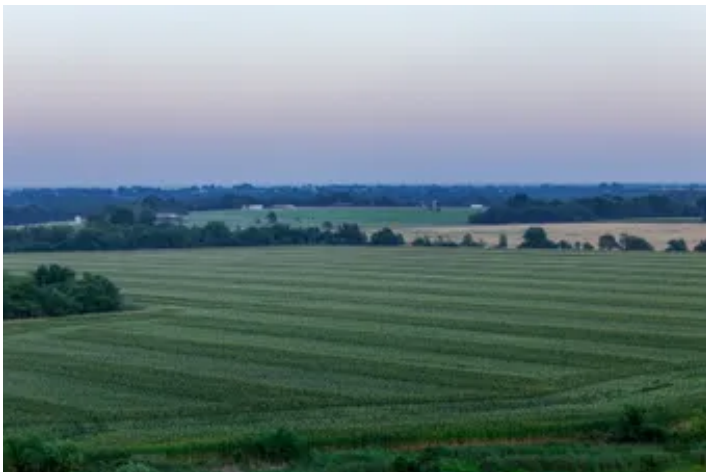

Miami Tillable Farm
Miami, OK / Ottawa County

SUMMARY

Address

E 110 Rd

City, State Zip

Miami, OK 74354

County

Ottawa County

Type

Farms, Undeveloped Land, Hunting Land, Recreational Land

Latitude / Longitude

36.8585 / -94.9394

Acreage

63

Price

\$264,600

Property Website

<https://arrowheadlandcompany.com/property/miami-tillable-farm-ottawa-oklahoma/58867/>

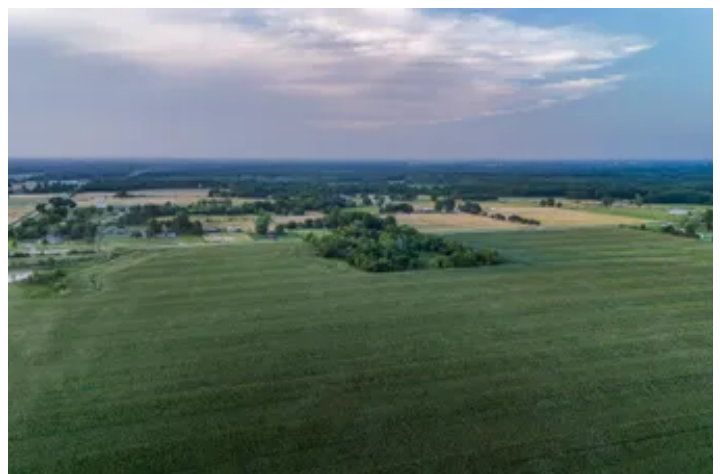

Miami Tillable Farm
Miami, OK / Ottawa County

PROPERTY DESCRIPTION

Located just 10 +/- minutes southwest of Miami, Oklahoma, lies a beautiful 63 +/- acre farm, set up with a nice pond in the northwest corner. Given the great soil, this farm provides you with excellent farming opportunities. The property is currently planted in corn, but will be harvested prior to closing. The soil is mostly class 3 (68%) and roughly (31%) in class 2 soils. Being in close proximity to town amenities, this farm could not be in a better location! Being just 1 hour and 15 minutes from Tulsa, and 25 +/- minutes from Vinita, access to this property is convenient. Here is your chance to own exceptional tillable acreage in Northeast Oklahoma! All showings are by appointment only. If you would like more information or would like to schedule a private viewing please contact Josh Claybrook at [\(918\) 607-1006](tel:9186071006).



Miami Tillable Farm
Miami, OK / Ottawa County



Locator Map

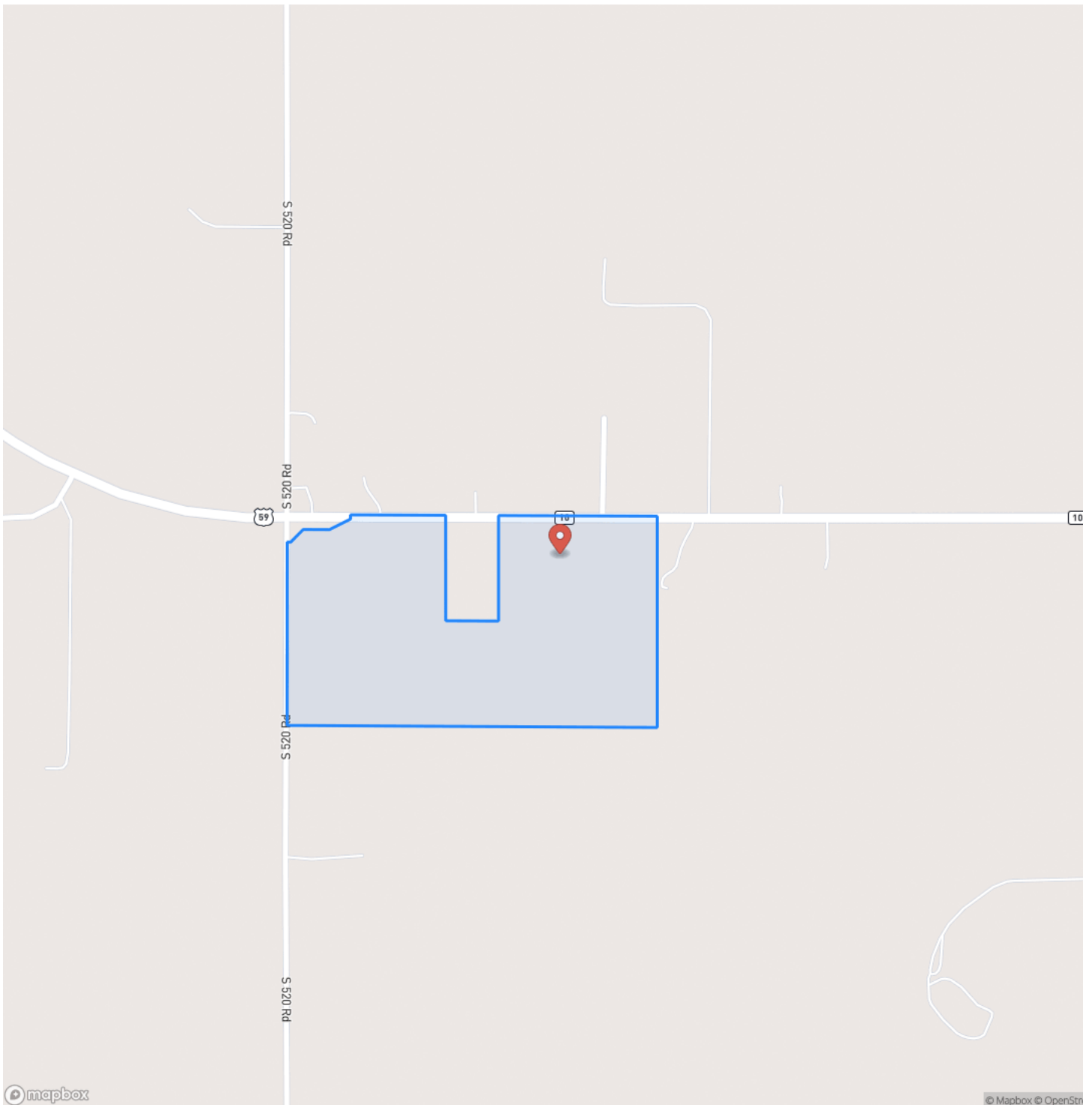

Locator Map

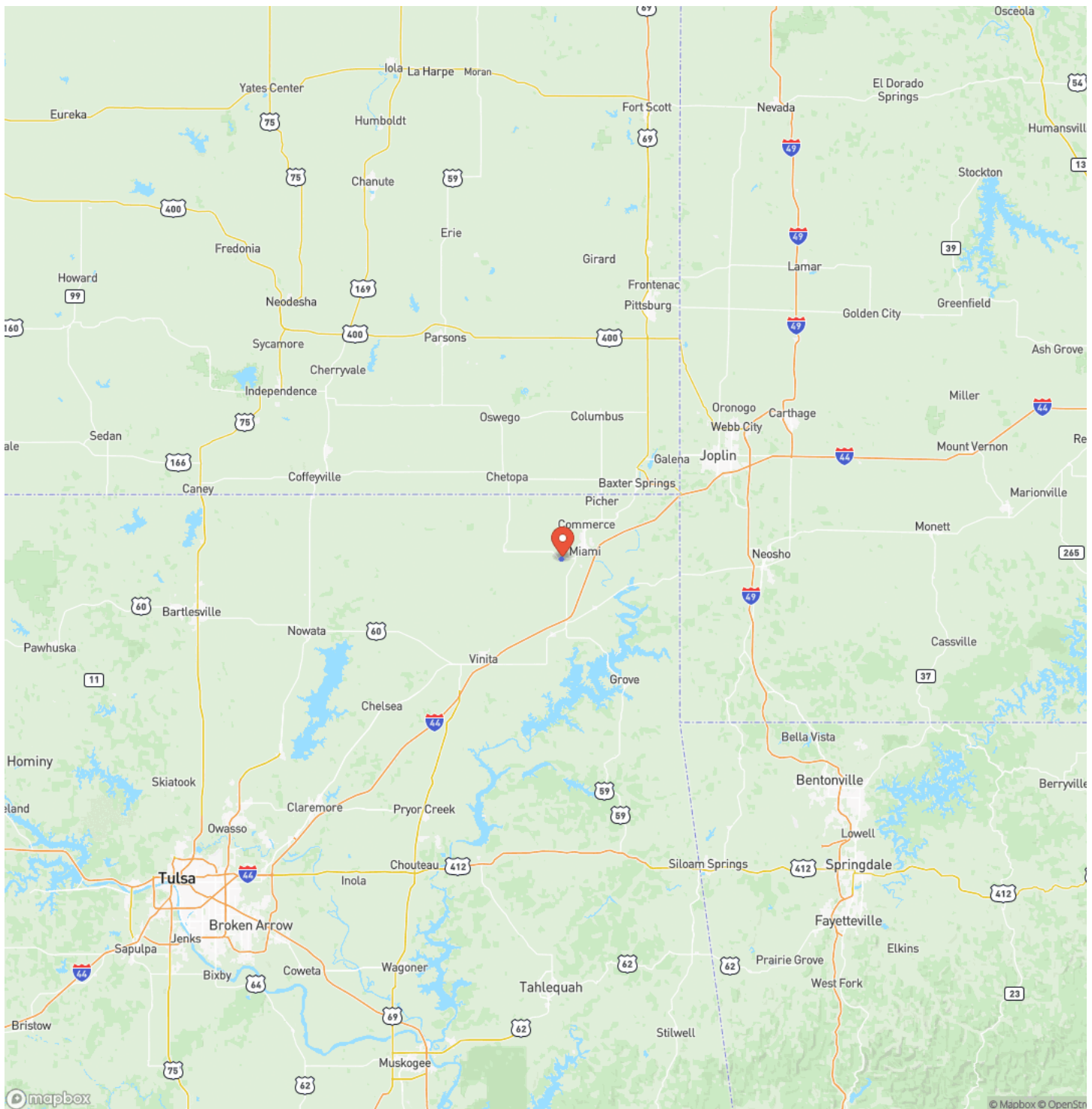

Satellite Map



Miami Tillable Farm
Miami, OK / Ottawa County

LISTING REPRESENTATIVE

For more information contact:



Representative

Josh Claybrook

Mobile

(918) 607-1006

Email

josh.claybrook@arrowheadlandcompany.com

Address

City / State / Zip

Sapulpa, OK 74066

NOTES

[illegible]

[illegible]

DISCLAIMERS

Information in this brochure is provided solely for information purposes and does not constitute an offer to sell or advertise real estate outside the states in which broker or agent licensed. The information presented has been obtained from sources deemed to be reliable, but is not guaranteed or warranted by the agent, broker, or the sellers of these properties. This offering is subject to errors, omissions, prior sale, price change, correction or withdrawal from the market without notice. All references to age, square footage, income, expenses, acreage, carrying capacity, and land classification, etc. are approximate. Prospective buyers are chargeable with and expected to conduct their own independent investigation of the information and the property and to rely only on those results. Sellers reserve the right to accept or reject any and all offers without liability to any buyer or cooperating broker.

Maps are provided for illustration purposes only, the accuracy is not warranted. Parcels on interactive maps are not adjusted to match aerial backgrounds. This information is for reference purposes only and is not a legal document. Data maps contain errors. The seller and seller's agent are making known to all potential buyers that there may be variations between the location of the existing fence lines and the legal description of the deeded property. Seller and seller's agent make no warranties with regard to the location of the fence lines in relationship to the deeded property lines, nor does the Seller make any warranties or representations with regard to the specific acreage contained within the fenced property lines. Seller is selling the property in an "as is" condition, which includes the location of the fences as they exist. Boundaries shown on the accompanying maps are approximate, based on county parcel data. The maps are not to scale. The accuracy of the maps is not guaranteed. Prospective buyers are encouraged to verify fence lines, deeded property lines and acreages using a licensed surveyor at their own expense.



Arrowhead Land Company
205 E Dewey Ave
Sapulpa, OK 74066
(833) 873-2452
www.arrowheadlandcompany.com

