



ROBESON 702
ROBESON COUNTY, NC
297 +/- ACRES
\$445,499



PROPERTY DESCRIPTION

Robeson 702 is located in eastern Robeson County in a quiet rural setting surrounded by large private land holdings managed for timber and recreational use. The upland forested acreage consists of a 17-year-old pine plantation that has been recently thinned. This provides proper spacing and maximizes annual growth for continued revenue streams with proper forest management. Multiple decking areas could be easily converted into wildlife food plots with very little cost. The bottomland adds a rich diversity of habitat for turkey and deer; the White Oak Swamp and Big Swamp Creek confluence is on this property.

This is an excellent opportunity to own a tract of land with very diverse natural attributes in a private setting.

PROPERTY FEATURES:

- Wetland
- Excellent Access
- Trails and Roads
- Merchantable Timber
- Potential Building Sites
- Diverse Wildlife Habitat
- Productive Upland Timberland

DIRECTIONS:

From Lumberton, take NC Highway 41 north, approximately 6.1 miles to Smith Mill Road. Turn left on Smith Mill Road and travel approximately 2.6 miles to Lenards Drive (a dirt road). The property lies near the eastern end of Lenards Drive, approximately 1.2 miles from the intersection of Lenards Drive and Smith Mill Road. You can also copy and paste the following coordinates into your mobile navigation application: 34.688532, -78.833381.

CONTACT

Philip Mead

O: 843.782.5700 - M: 336.653.8839
Email: philipmead@crosbylandco.com
www.CrosbyLandCo.com

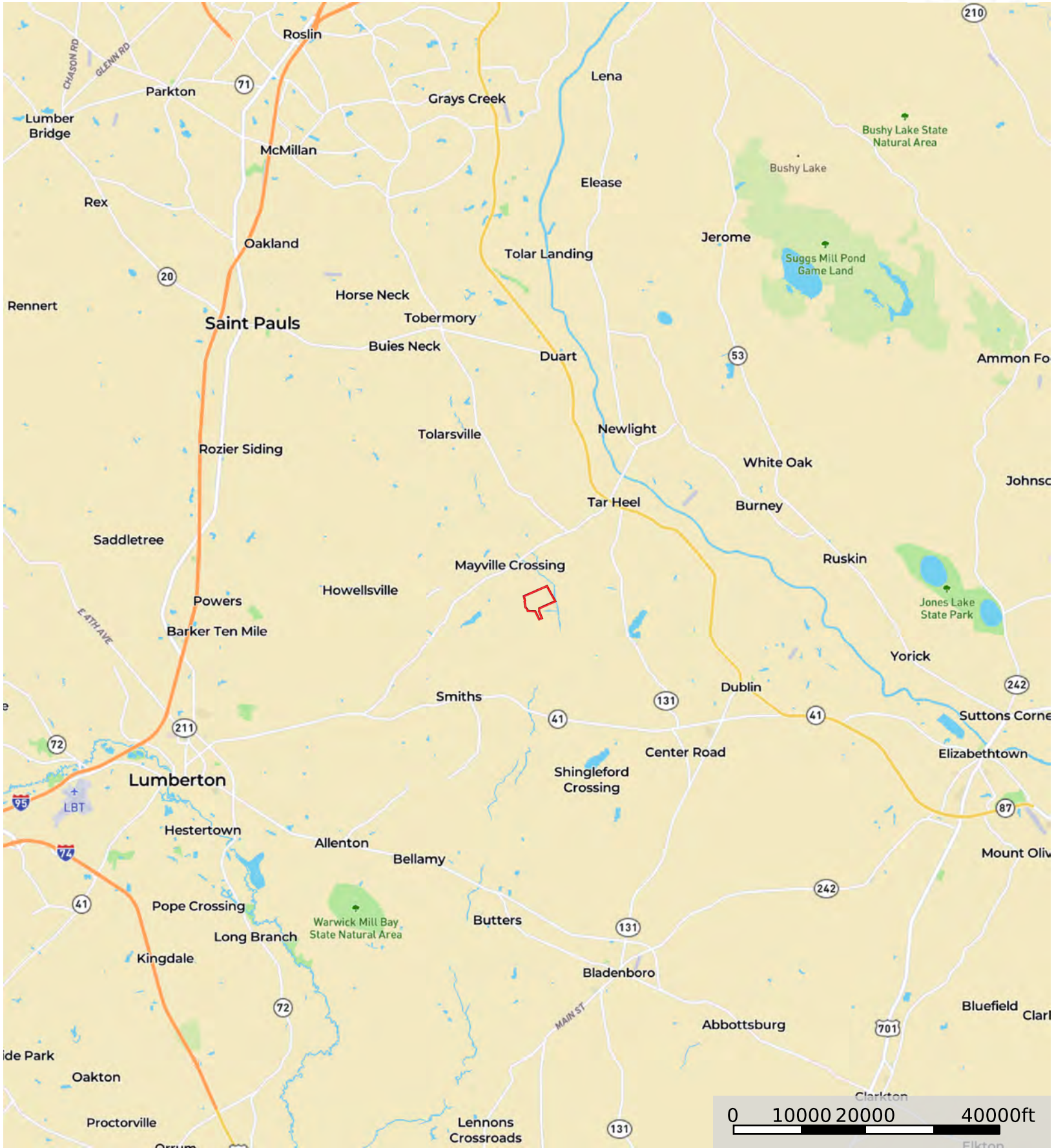

 Boundary

Disclaimer: All information provided is assumed accurate and correct but no assumptions of liability are intended. Neither the seller nor the agent of the seller represent the accuracy of the information provided. No representations or warranties are expressed or implied as to the property, its condition, usage, acreage, or boundaries. This offering is subject to errors and omissions as well as changes including price or withdrawal without notice.

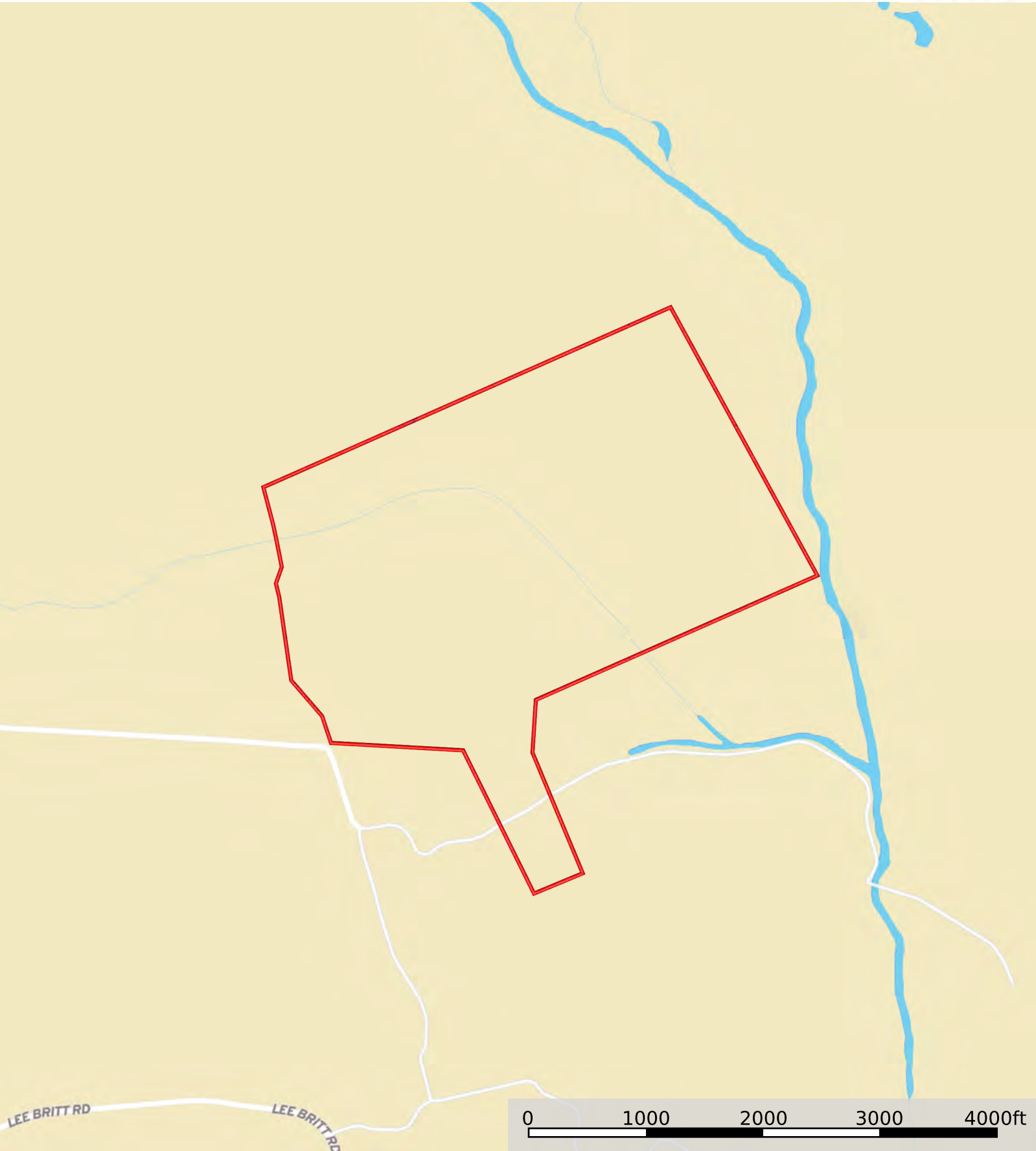

Disclaimer: All information provided is assumed accurate and correct but no assumptions of liability are intended. Neither the seller nor the agent of the seller represent the accuracy of the information provided. No representations or warranties are expressed or implied as to the property, its condition, usage, acreage, or boundaries. This offering is subject to errors and omissions as well as changes including price or withdrawal without notice.



 Boundary

Disclaimer: All information provided is assumed accurate and correct but no assumptions of liability are intended. Neither the seller nor the agent of the seller represent the accuracy of the information provided. No representations or warranties are expressed or implied as to the property, its condition, usage, acreage, or boundaries. This offering is subject to errors and omissions as well as changes including price or withdrawal without notice.

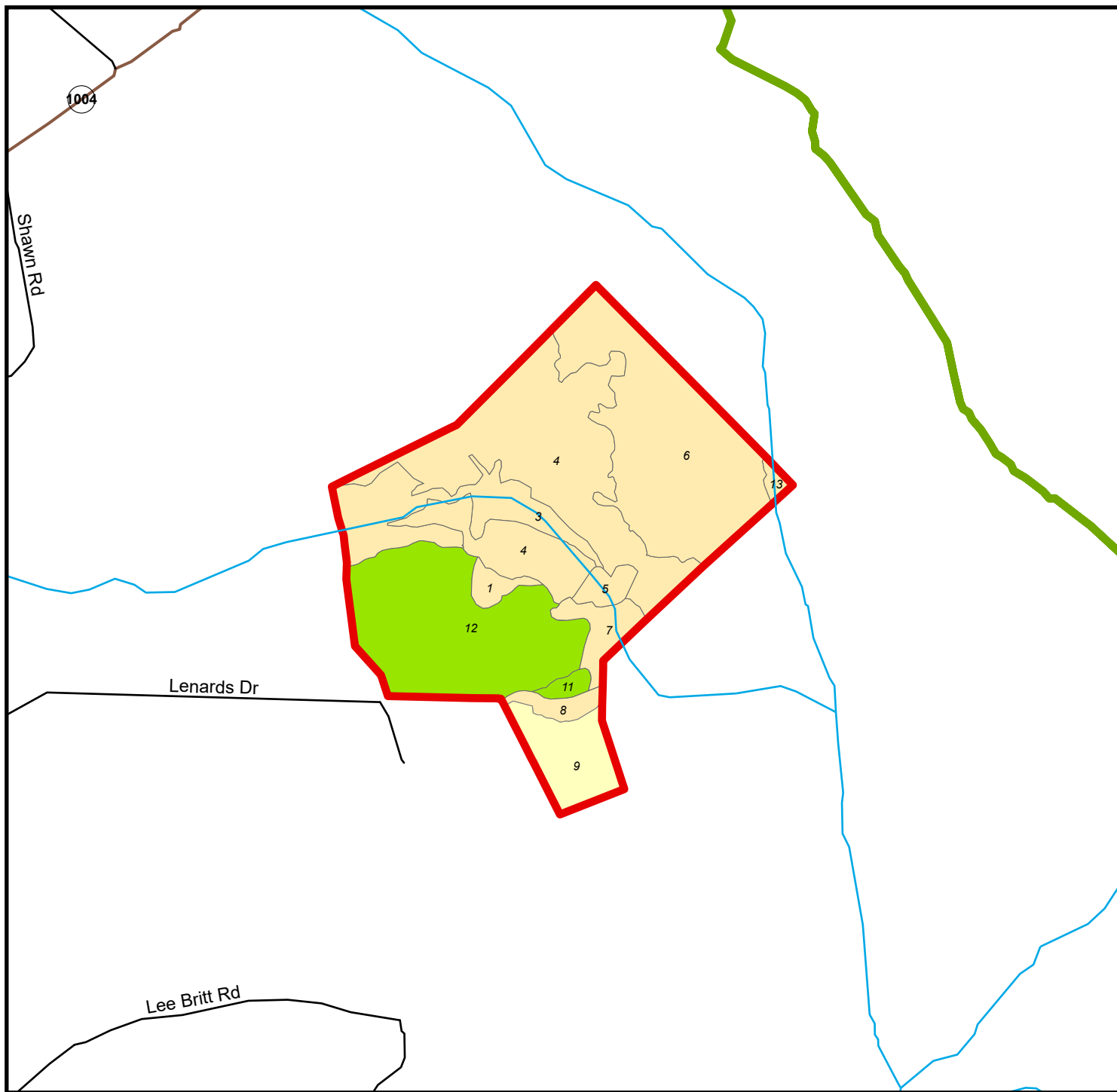

Robeson 702
Robeson County, NC - approx. 296.5 acres +/-

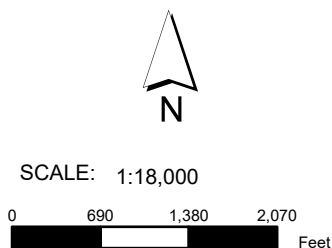
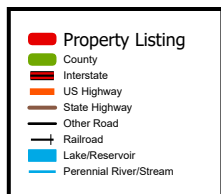

Stand #	Cover Type	Age	Acres
1	Hardwood	68	3.8
3	Hardwood	68	28.5
4	Hardwood	20	87.3
5	Hardwood	39	4.4
6	Hardwood	11	71.5
7	Hardwood	11	8.6
8	Hardwood	39	4.5
9	Open		18.3
11	Pine Plantation >= 12 yr	34	2.5
12	Pine Plantation >= 12 yr	17	65.4
13	Hardwood	20	1.8

Smaller stands have been excluded to fit in the allowable space