

Mount Vernon Lot
0 Sandusky St. N.
Mount Vernon, OH 43050

\$85,900
3± Acres
Knox County



Mount Vernon Lot
Mount Vernon, OH / Knox County

SUMMARY

Address

0 Sandusky St. N.

City, State Zip

Mount Vernon, OH 43050

County

Knox County

Type

Undeveloped Land, Lot, Business Opportunity

Latitude / Longitude

40.4104 / -82.4975

Acreage

3

Price

\$85,900

Property Website

<https://arrowheadlandcompany.com/property/mount-vernon-lot-knox-ohio/98081/>

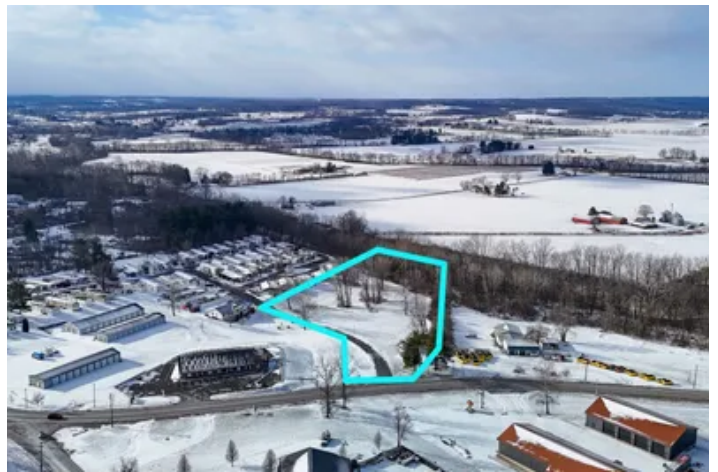

Mount Vernon Lot

Mount Vernon, OH / Knox County

PROPERTY DESCRIPTION

Take a look at this spacious 3 +/- acre lot in Knox County, Ohio! Ideally positioned directly off State Route 13, the property offers seamless travel with quick access to Interstate 77 and the major employment hubs of Mount Vernon and Fredericktown, both just minutes away. While you'll enjoy proximity to local amenities like Ariel Foundation Park and the Kokosing Gap Trail, a short drive south puts you in the heart of Columbus for big-city dining or a Saturday afternoon watching the Ohio State Buckeyes. This build-ready lot is nestled beside modern developments and features convenient access to public utilities, making it an exceptional find for investors or custom home builders. Act now-this prime location is priced to sell! Here is your chance to secure your piece of Ohio's beautiful landscape! All showings are by appointment only. If you would like more information or would like to schedule a private viewing please contact Brian Whitt at [\(937\) 545-7764](tel:937-545-7764).

Disclaimer: The boundary lines shown are approximate and are provided for general reference only. Arrowhead Land Company makes no representations or warranties, express or implied, as to the accuracy, completeness, or reliability of those property lines. Buyers are advised to obtain an independent survey to verify exact property boundaries.

Mount Vernon Lot
Mount Vernon, OH / Knox County



Locator Map

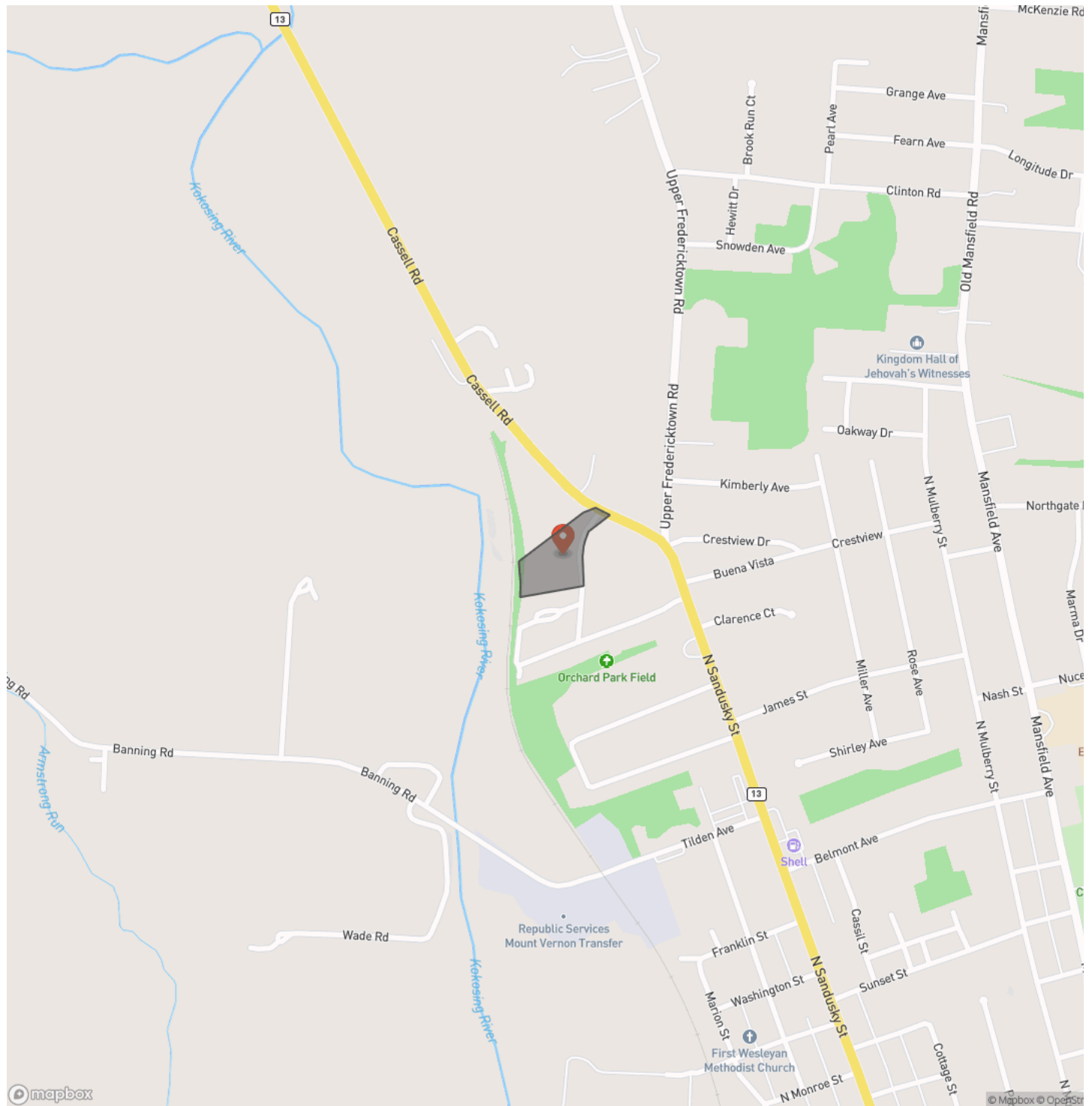

Locator Map

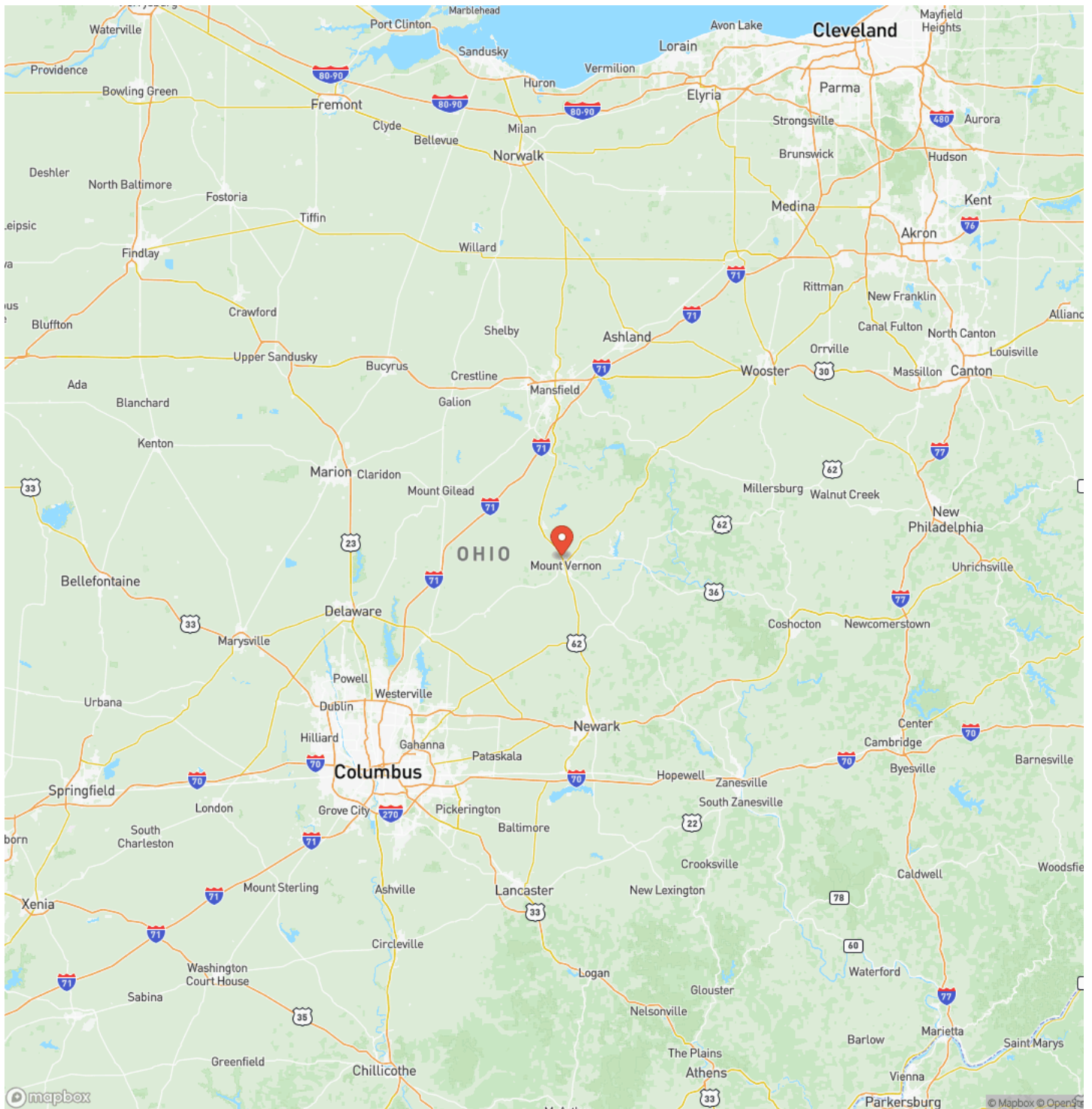

Satellite Map



LISTING REPRESENTATIVE

For more information contact:



Representative

Brian Whitt

Mobile

(423) 494-7793

Email

brian.whitt@arrowheadlandcompany.com

Address

City / State / Zip

NOTES

[illegible]

[illegible]

DISCLAIMERS

Information in this brochure is provided solely for information purposes and does not constitute an offer to sell or advertise real estate outside the states in which broker or agent licensed. The information presented has been obtained from sources deemed to be reliable, but is not guaranteed or warranted by the agent, broker, or the sellers of these properties. This offering is subject to errors, omissions, prior sale, price change, correction or withdrawal from the market without notice. All references to age, square footage, income, expenses, acreage, carrying capacity, and land classification, etc. are approximate. Prospective buyers are chargeable with and expected to conduct their own independent investigation of the information and the property and to rely only on those results. Sellers reserve the right to accept or reject any and all offers without liability to any buyer or cooperating broker.

Maps are provided for illustration purposes only, the accuracy is not warranted. Parcels on interactive maps are not adjusted to match aerial backgrounds. This information is for reference purposes only and is not a legal document. Data maps contain errors. The seller and seller's agent are making known to all potential buyers that there may be variations between the location of the existing fence lines and the legal description of the deeded property. Seller and seller's agent make no warranties with regard to the location of the fence lines in relationship to the deeded property lines, nor does the Seller make any warranties or representations with regard to the specific acreage contained within the fenced property lines. Seller is selling the property in an "as is" condition, which includes the location of the fences as they exist. Boundaries shown on the accompanying maps are approximate, based on county parcel data. The maps are not to scale. The accuracy of the maps is not guaranteed. Prospective buyers are encouraged to verify fence lines, deeded property lines and acreages using a licensed surveyor at their own expense.

Arrowhead Land Company
205 E Dewey Ave
Sapulpa, OK 74066
(833) 873-2452
www.arrowheadlandcompany.com

