

Scenic 77 Overlook
Highway 77
Marietta, OK 73448

\$69,500
6± Acres
Love County

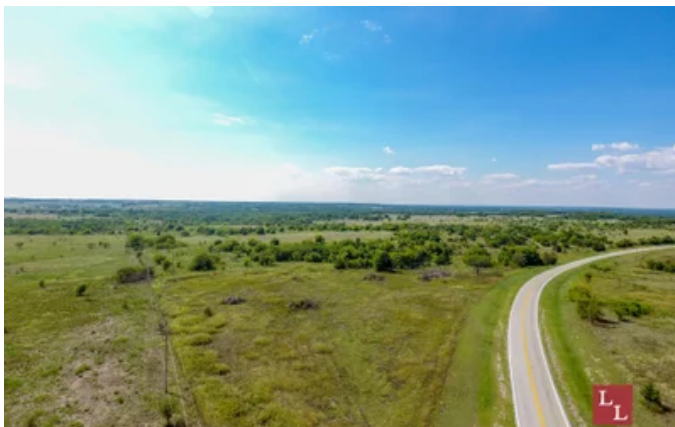

Scenic 77 Overlook Marietta, OK / Love County

SUMMARY

Address

Highway 77

City, State Zip

Marietta, OK 73448

County

Love County

Type

Ranches, Undeveloped Land

Latitude / Longitude

33.9731 / -97.0941

Taxes (Annually)

4

Acreage

6

Price

\$69,500



Scenic 77 Overlook

Marietta, OK / Love County

PROPERTY DESCRIPTION

The Scenic 77 overlook is an outstanding homesite overlooking Love County, Oklahoma. Located just 2 miles south of Lake Murray State Park this property would also be an ideal location for multiple vacation rentals. This property is surrounded by 2 large ranches, which ensures privacy is secured for the foreseeable future.

Location:

- *Oklahoma City - 114 miles
- *DFW - 85 miles
- *Marietta - 4 miles
- *Lake Murray State Park - 2.5 miles

Access:

- *Scenic Hwy 77

Utilities:

- *Rural water
- *Electric Available
- *Fire Hydrant

Climate:

- *Approximately +/-38 inches of annual precipitation

Minerals:

- *Surface Only

Wildlife:

- *Whitetail Deer
- *Wild Turkey
- *Dove
- *Quail
- *Wild Hogs

Terrain:

- *Topography ranging from 840' -860'
- *Upland native grasses
- *Scattered cross timbers



Improvements:

*NA

Equipment:

*NA

If you are not already on the Legendary Land Company website, please follow the "Property Website" link.

When purchasing a property listed by Legendary Land Company, a Buyer's Broker, if applicable, must be identified on first contact and must be present at the initial showing of the property in order to participate in a real estate commission. If these conditions are not met, compensation, if any, will be at the sole discretion of Legendary Land Company.



Scenic 77 Overlook
Marietta, OK / Love County



Locator Maps

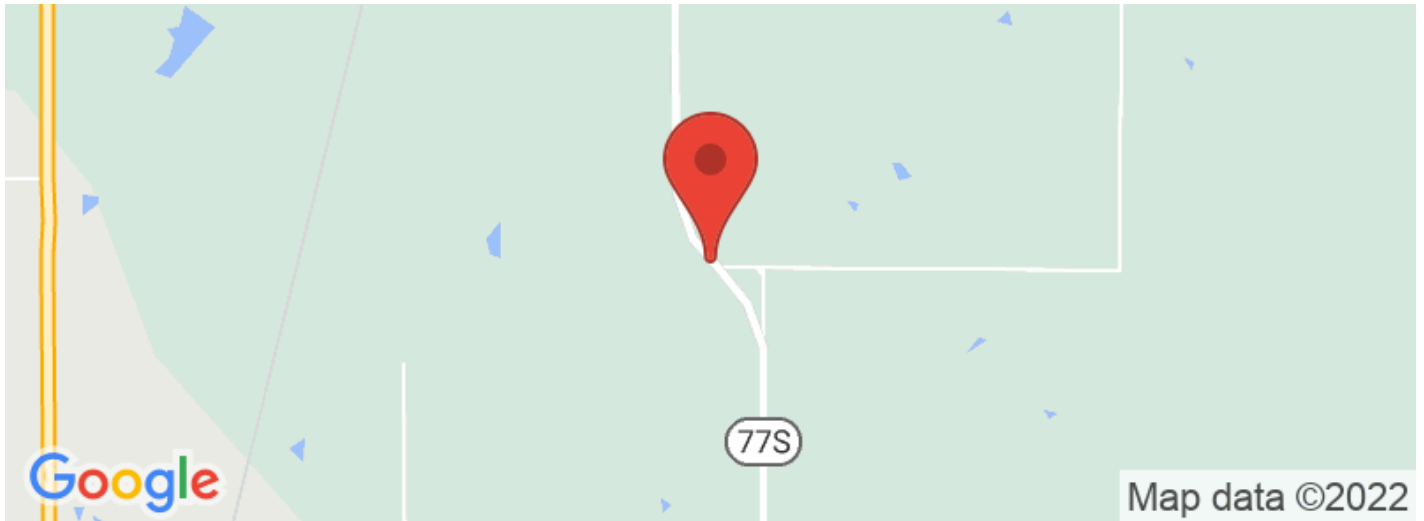

Aerial Maps

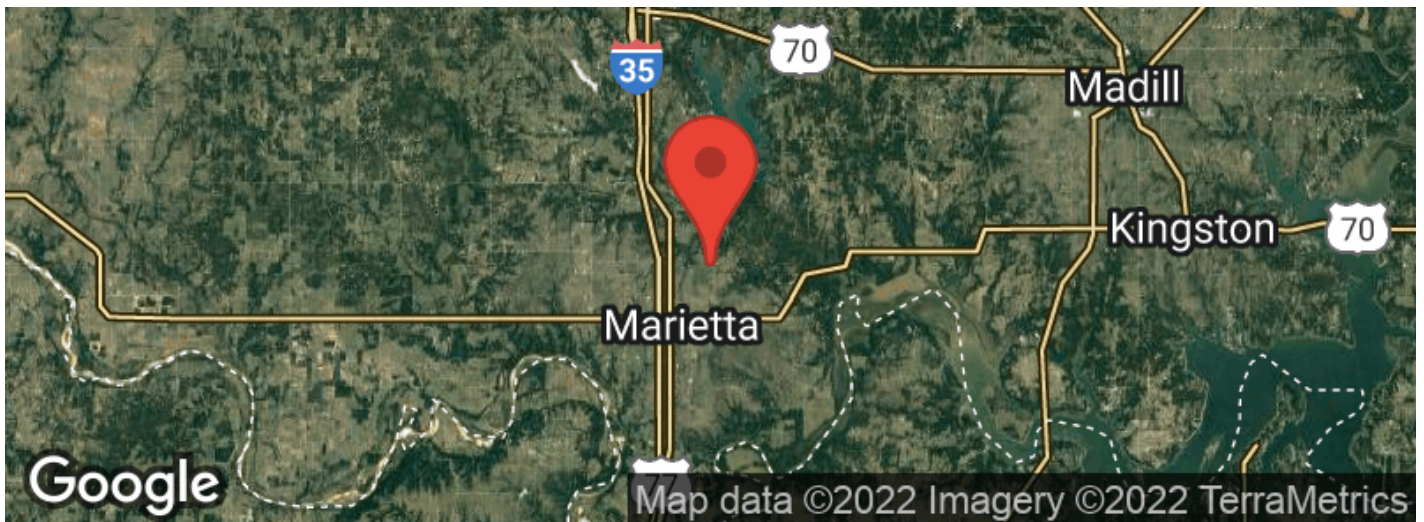

LISTING REPRESENTATIVE

For more information contact:



Representative

Cody Gillham

Mobile

(580) 276-7584

Email

cody@Legendary.Land

Address

111 D St. SW

City / State / Zip

Ardmore, OK 73401

NOTES

NOTES

[illegible]

DISCLAIMERS

Information in this brochure is provided solely for information purposes and does not constitute an offer to sell or advertise real estate outside the states in which broker or agent licensed. The information presented has been obtained from sources deemed to be reliable, but is not guaranteed or warranted by the agent, broker, or the sellers of these properties. This offering is subject to errors, omissions, prior sale, price change, correction or withdrawal from the market without notice. All references to age, square footage, income, expenses, acreage, carrying capacity, and land classification, etc. are approximate. Prospective buyers are chargeable with and expected to conduct their own independent investigation of the information and the property and to rely only on those results. Sellers reserve the right to accept or reject any and all offers without liability to any buyer or cooperating broker.

Maps are provided for illustration purposes only, the accuracy is not warranted. Parcels on interactive maps are not adjusted to match aerial backgrounds. This information is for reference purposes only and is not a legal document. Data maps contain errors. The seller and seller's agent are making known to all potential buyers that there may be variations between the location of the existing fence lines and the legal description of the deeded property. Seller and seller's agent make no warranties with regard to the location of the fence lines in relationship to the deeded property lines, nor does the Seller make any warranties or representations with regard to the specific acreage contained within the fenced property lines. Seller is selling the property in an "as is" condition, which includes the location of the fences as they exist. Boundaries shown on the accompanying maps are approximate, based on county parcel data. The maps are not to scale. The accuracy of the maps is not guaranteed. Prospective buyers are encouraged to verify fence lines, deeded property lines and acreages using a licensed surveyor at their own expense.



Legendary Land Co
1021 Regal Rd
Yukon, OK 73099
(405) 206-0914
<http://legendary.land>

