

Soils Map

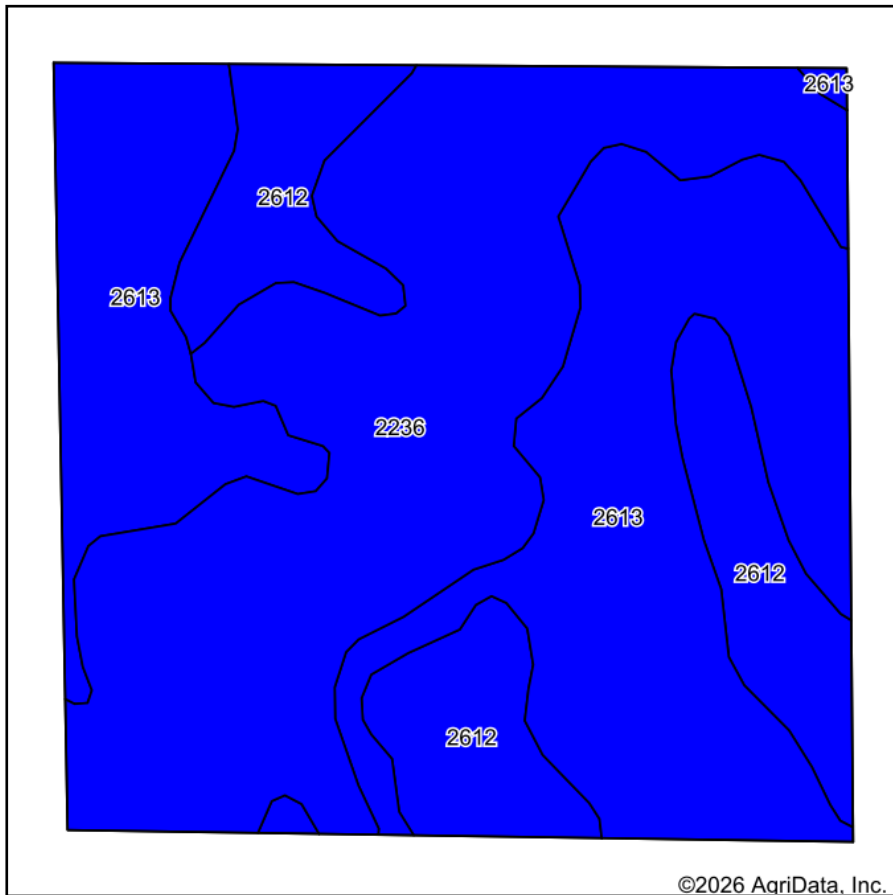

Soils data provided by USDA and NRCS.

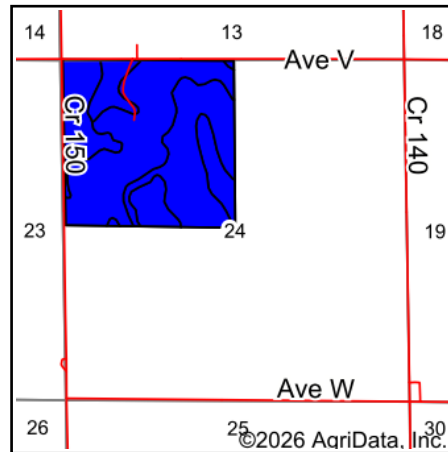

State: **Kansas**
 County: **Rush**
 Location: **24-19S-20W**
 Township: **Alexander-Belle Prairie**
 Acres: **156.21**
 Date: **2/2/2026**



RED CEDAR LAND CO.

Maps Provided By:



© AgriData, Inc. 2025

www.AgriDataInc.com



©2026 AgriData, Inc.

Area Symbol: KS165, Soil Area Version: 24

Code	Soil Description	Acres	Percent of field	Non-Irr Class Legend	Non-Irr Class	Irr Class	*n NCCPI Overall	*n NCCPI Corn	*n NCCPI Small Grains
2613	Harney silt loam, 1 to 3 percent slopes	66.12	42.3%		Ile	Ile	68	51	61
2236	Roxbury silt loam, occasionally flooded	61.98	39.7%		IIw	IIw	76	50	56
2612	Harney silt loam, 0 to 1 percent slopes	28.11	18.0%		IIc	I	69	51	61
Weighted Average					2.00	1.82	*n 71.4	*n 50.6	*n 59

*n: The aggregation method is "Weighted Average using all components"

Soils data provided by USDA and NRCS.