

Soils Map

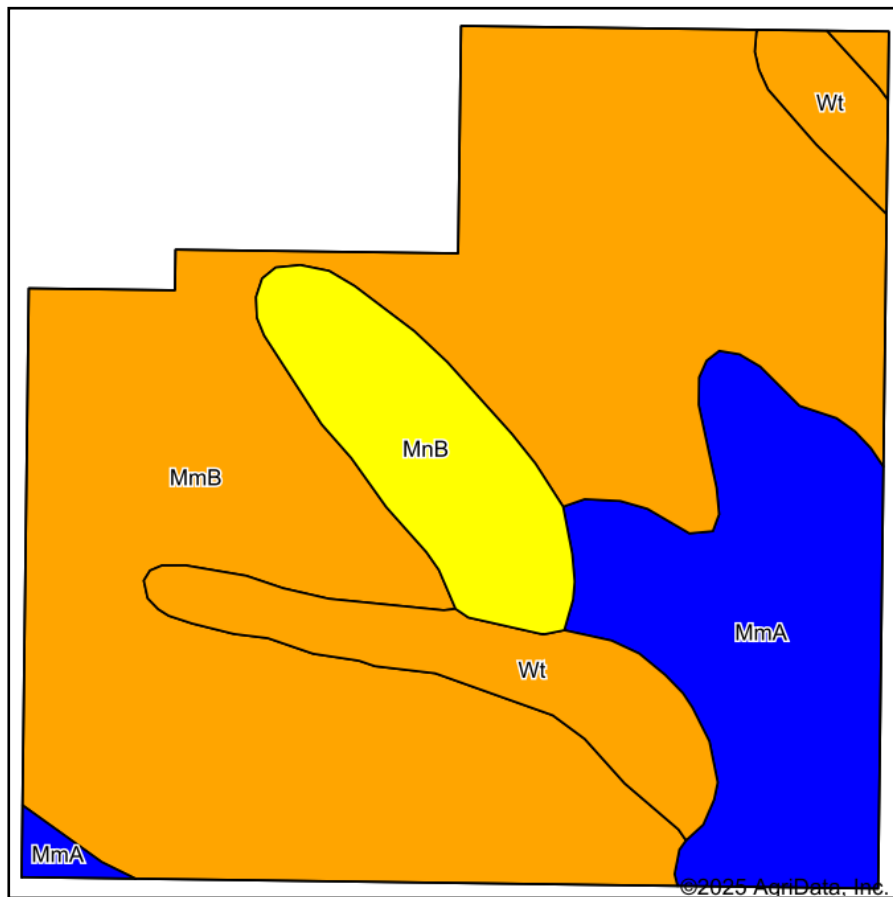

Soils data provided by USDA and NRCS.

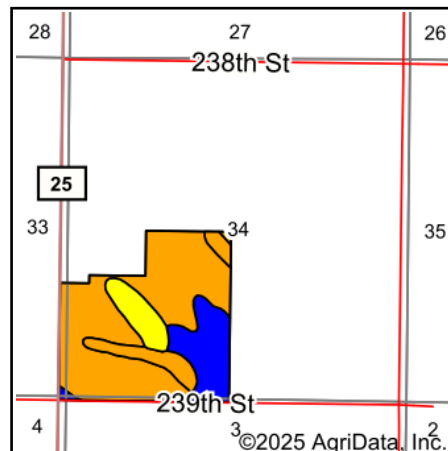

State: **South Dakota**
 County: **Lyman**
 Location: **34-106N-78W**
 Township: **Northwest Lyman**
 Acres: **137.21**
 Date: **7/11/2025**



Maps Provided By:



Area Symbol: SD085, Soil Area Version: 25

Code	Soil Description	Acres	Percent of field	PI Legend	Restrictive Layer	Soil Drainage	Non-Irr Class *c	Irr Class *c	Range Production (lbs/acre/yr)	Productivity Index	*n NCCPI Overall
MmB	Millboro silty clay, 3 to 6 percent slopes	88.68	64.6%		> 6.5ft.	Well drained	IIle	IIle	2887	79	32
MmA	Millboro silty clay, 0 to 3 percent slopes	24.14	17.6%		> 6.5ft.	Well drained	IIIs	IIIs	2770	85	36
Wt	Witten silty clay, 0 to 3 percent slopes	12.59	9.2%		> 6.5ft.	Moderately well drained	IIs	IIs	2970	79	37
MnB	Boro-Millboro silty clays, 3 to 6 percent slopes	11.80	8.6%		> 6.5ft.	Well drained	IIle	IIle	2845	68	33
Weighted Average							2.91	2.91	2870.4	79.1	*n 33.2

*n: The aggregation method is "Weighted Average using all components"

*c: Using Capabilities Class Dominant Condition Aggregation Method