

**UNDER CONTRACT!! 69.03 acres of Recreational Land
For Sale in Person County NC!
Off Scott Rd
Semora, NC 27343**

\$299,900
69.03± Acres
Caswell County



**UNDER CONTRACT!! 69.03 acres of Recreational Land For Sale in Person County NC!
Semora, NC / Caswell County**

SUMMARY

Address

Off Scott Rd

City, State Zip

Semora, NC 27343

County

Caswell County

Type

Hunting Land, Recreational Land, Undeveloped Land

Latitude / Longitude

36.4994 / -79.108

Acreage

69.03

Price

\$299,900

Property Website

<https://www.mossoakproperties.com/property/under-contract-69-03-acres-of-recreational-land-for-sale-in-person-county-nc-caswell/north-carolina/99464/>



Area Map

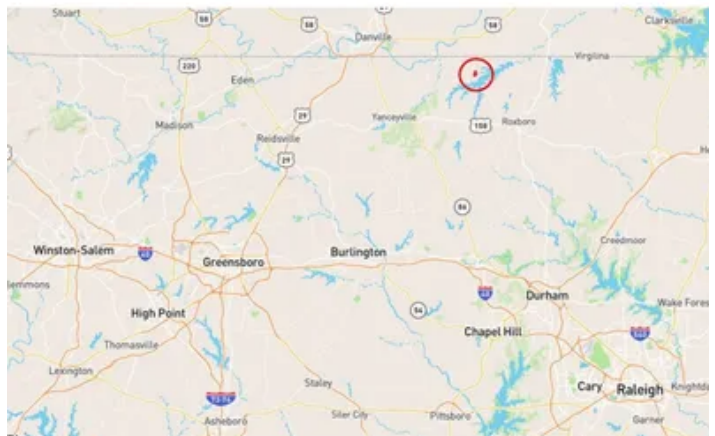

UNDER CONTRACT!! 69.03 acres of Recreational Land For Sale in Person County NC! Semora, NC / Caswell County

PROPERTY DESCRIPTION

This expansive recreational property has all it needs with a cleared area for a food plot, plentiful bedding, and a beautiful creek running through its interior to make this a great fit for the avid outdoorsman!

Discover the potential for this unique hunting property in northwest Person County!

These two primarily wooded parcels of mixed timber total approximately +/- 69.03 acres, offering prime recreational hunting opportunities for deer and turkey enthusiasts. With a 30-foot deeded access easement off Scott Road, you'll have easy entry to your secluded retreat. Tract 1 even includes a 12-foot deeded utility right-of-way from the neighboring property, potentially allowing Piedmont Electric Cooperative to hook up power if you choose-perfect for a hunting cabin or base camp. Best of all, there are no deed restrictions on either tract, giving you full freedom to customize your setup.

An extensive 1.2-mile trail network weaves through both parcels, providing good access for scouting, stand placement, and quiet movement during hunts. Tract 1 spans about +/- 22.58 acres and features a 1.7-acre open clearing that's ideal for planting a high-yield food plot to attract big bucks and strutting toms. This spot is encircled by replanted loblolly pines, creating natural, secluded bedding areas where deer love to hide, as well as future return on your investment. Multiple access trails from the south, west, and east let you approach based on wind direction, maximizing your odds on those crisp mornings.

Just east of the field along the southern trail, a north-to-south creek cuts through the heart of the properties, emptying into Cane Creek. This natural funnel is a hotspot for deer, turkey, and even the occasional black bear, drawing wildlife year-round with its reliable water source. It also holds strong potential for a pond build-out, enhancing habitat and creating even more edge for ambushing game while increasing the property's value.

Tract 2 covers roughly 46.45 acres, expanding your hunting grounds with diverse terrain-ridges for turkey setups in spring and bottoms for deer rut action in fall. Picture yourself in a stand on a foggy autumn dawn, watching a trophy buck chase does through the hardwoods, or perched along a ridge at first light, calling in a gobbler echoing from the creek bed.

For downtime between hunts, you're just northwest of Hyco Lake, a haven for lake lovers with boating, fishing, and more. Nearby Mayo Lake offers additional perks like hiking trails and campgrounds. Dive into all the recreational gems Person County has to offer at <https://itsbetterinperson.com/things-to-do/>. This isn't just land-it's your gateway to unforgettable deer and turkey hunts!

Things to know:

- 30ft deeded access easement
- 12ft Piedmont Electric Cooperative right of way
- No deed restrictions
- No road maintenance agreement is in place
- Exceptional wildlife sign throughout
- Just minutes from Hyco Lake
- Verizon 5G service confirmed at time of site visit
- Danville, Va is 22 miles away, South Boston is 24 miles away, and Roxboro is 15 miles away

Areas of interest:

- Hyco Lake Campground- (5.1 miles away) <https://www.hycolake.org/>

- Mayo Lake- (23 miles away) <https://www.personcountync.gov/government/departments-i-z/recreation-arts-parks/mayo-park-and-lake>
- Virginia International Raceway- (7.7 miles away) <https://virnow.com/>
- Caesar's Virginia Casino- (26 miles away) <https://www.caesars.com/caesars-virginia>
- South Boston Speedway- (27 miles away) <https://www.southbostonspeedway.com/>

Person County school district:

- Woodland Elementary- PK-5 (6.5 miles away)
- Northern Middle School- 6-8 (17 miles away)
- Person High School- 9-12 (16 miles away)

I invite you to explore this embedded map, which shows a detailed view of the property and the surrounding area. <https://id.land/maps/e9a0f56c1399a58b23cc86464e159014/share/unbranded>

This property is shown by appointment only. Please contact me directly to coordinate your private tour.



**UNDER CONTRACT!! 69.03 acres of Recreational Land For Sale in Person County NC!
Semora, NC / Caswell County**

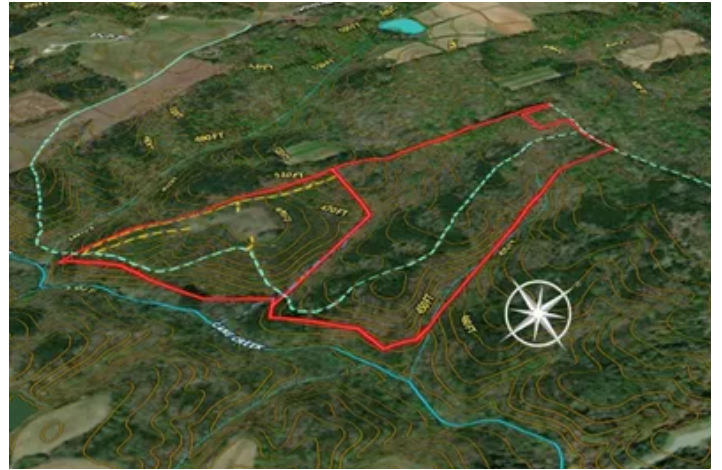

**UNDER CONTRACT!! 69.03 acres of Recreational Land For Sale in Person County NC!
Semora, NC / Caswell County**

Locator Map

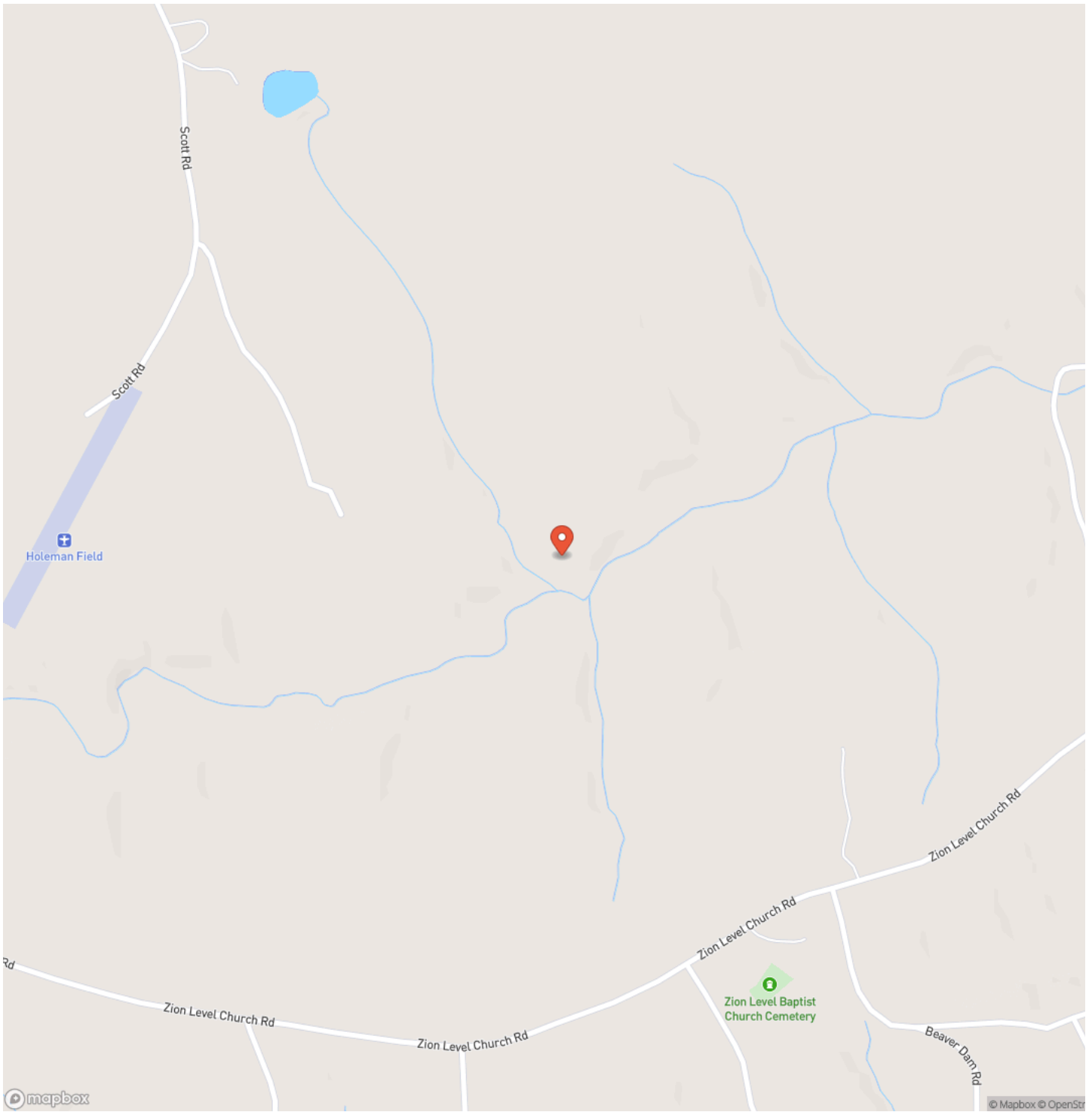

**UNDER CONTRACT!! 69.03 acres of Recreational Land For Sale in Person County NC!
Semora, NC / Caswell County**

Locator Map

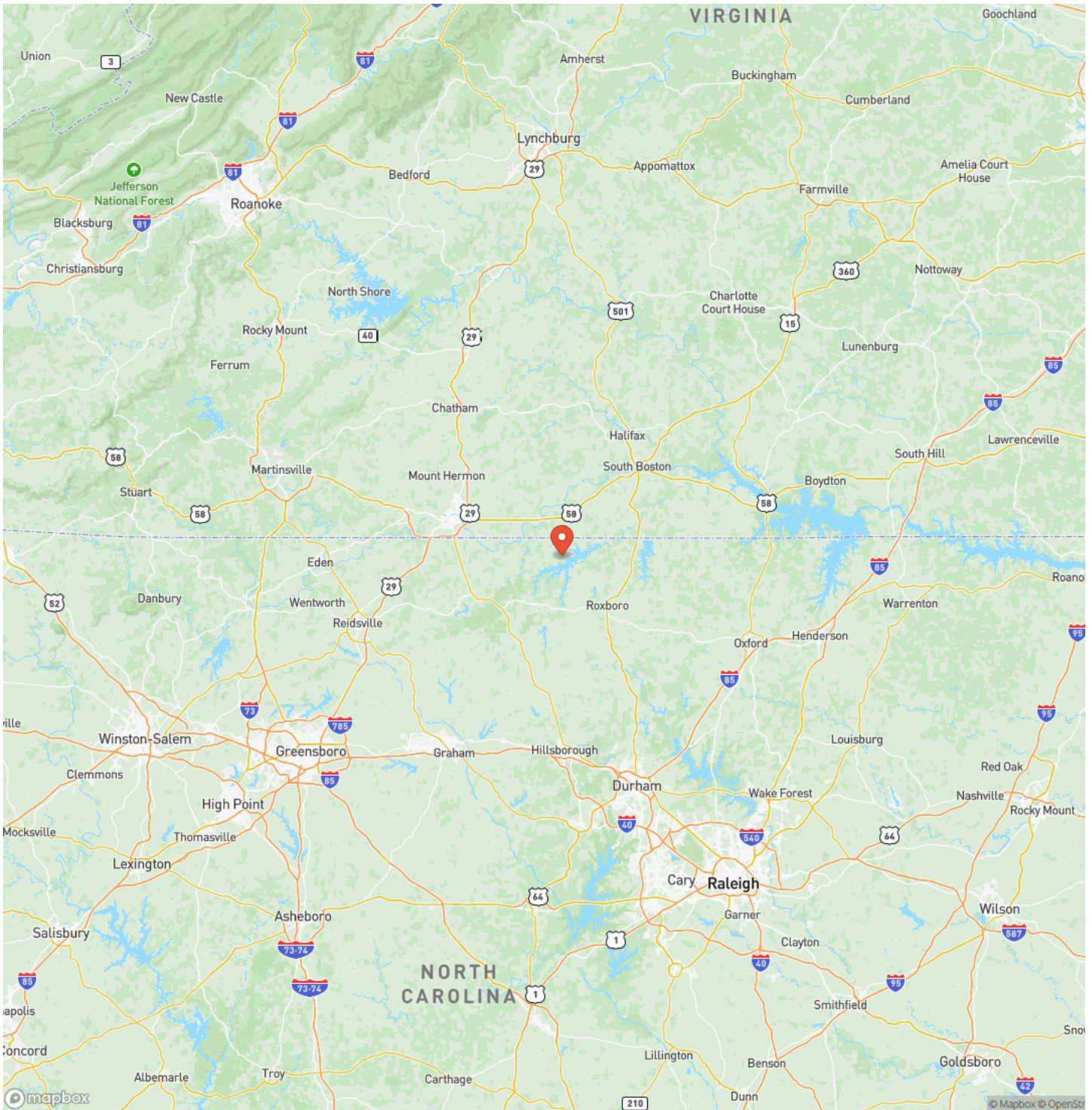

UNDER CONTRACT!! 69.03 acres of Recreational Land For Sale in Person County NC!
Semora, NC / Caswell County

Satellite Map



DISCLAIMERS

Information in this brochure is provided solely for information purposes and does not constitute an offer to sell or advertise real estate outside the states in which broker or agent licensed. The information presented has been obtained from sources deemed to be reliable, but is not guaranteed or warranted by the agent, broker, or the sellers of these properties. This offering is subject to errors, omissions, prior sale, price change, correction or withdrawal from the market without notice. All references to age, square footage, income, expenses, acreage, carrying capacity, and land classification, etc. are approximate. Prospective buyers are chargeable with and expected to conduct their own independent investigation of the information and the property and to rely only on those results. Sellers reserve the right to accept or reject any and all offers without liability to any buyer or cooperating broker.

Maps are provided for illustration purposes only, the accuracy is not warranted. Parcels on interactive maps are not adjusted to match aerial backgrounds. This information is for reference purposes only and is not a legal document. Data maps contain errors. The seller and seller's agent are making known to all potential buyers that there may be variations between the location of the existing fence lines and the legal description of the deeded property. Seller and seller's agent make no warranties with regard to the location of the fence lines in relationship to the deeded property lines, nor does the Seller make any warranties or representations with regard to the specific acreage contained within the fenced property lines. Seller is selling the property in an "as is" condition, which includes the location of the fences as they exist. Boundaries shown on the accompanying maps are approximate, based on county parcel data. The maps are not to scale. The accuracy of the maps is not guaranteed. Prospective buyers are encouraged to verify fence lines, deeded property lines and acreages using a licensed surveyor at their own expense.

Mossy Oak Properties Land and Farms Realty
101 Budleigh Street, Suite F
Manteo, NC 27954
(844) 480-5263
www.landandfarmsrealty.com

