

**Oklahoma Inn Rd E - Photo Map**  
**Parcel #05125Hb1004**  
 Saline County, AR - approx. 188.9 acres +/-

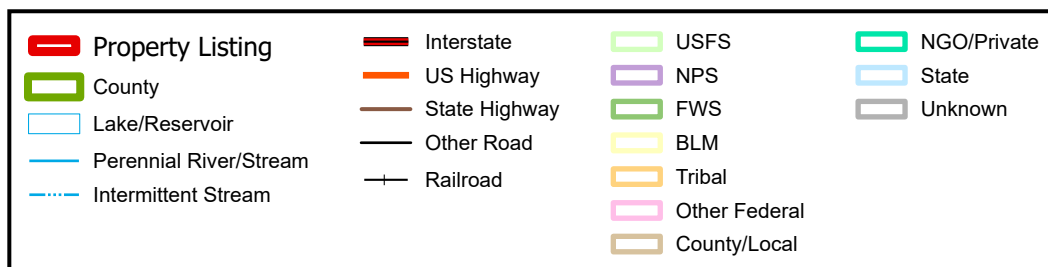

SCALE: 1:18,000

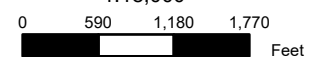

The property depicted on this map has not been surveyed. The acreage is an estimate based upon GIS data. The volume information in this report is based on current information in the seller's inventory system. The information is subject to change due to harvest activities and/or updates resulting from routine maintenance of the inventory system. Neither the owner nor its officers, directors, employees or agents represent or warrant the accuracy or completeness of the ownership acreage, the cover type acreage, timber inventory species, grade or volumes, legal or practical access to the property, or operability.

9/11/2025

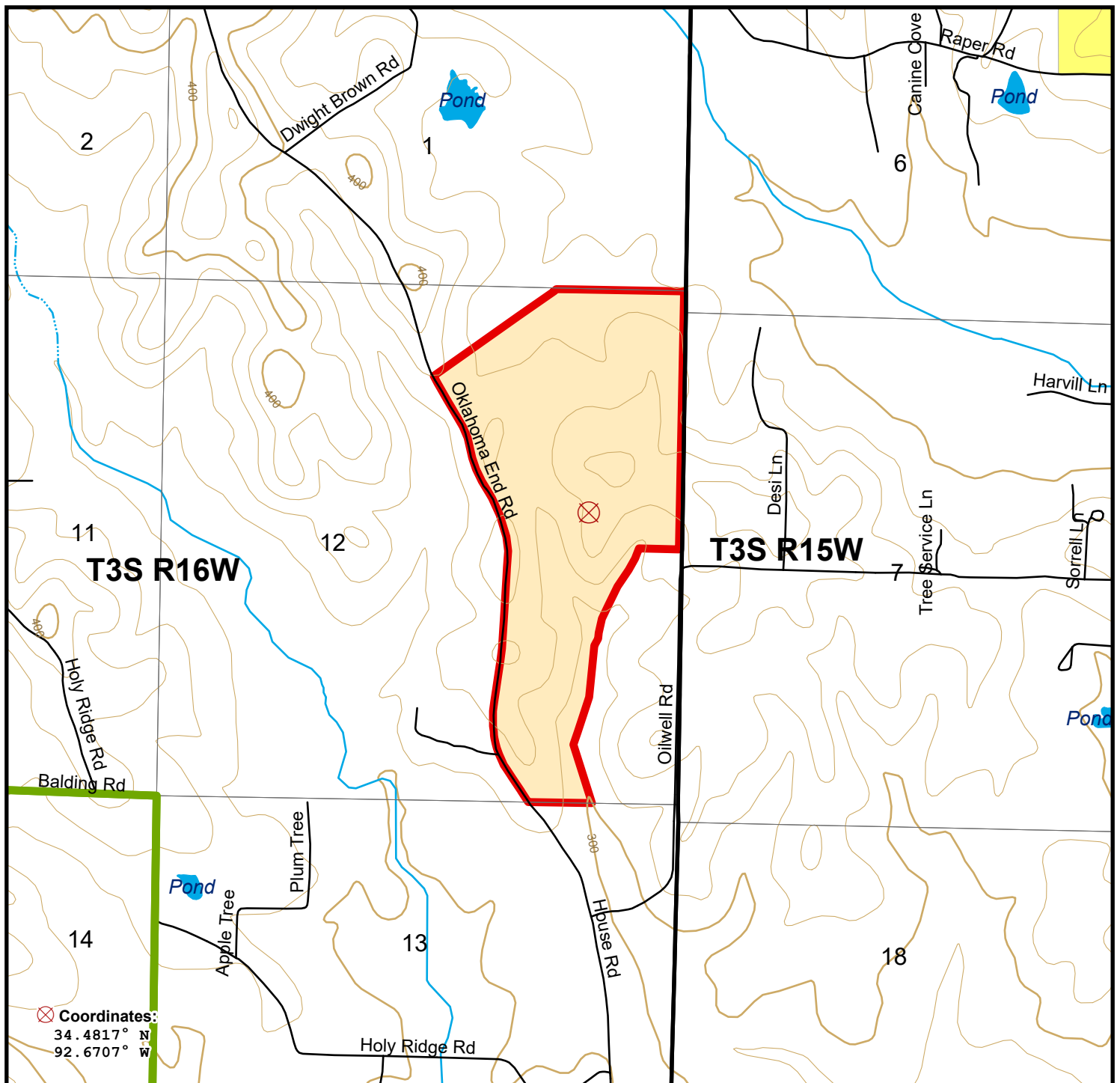

**Oklahoma Inn Rd E - Parcel Map**  
**Parcel #05125Hb1004**  
 Saline County, AR - approx. 188.9 acres +/-

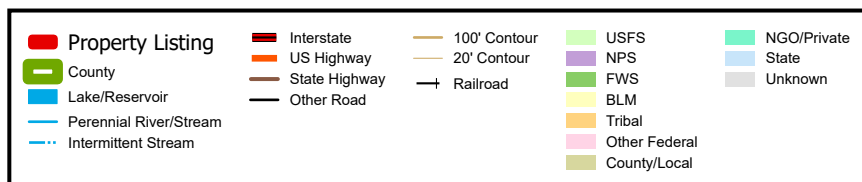

SCALE: 1:18,000

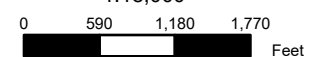

The property depicted on this map has not been surveyed. The acreage is an estimate based upon GIS data. The volume information in this report is based on current information in the seller's inventory system. The information is subject to change due to harvest activities and/or updates resulting from routine maintenance of the inventory system. Neither the owner nor its officers, directors, employees or agents represent or warrant the accuracy or completeness of the ownership acreage, the cover type acreage, timber inventory species, grade or volumes, legal or practical access to the property, or operability.

9/11/2025

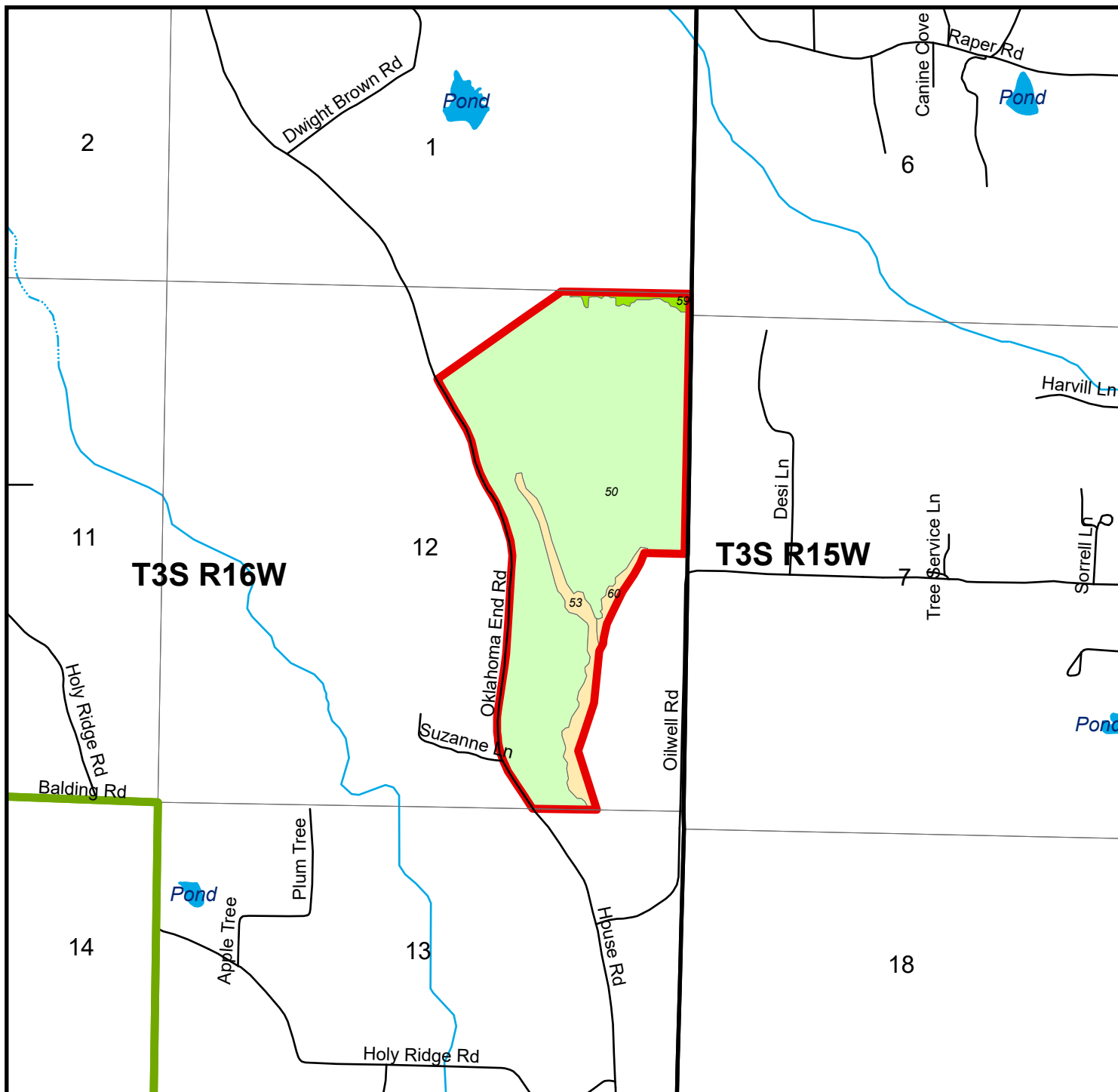

**Oklahoma Inn Rd E - Stand Map**  
**Oklahoma Inn Rd E**  
**Parcel # 05125Hb1004**  
 Saline County, AR - approx. 188.9 acres +/-

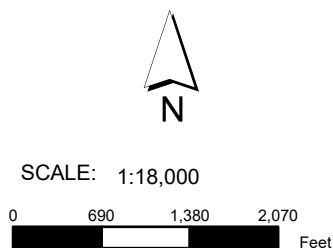
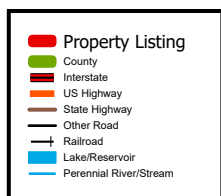

Stand #	Cover Type	Age	Acres
50	Pine Plantation < 12 yr	5	172.6
53	Hardwood	80	10.9
59	Pine Plantation >= 12 yr	37	2.6
60	Hardwood	80	2.8

Smaller stands have been excluded to fit in the allowable space

The property depicted on this map has not been surveyed. The acreage is an estimate based upon GIS data. The volume information in this report is based on current information in the seller's inventory system. The information is subject to change due to harvest activities and/or updates resulting from routine maintenance of the inventory system. Neither the owner nor its officers, directors, employees or agents represent or warrant the accuracy or completeness of the ownership acreage, the cover type acreage, timber inventory species, grade or volumes, legal or practical access to the property, or operability.

9/11/2025

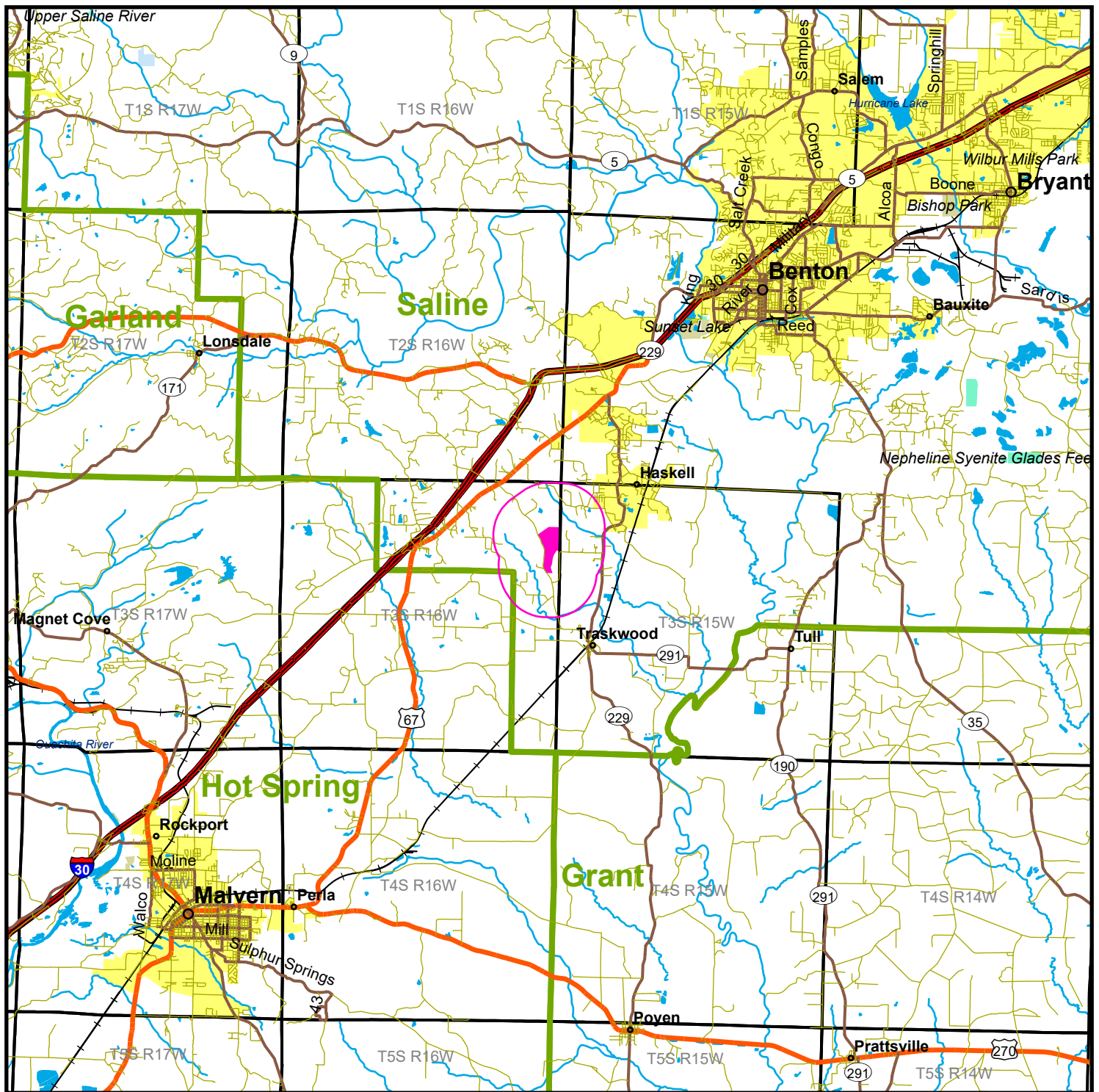

**Oklahoma Inn Rd E - Location Map**  
**Parcel # 05125Hb1004**  
 Saline County, AR - approx. 188.9 acres +/-

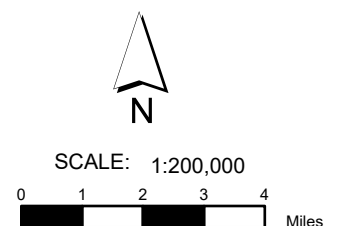
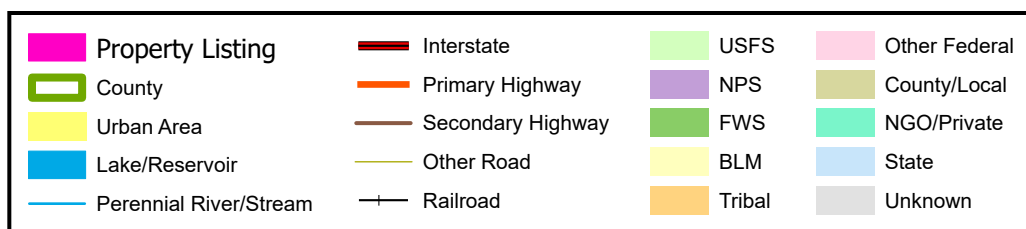

The property depicted on this map has not been surveyed. The acreage is an estimate based upon GIS data. The volume information in this report is based on current information in the seller's inventory system. The information is subject to change due to harvest activities and/or updates resulting from routine maintenance of the inventory system. Neither the owner nor its officers, directors, employees or agents represent or warrant the accuracy or completeness of the ownership acreage, the cover type acreage, timber inventory species, grade or volumes, legal or practical access to the property, or operability.

9/11/2025