

Soils Map

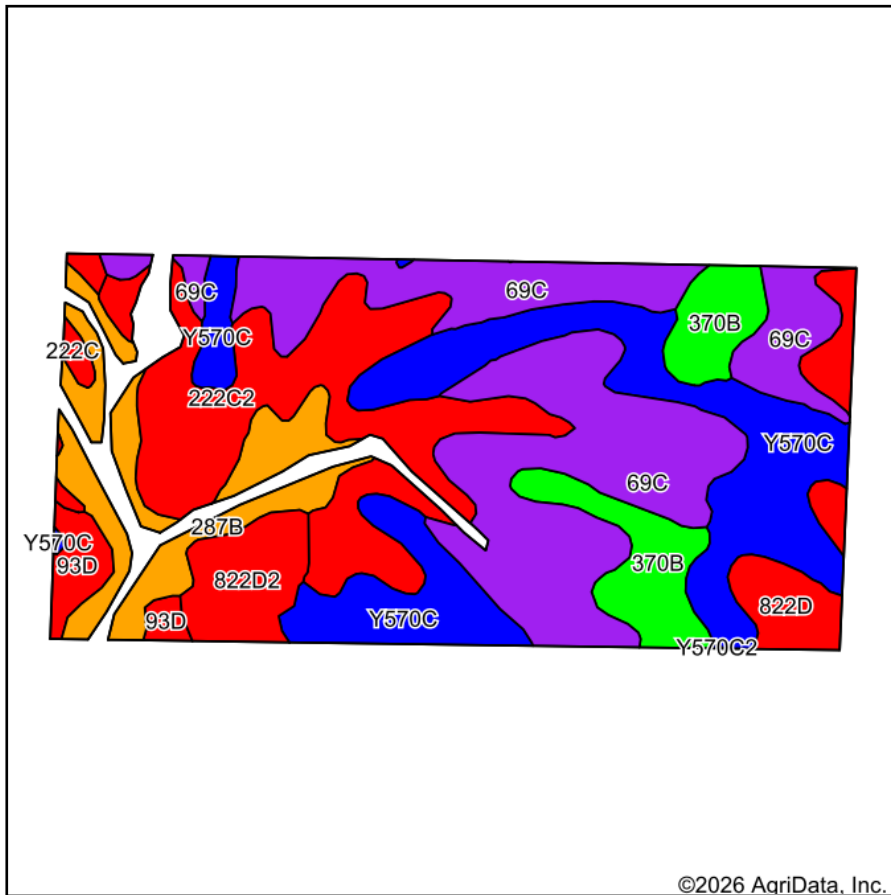

©2026 AgriData, Inc.

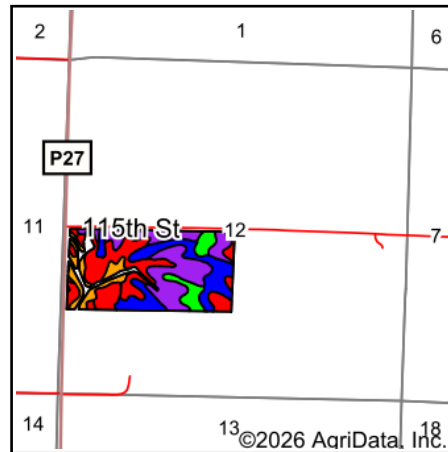

State: **Iowa**
 County: **Ringgold**
 Location: **12-70N-31W**
 Township: **Lincoln**
 Acres: **70.9**
 Date: **5/1/2026**



Maps Provided By:



© AgriData, Inc. 2025

www.AgriDataInc.com



Soils data provided by USDA and NRCS.

Area Symbol: IA159, Soil Area Version: 31

Code	Soil Description	Acres	Percent of field	CSR2 Legend	Restrictive Layer	Soil Drainage	Non-Irr Class *c	CSR2**	
69C	Clearfield silty clay loam, dissected till plain, 5 to 9 percent slopes	21.09	29.7%		> 6.5ft.	Poorly drained	IIIw	59	
Y570C	Nira silty clay loam, dissected till plain, 5 to 9 percent slopes	15.35	21.7%		> 6.5ft.	Moderately well drained	IIIe	84	
222C2	Clarinda silty clay loam, 5 to 9 percent slopes, moderately eroded	13.12	18.5%		> 6.5ft.	Poorly drained	IVw	28	
287B	Zook-Ely silty clay loams, 0 to 5 percent slopes	6.77	9.5%		> 6.5ft.	Poorly drained	IIw	75	
370B	Sharpsburg silty clay loam, 2 to 5 percent slopes	5.58	7.9%		> 6.5ft.	Moderately well drained	IIe	91	
822D2	Lamoni silty clay loam, 9 to 14 percent slopes, moderately eroded	3.19	4.5%		> 6.5ft.	Somewhat poorly drained	IVe	10	
822D	Lamoni silty clay loam, 9 to 14 percent slopes	2.39	3.4%		> 6.5ft.	Somewhat poorly drained	IVe	14	
222C	Clarinda silty clay loam, 5 to 9 percent slopes	1.73	2.4%		0.9ft. (Abrupt textural change)	Poorly drained	IVw	31	
93D	Shelby-Adair clay loams, 9 to 14 percent slopes	1.68	2.4%		1.1ft. (Abrupt textural change)	Well drained	IIIe	36	
Weighted Average								3.11	57.8

**IA has updated the CSR values for each county to CSR2.

*c: Using Capabilities Class Dominant Condition Aggregation Method

Soils data provided by USDA and NRCS.