

Soils Map

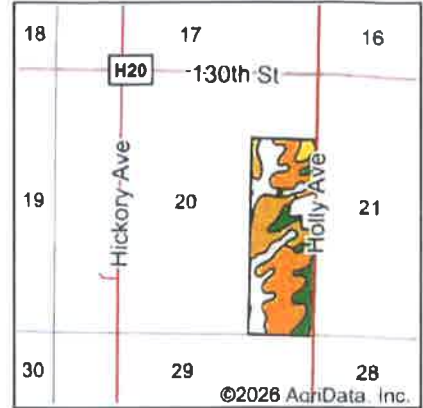

State: **Iowa**
 County: **Adams**
 Location: **20-73N-34W**
 Township: **Washington**
 Acres: **111.83**
 Date: **4/7/2026**

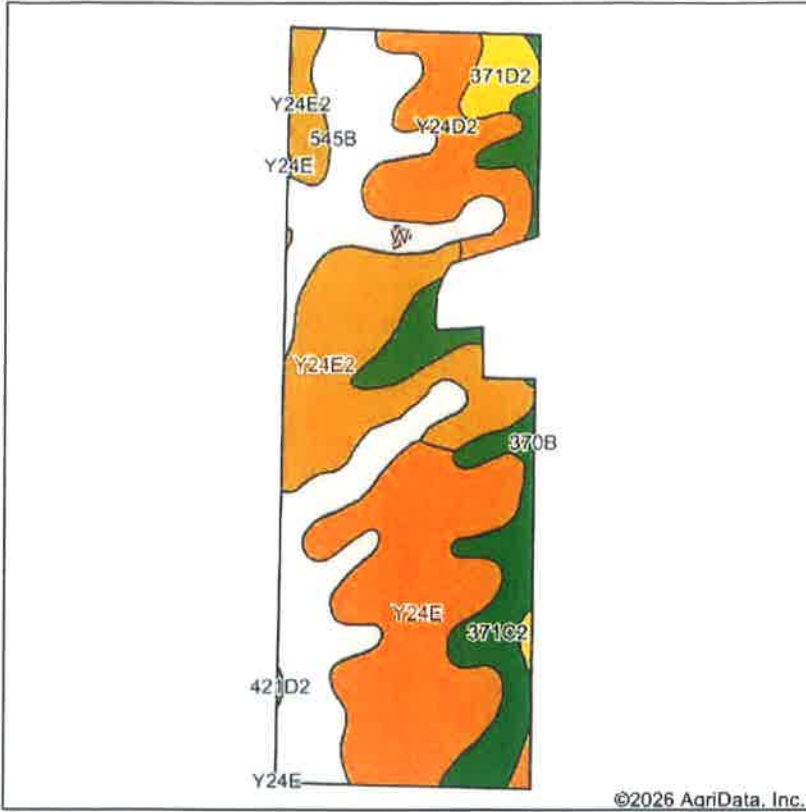

Soils data provided by USDA and NRCS.

Area Symbol: IA003, Soil Area Version: 37

Code	Soil Description	Acres	Percent of field	CSR2 Legend	Non-Irr Class *c	CSR2**	CSR	*n NCCPI Overall	
545B	Zook-Ely-Gullied land complex, 2 to 5 percent slopes	29.92	26.7%		Ile	64	52	9	
Y24E	Shelby loam, dissected till plain, 14 to 18 percent slopes	29.02	26.0%		IVe	41		75	
Y24E2	Shelby clay loam, dissected till plain, 14 to 18 percent slopes, eroded	21.71	19.4%		IVe	35		69	
371C2	Sharpsburg-Nira silty clay loams, 5 to 9 percent slopes, eroded	15.54	13.9%		IIIe	83	64	79	
Y24D2	Shelby clay loam, dissected till plain, 9 to 14 percent slopes, eroded	12.08	10.8%		IIIe	49		75	
371D2	Sharpsburg-Nira silty clay loams, 9 to 14 percent slopes, eroded	3.30	3.0%		IIIe	57	54	76	
W	Water	0.15	0.1%			0	0		
421D2	Gara-Bucknell complex, 9 to 14 percent slopes, moderately eroded	0.11	0.1%		IVe	28	28	66	
Weighted Average						*,	53.1	*,	*n 56.7

**IA has updated the CSR values for each county to CSR2.

*- CSR weighted average cannot be calculated on the current soils data, use prior data version for csr values.

*n: The aggregation method is "Weighted Average using all components"

*c: Using Capabilities Class Dominant Condition Aggregation Method

*- Non Irr Class weighted average cannot be calculated on the current soils data due to missing data.

Soils data provided by USDA and NRCS

Aerial Map



©2026 AgriData, Inc.

Boundary Center: 41° 6' 25.72, -94° 46' 43.77



20-73N-34W
Adams County
Iowa



© AgriData, Inc. 2025 www.AgriDataInc.com

4/7/2026

Soils Map

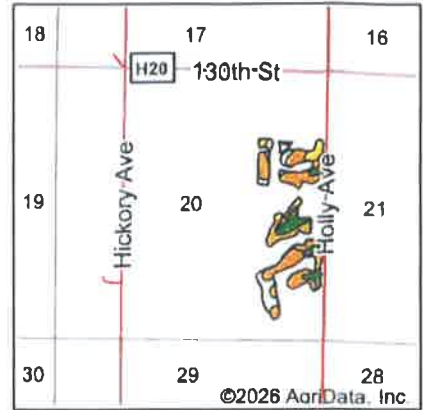
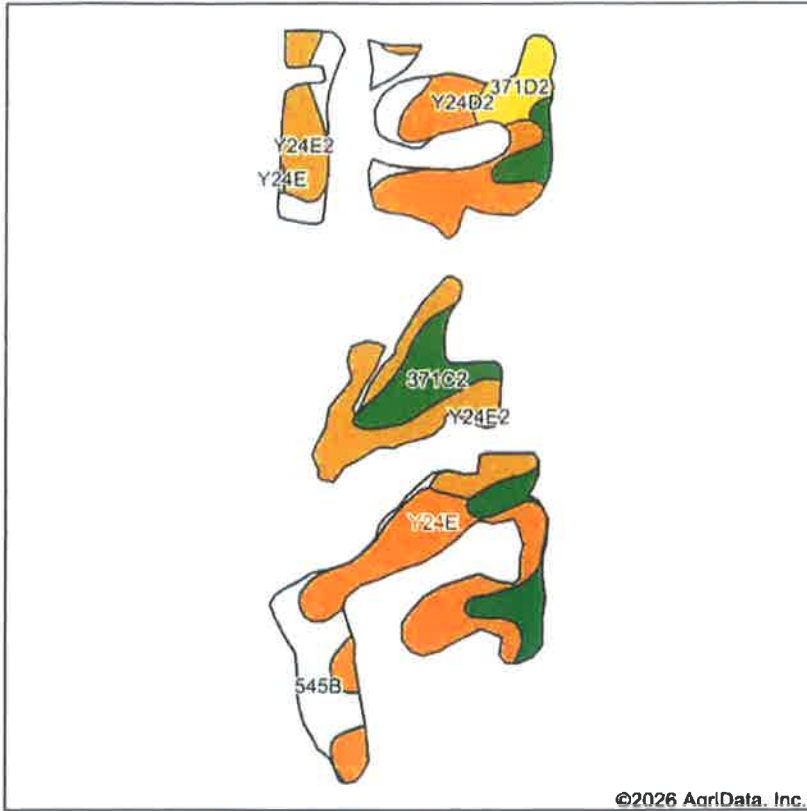

State: **Iowa**
 County: **Adams**
 Location: **20-73N-34W**
 Township: **Washington**
 Acres: **40.92**
 Date: **4/7/2026**



Soils data provided by USDA and NRCS.

Area Symbol: IA003, Soil Area Version: 37

Code	Soil Description	Acres	Percent of field	CSR2 Legend	Non-Irr Class *c	CSR2**	CSR	*n NCCPI Overall	
Y24E	Shelby loam, dissected till plain, 14 to 18 percent slopes	9.30	22.7%		IVe	41		75	
Y24E2	Shelby clay loam, dissected till plain, 14 to 18 percent slopes, eroded	9.28	22.7%		IVe	35		69	
545B	Zook-Ely-Gullied land complex, 2 to 5 percent slopes	7.26	17.7%		IIe	64	52	9	
371C2	Sharpsburg-Nira silty clay loams, 5 to 9 percent slopes, eroded	6.99	17.1%		IIIe	83	64	79	
Y24D2	Shelby clay loam, dissected till plain, 9 to 14 percent slopes, eroded	6.08	14.9%		IIIe	49		75	
371D2	Sharpsburg-Nira silty clay loams, 9 to 14 percent slopes, eroded	2.01	4.9%		IIIe	57	54	76	
Weighted Average						3.28	52.9	*-	*n 62.7

**IA has updated the CSR values for each county to CSR2.

*- CSR weighted average cannot be calculated on the current soils data, use prior data version for csr values.

*n: The aggregation method is "Weighted Average using all components"

*c: Using Capabilities Class Dominant Condition Aggregation Method