

# Soils Map

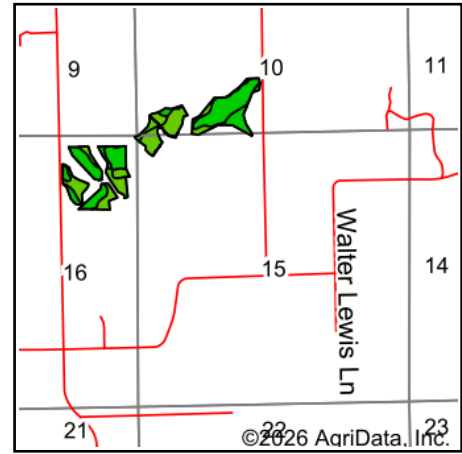

State: **Illinois**  
 County: **Morgan**  
 Location: **15-14N-11W**  
 Township: **Lynnville**  
 Acres: **46.76**  
 Date: **6/3/2026**

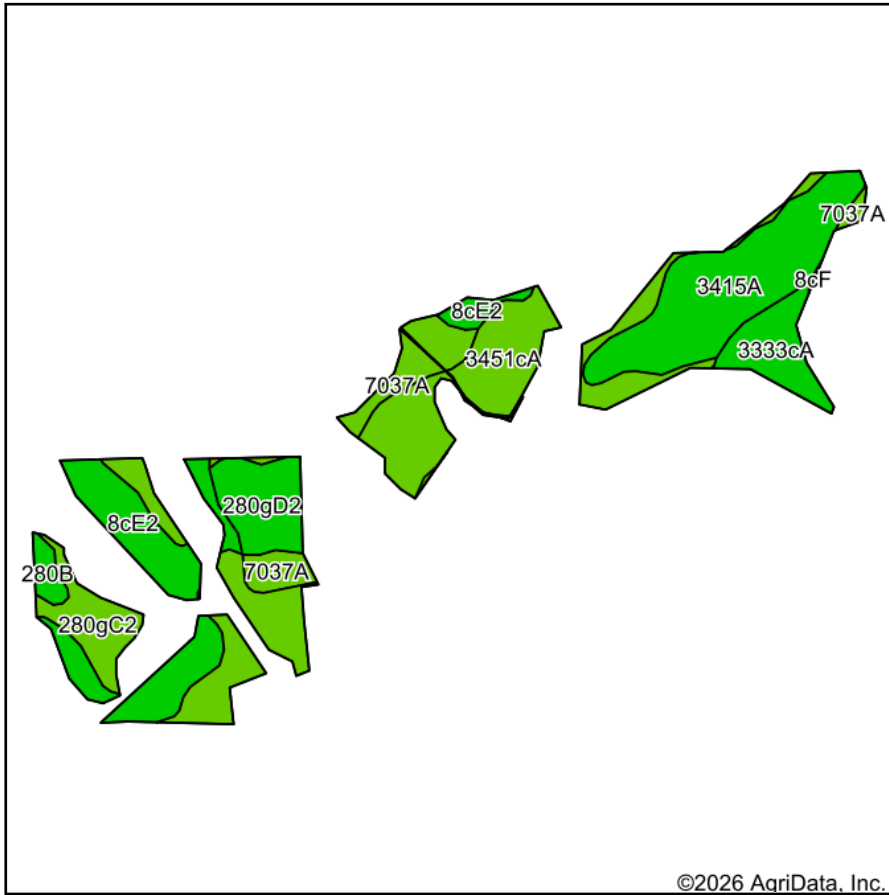

Maps Provided By:



Soils data provided by USDA and NRCS.

Area Symbol: IL137, Soil Area Version: 16

Code	Soil Description	Acres	Percent of field	Il. State Productivity Index Legend	Restrictive Layer	Soil Drainage	*Subsoil rooting <i>a</i>	*Corn Bu/A	*Soybeans Bu/A	*Wheat Bu/A	*Oats Bu/A <i>b</i>	*Grass-legume hay, T/A	*Crop productivity index for optimum management
**3451cA	Lawson silt loam, cool mesic, 0 to 2 percent slopes, frequently flooded	13.53	28.9%		> 6.5ft.	Somewhat poorly drained	FAV	**190	**61	**73	**97	**5.56	**140
**3415A	Orion silt loam, 0 to 2 percent slopes, frequently flooded	10.07	21.5%		> 6.5ft.	Somewhat poorly drained	FAV	**180	**57	**66	**89	**5.56	**131
**8cE2	Hickory silt loam, cool mesic, 18 to 25 percent slopes, eroded	8.35	17.9%		> 6.5ft.	Well drained	FAV	**94	**32	**38	**43	**3.00	**71
**280gC2	Fayette silt loam, glaciated, 5 to 10 percent slopes, eroded	3.80	8.1%		> 6.5ft.	Well drained	FAV	**155	**49	**61	**79	**5.00	**113

Soils data provided by USDA and NRCS. Soils data provided by University of Illinois at Champaign-Urbana.



Code	Soil Description	Acres	Percent of field	Il. State Productivity Index Legend	Restrictive Layer	Soil Drainage	*Subsoil rooting <b>a</b>	*Corn Bu/A	*Soybeans Bu/A	*Wheat Bu/A	*Oats Bu/A <b>b</b>	*Grass-legume <b>e</b> hay, T/A	*Crop productivity index for optimum management
7037A	Worthen silt loam, 0 to 2 percent slopes, rarely flooded	3.79	8.1%		> 6.5ft.	Well drained	FAV	194	60	74	102	7.00	142
**280gD2	Fayette silt loam, glaciated, 10 to 18 percent slopes, eroded	3.49	7.5%		> 6.5ft.	Well drained	FAV	**145	**46	**57	**74	**5.00	**106
**3333cA	Wakeland silt loam, cool mesic, 0 to 2 percent slopes, frequently flooded	2.98	6.4%		> 6.5ft.	Somewhat poorly drained	FAV	**174	**56	**68	**86	**5.56	**128
**280B	Fayette silt loam, glaciated, 2 to 5 percent slopes	0.75	1.6%		> 6.5ft.	Well drained	FAV	**164	**52	**65	**83	**5.00	**120
<b>Weighted Average</b>								<b>163.4</b>	<b>52.3</b>	<b>62.7</b>	<b>81.9</b>	<b>5.1</b>	<b>120.1</b>

**Table: Optimum Crop Productivity Ratings for Illinois Soil EFOTG are sourced from Bulletin 811 calculated Map Unit Base Yield Indices, and adjusted (Adj) for slope, erosion, and surface texture.** Publication Date: 02-08-2023

Crop yields and productivity (B811 EFOTG) are maintained at the following USDA web site: 2023 Illinois Soil Productivity and Yield Indices: <https://efotg.sc.egov.usda.gov/#/state/IL/documents/section=2&folder=52809>

\* The flood/pond factor has been removed for B811 indexes and yields.

\*\* Base indexes from Bulletin 811 adjusted for slope, erosion, and surface texture according to the Il. Soils EFOTG

**b** Soils in the southern region were not rated for oats and are shown with a zero "0".

**e** Soils in the well drained group were not rated for grass-legume and are shown with a zero "0".