

Soils Map

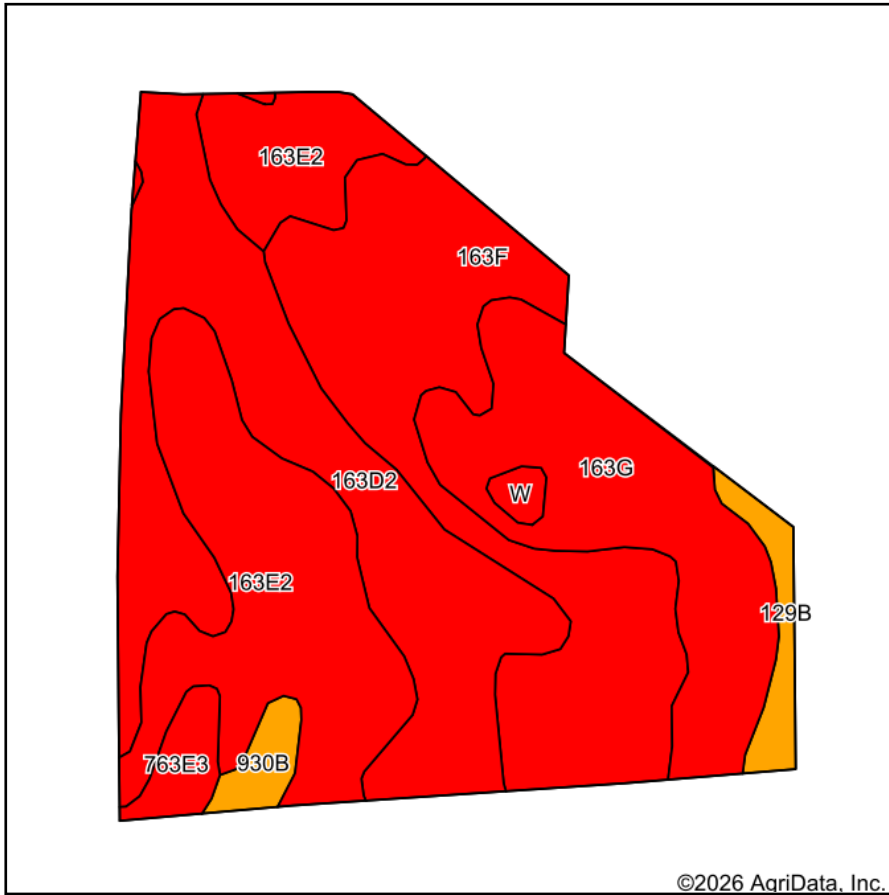

Soils data provided by USDA and NRCS.

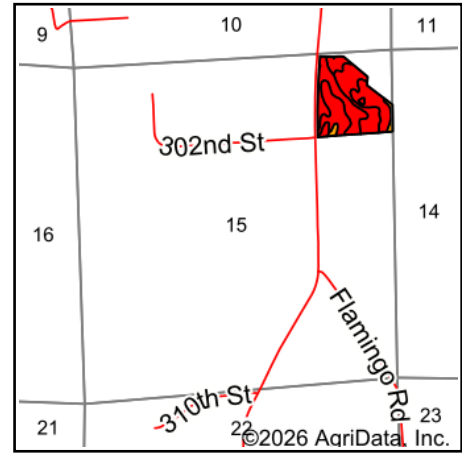

State: **Iowa**
 County: **Clayton**
 Location: **15-92N-5W**
 Township: **Cox Creek**
 Acres: **26.05**
 Date: **6/29/2026**



Maps Provided By:



Area Symbol: IA043, Soil Area Version: 29

Code	Soil Description	Acres	Percent of field	CSR2 Legend	Restrictive Layer	Soil Drainage	Non-Irr Class *c	CSR2**	*n NCCPI Overall	*n NCCPI Corn	*n NCCPI Small Grains	*n NCCPI Soybeans
163D2	Fayette silt loam, 9 to 14 percent slopes, moderately eroded	6.77	26.0%		> 6.5ft.	Well drained	IIIe	46	78	78	66	62
163F	Fayette silt loam, 18 to 25 percent slopes	6.51	25.0%		> 6.5ft.	Well drained	VIe	21	62	62	43	48
163E2	Fayette silt loam, 14 to 18 percent slopes, moderately eroded	6.43	24.7%		> 6.5ft.	Well drained	IVe	35	74	74	62	58
163G	Fayette silt loam, 25 to 40 percent slopes	4.57	17.5%		> 6.5ft.	Well drained	VIIe	5	20	20	17	10
129B	Arenzville-Chaseburg complex, 1 to 5 percent slopes	0.61	2.3%		> 6.5ft.	Moderately well drained	IIw	73	85	85	72	83
763E3	Exette silt loam, 14 to 18 percent slopes, severely eroded	0.55	2.1%		> 6.5ft.	Well drained	VIe	40	63	63	58	55
930B	Orion silt loam, 2 to 5 percent slopes, occasionally flooded	0.43	1.7%		> 6.5ft.	Somewhat poorly drained	IIw	76	88	79	55	88
W	Water	0.18	0.7%		> 6.5ft.			0				

Soils data provided by USDA and NRCS.



Code	Soil Description	Acres	Percent of field	CSR2 Legend	Restrictive Layer	Soil Drainage	Non-Irr Class *c	CSR2**	*n NCCPI Overall	*n NCCPI Corn	*n NCCPI Small Grains	*n NCCPI Soybeans
Weighted Average							*-	30.5	*n 62.3	*n 62.2	*n 50	*n 48.7

**IA has updated the CSR values for each county to CSR2.

*n: The aggregation method is "Weighted Average using all components"

*c: Using Capabilities Class Dominant Condition Aggregation Method

*- Non Irr Class weighted average cannot be calculated on the current soils data due to missing data.