

Soils Map

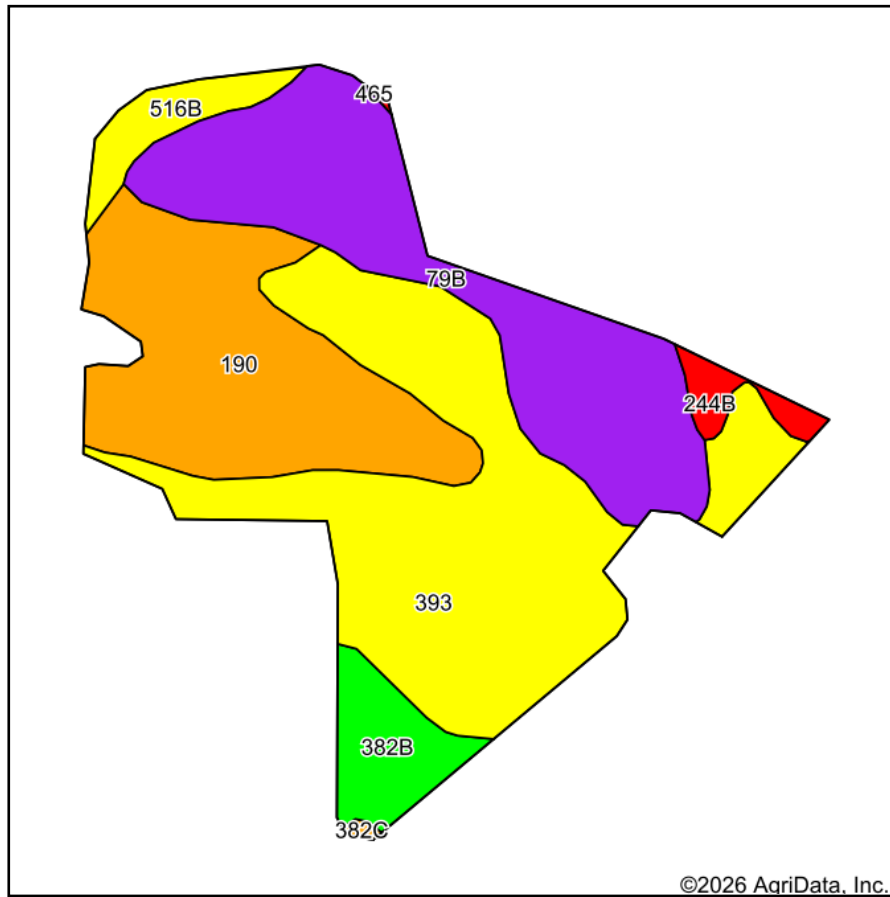

Soils data provided by USDA and NRCS.

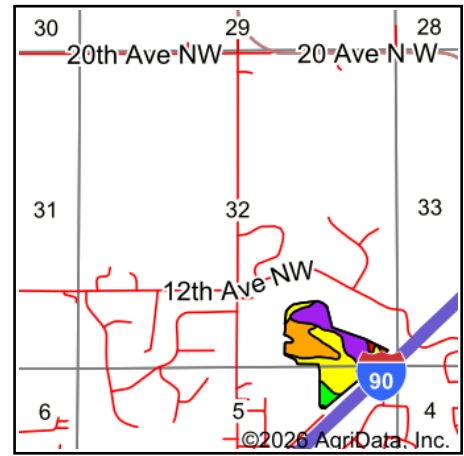

State: **Minnesota**
 County: **Mower**
 Location: **32-103N-18W**
 Township: **Lansing**
 Acres: **33.8**
 Date: **2/4/2026**

Maps Provided By:

 CUSTOMIZED ONLINE MAPPING
 © AgriData, Inc. 2025 www.AgriDataInc.com



Area Symbol: MN099, Soil Area Version: 21

Code	Soil Description	Acres	Percent of field	PI Legend	Restrictive Layer	Soil Drainage	Non-Irr Class *c	Productivity Index	*n NCCPI Overall
393	Udolpho silt loam	12.90	38.2%		> 6.5ft.	Poorly drained	IIw	70	76
79B	Billett fine sandy loam, 2 to 6 percent slopes	8.89	26.3%		> 6.5ft.	Well drained	III s	60	71
190	Hayfield loam	8.26	24.4%		> 6.5ft.	Somewhat poorly drained	II s	72	80
382B	Blooming silt loam, 2 to 6 percent slopes	1.85	5.5%		> 6.5ft.	Well drained	Ile	91	84
516B	Dowagiac loam, 2 to 6 percent slopes	1.22	3.6%		> 6.5ft.	Well drained	Ile	64	68
244B	Lilah sandy loam, 2 to 6 percent slopes	0.62	1.8%		> 6.5ft.	Excessively drained	IV s	43	53
382C	Blooming silt loam, 6 to 15 percent slopes	0.06	0.2%		> 6.5ft.	Well drained	IIIle	75	83
Weighted Average							2.30	68.3	*n 75.4

*n: The aggregation method is "Weighted Average using all components"

*c: Using Capabilities Class Dominant Condition Aggregation Method

Soils data provided by USDA and NRCS.