

Soils Map

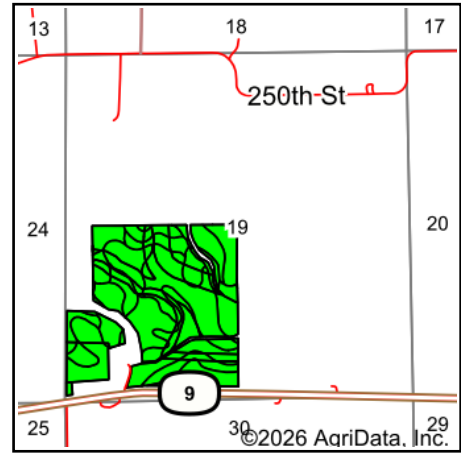

State: **Iowa**
 County: **Winneshiek**
 Location: **19-98N-9W**
 Township: **Madison**
 Acres: **123.46**
 Date: **2/25/2026**

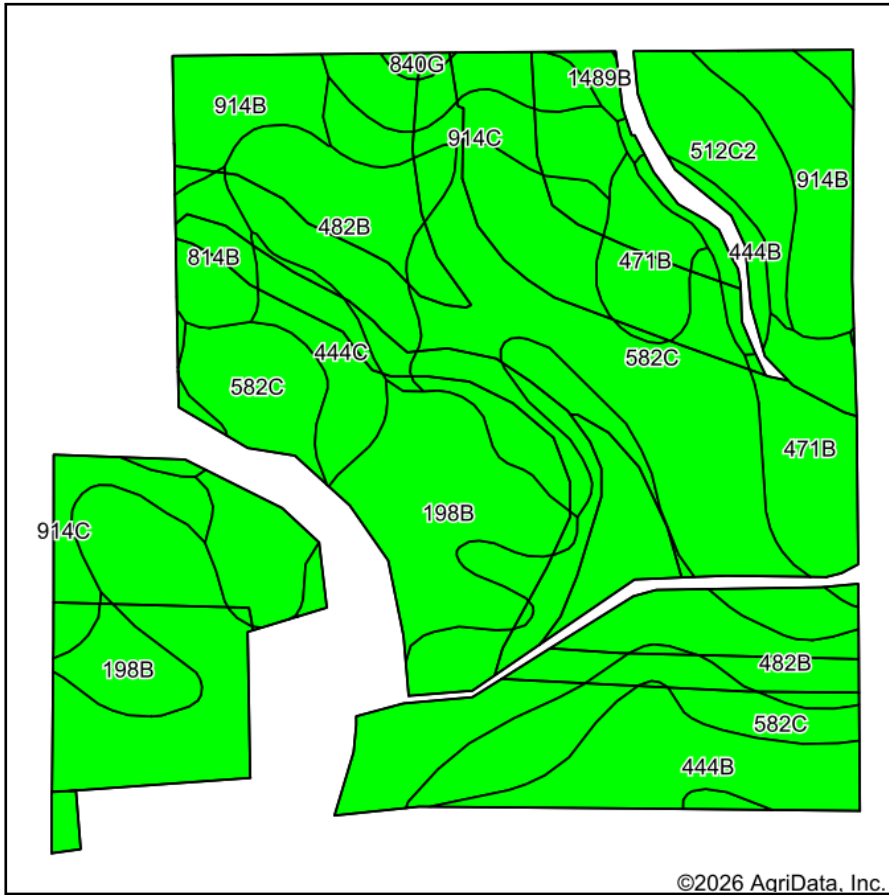

Maps Provided By:



Soils data provided by USDA and NRCS.

©2026 AgriData, Inc.

© AgriData, Inc. 2025

www.AgriDataInc.com

Area Symbol: IA191, Soil Area Version: 34

Code	Soil Description	Acres	Percent of field	CSR2 Legend	Non-Irr Class *c	CSR2**	CSR	*n NCCPI Overall	*n NCCPI Corn	*n NCCPI Small Grains	*n NCCPI Soybeans
482B	Racine loam, 2 to 5 percent slopes	33.00	26.8%		Ile	76	78	66	66	55	55
582C	Kasson loam, 5 to 9 percent slopes	32.26	26.1%		IIle	69	64	78	78	61	63
198B	Floyd loam, 1 to 4 percent slopes	14.63	11.8%		IIw	89	78	88	83	66	88
914B	Winneshiek loam, 2 to 5 percent slopes	8.68	7.0%		Ile	38	53	58	58	57	43
471B	Oran loam, 2 to 5 percent slopes	8.61	7.0%		Iw	74	78	80	80	63	62
444B	Jacwin loam, 2 to 5 percent slopes	8.00	6.5%		Ile	62	58	67	59	66	51
914C	Winneshiek loam, 5 to 9 percent slopes	6.54	5.3%		IIle	38	33	59	59	58	46
512C2	Marlean loam, 5 to 9 percent slopes, moderately eroded	4.87	3.9%		IVe	52	20	61	60	60	55
444C	Jacwin loam, 5 to 9 percent slopes	3.44	2.8%		IIle	56	38	65	57	65	50
814B	Rockton loam, 2 to 5 percent slopes	2.57	2.1%		Ile	52	57	67	65	66	52
1489B	Lawson-Ossian complex, 0 to 4 percent slopes	0.54	0.4%		IIw	77	82	75	63	46	75
840G	Lacrescent cobbly silty clay loam, 18 to 45 percent slopes	0.32	0.3%		VIIe	5	5	14	14	13	7

Soils data provided by USDA and NRCS.



Code	Soil Description	Acres	Percent of field	CSR2 Legend	Non-Irr Class *c	CSR2**	CSR	*n NCCPI Overall	*n NCCPI Corn	*n NCCPI Small Grains	*n NCCPI Soybeans
Weighted Average					2.36	67.8	64.9	*n 71.6	*n 70.1	*n 60	*n 59.7

**IA has updated the CSR values for each county to CSR2.

*n: The aggregation method is "Weighted Average using all components"

*c: Using Capabilities Class Dominant Condition Aggregation Method