

Soils Map

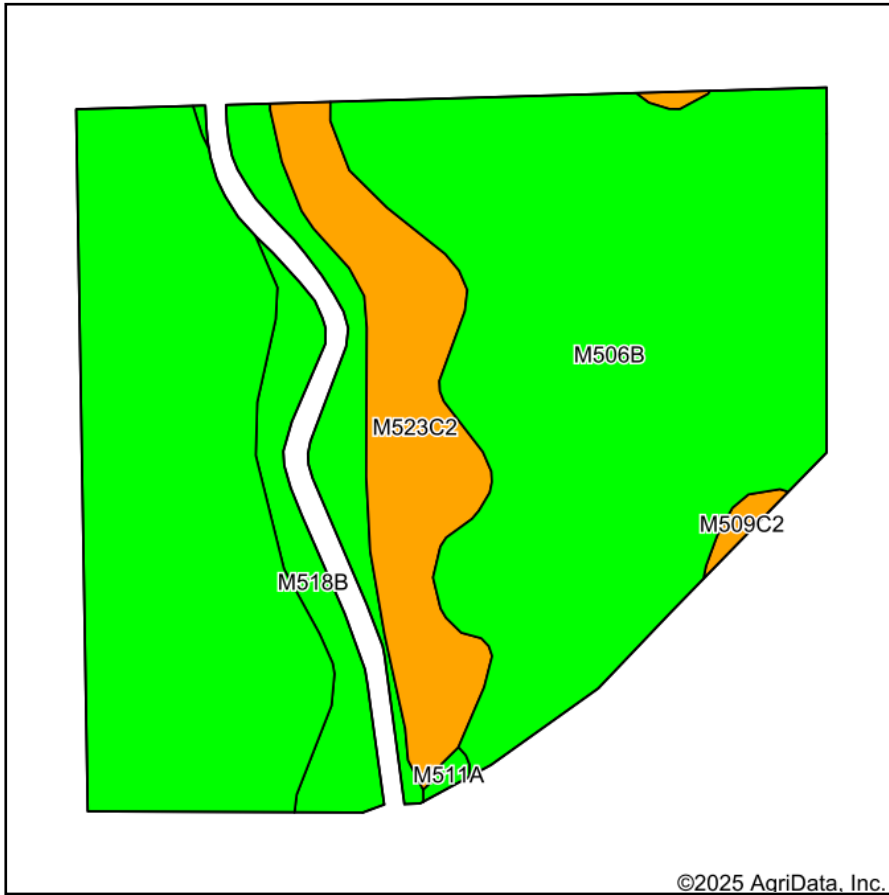

Soils data provided by USDA and NRCS.

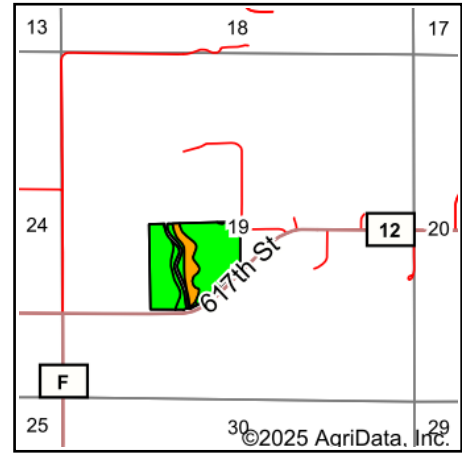

State: **Minnesota**
 County: **Dodge**
 Location: **19-107N-16W**
 Township: **Mantorville**
 Acres: **35.18**
 Date: **11/8/2025**

Maps Provided By:

 CUSTOMIZED ONLINE MAPPING
 © AgriData, Inc. 2023 www.AgriDataInc.com



Area Symbol: MN039, Soil Area Version: 22

Code	Soil Description	Acres	Percent of field	PI Legend	Restrictive Layer	Soil Drainage	Non-Irr Class *c	Productivity Index	*n NCCPI Overall
M506B	Kasson silt loam, 2 to 6 percent slopes	26.97	76.6%		> 6.5ft.	Moderately well drained	Ile	95	79
M523C2	Bassett-Kasson complex, 6 to 12 percent slopes, eroded	4.49	12.8%		> 6.5ft.	Moderately well drained	IIle	77	73
M518B	Clyde-Floyd complex, 1 to 4 percent slopes	3.45	9.8%		> 6.5ft.	Poorly drained	IIw	92	87
M509C2	Mantorville loam, 6 to 12 percent slopes, moderately eroded	0.18	0.5%		> 6.5ft.	Well drained	IIle	71	60
M511A	Readlyn silt loam, 1 to 3 percent slopes	0.09	0.3%		> 6.5ft.	Somewhat poorly drained	Iw	100	80
Weighted Average							2.13	92.3	*n 78.9

*n: The aggregation method is "Weighted Average using all components"

*c: Using Capabilities Class Dominant Condition Aggregation Method

Soils data provided by USDA and NRCS.