

Soils Map

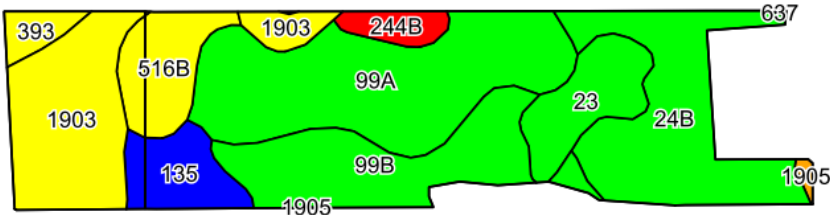

©2026 AgriData, Inc.

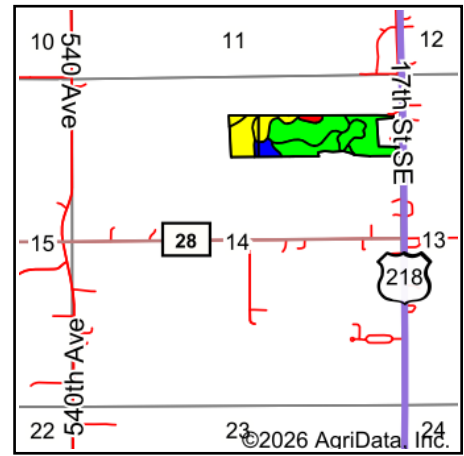

State: **Minnesota**
 County: **Mower**
 Location: **14-102N-18W**
 Township: **Austin**
 Acres: **36.53**
 Date: **2/6/2026**

Maps Provided By:

 CUSTOMIZED ONLINE MAPPING
 © AgriData, Inc. 2025 www.AgriDataInc.com



Soils data provided by USDA and NRCS.

Area Symbol: MN099, Soil Area Version: 21

Code	Soil Description	Acres	Percent of field	PI Legend	Restrictive Layer	Soil Drainage	Non-Irr Class *c	Productivity Index	*n NCCPI Overall
99A	Racine silt loam, 0 to 2 percent slopes	9.51	26.0%		> 6.5ft.	Well drained	Is	98	73
24B	Kasson silt loam, 1 to 4 percent slopes	6.65	18.2%		> 6.5ft.	Moderately well drained	Ile	95	79
1903	Udolpho silt loam, loamy substratum, swales	5.98	16.4%		> 6.5ft.	Poorly drained	Illw	70	75
99B	Racine loam, 2 to 5 percent slopes	5.62	15.4%		> 6.5ft.	Well drained	Ile	91	66
23	Skyberg silt loam, 0 to 3 percent slopes	2.56	7.0%		> 6.5ft.	Somewhat poorly drained	Iw	95	82
516B	Dowagiac loam, 2 to 6 percent slopes	2.47	6.8%		> 6.5ft.	Well drained	Ile	64	68
135	Donnan silt loam	2.07	5.7%		> 6.5ft.	Somewhat poorly drained	Ilw	84	72
244B	Lilah sandy loam, 2 to 6 percent slopes	0.82	2.2%		> 6.5ft.	Excessively drained	IVs	43	53
393	Udolpho silt loam	0.71	1.9%		> 6.5ft.	Poorly drained	Ilw	70	76
1905	Brownsdale silt loam	0.14	0.4%		> 6.5ft.	Poorly drained	Illw	77	88
Weighted Average							1.88	86.6	*n 73.2

*n: The aggregation method is "Weighted Average using all components"

*c: Using Capabilities Class Dominant Condition Aggregation Method

Soils data provided by USDA and NRCS.