

# Soils Map

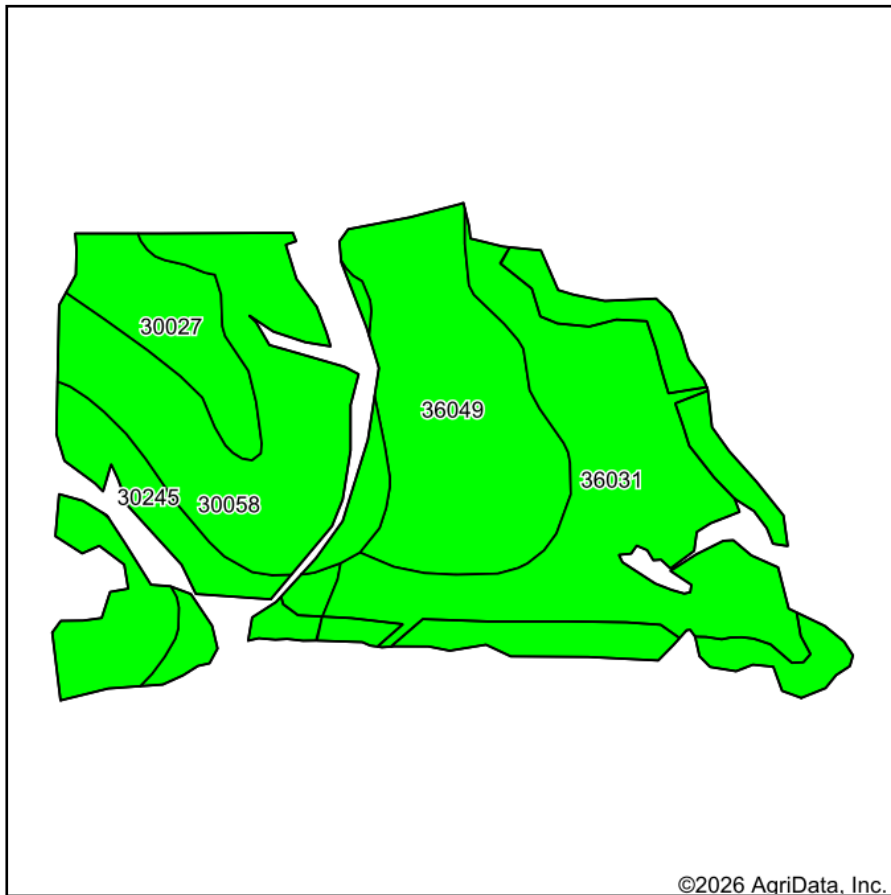

Soils data provided by USDA and NRCS.

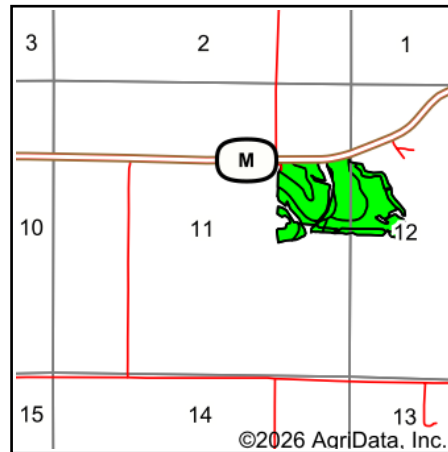

State: **Missouri**  
 County: **Putnam**  
 Location: **11-66N-22W**  
 Township: **York**  
 Acres: **57.76**  
 Date: **4/6/2026**



Maps Provided By:



© AgriData, Inc. 2025

www.AgriDataInc.com



Area Symbol: MO171, Soil Area Version: 27

Code	Soil Description	Acres	Percent of field	Non-Irr Class Legend	Non-Irr Class *c	Common bermudagrass Tons	Orchardgrass red clover Tons	Tall fescue AUM	Tall fescue Tons	Warm season grasses Tons	*n NCCPI Overall	*n NCCPI Corn	*n NCCPI Small Grains	*n NCCPI Soybeans
36031	Nodaway silt loam, 0 to 2 percent slopes, frequently flooded	21.14	36.6%		Illw	7	8	8	8	10	57	54	47	44
30058	Gara loam, 14 to 18 percent slopes, moderately eroded	15.86	27.5%		Vle						62	62	49	44
36049	Zook silty clay loam, 0 to 2 percent slopes, frequently flooded	12.14	21.0%		Illw	8	7	8	8	8	56	56	37	45
30245	Vigar-Zook-Nodaway complex, 2 to 5 percent slopes	4.38	7.6%		llw	7	8	7	7	9	64	59	56	52

Soils data provided by USDA and NRCS.



Code	Soil Description	Acres	Percent of field	Non-Irr Class Legend	Non-Irr Class *c	Common bermudagrass Tons	Orchardgrass red clover Tons	Tall fescue AUM	Tall fescue Tons	Warm season grasses Tons	*n NCCPI Overall	*n NCCPI Corn	*n NCCPI Small Grains	*n NCCPI Soybeans
30027	Armstrong clay loam, 5 to 9 percent slopes, moderately eroded	4.24	7.3%		Ille						60	60	54	41
<b>Weighted Average</b>					<b>3.75</b>	<b>4.8</b>	<b>5</b>	<b>5.1</b>	<b>5.1</b>	<b>6</b>	<b>*n 58.9</b>	<b>*n 57.4</b>	<b>*n 46.6</b>	<b>*n 44.6</b>

\*n: The aggregation method is "Weighted Average using all components"

\*c: Using Capabilities Class Dominant Condition Aggregation Method