

Soils Map

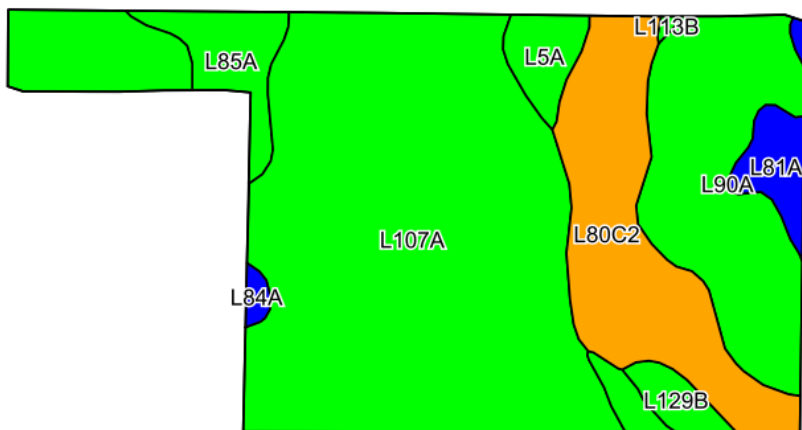

©2026 AgriData, Inc.

Soils data provided by USDA and NRCS.

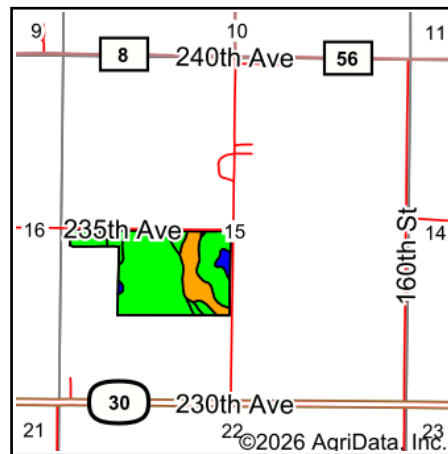

State: **Minnesota**
 County: **Waseca**
 Location: **15-105N-22W**
 Township: **New Richland**
 Acres: **54.3**
 Date: **3/30/2026**



Area Symbol: MN161, Soil Area Version: 20

Code	Soil Description	Acres	Percent of field	PI Legend	Restrictive Layer	Soil Drainage	Non-Irr Class *c	Productivity Index	*n NCCPI Overall
L107A	Canisteo-Glencoe complex, 0 to 2 percent slopes	30.23	55.6%		> 6.5ft.	Poorly drained	IIw	91	81
L90A	Le Sueur loam, 1 to 3 percent slopes	8.96	16.5%		> 6.5ft.	Somewhat poorly drained	Iw	97	90
L80C2	Lester loam, 6 to 10 percent slopes, moderately eroded	8.42	15.5%		> 6.5ft.	Well drained	IIle	76	77
L85A	Nicollet clay loam, 1 to 3 percent slopes	2.12	3.9%		> 6.5ft.	Somewhat poorly drained	Iw	99	81
L81A	Cordova clay loam, 0 to 2 percent slopes	1.45	2.7%		> 6.5ft.	Poorly drained	IIw	87	85
L5A	Delft, overwash-Delft complex, 1 to 4 percent slopes	1.32	2.4%		> 6.5ft.	Poorly drained	IIw	96	84
L129B	Terril loam, 2 to 6 percent slopes	0.90	1.7%		> 6.5ft.	Well drained	Ile	99	88
L36A	Hamel, overwash-Hamel complex, 0 to 3 percent slopes	0.58	1.1%		> 6.5ft.	Somewhat poorly drained	IIw	97	89
L84A	Glencoe clay loam, 0 to 1 percent slopes	0.25	0.5%		> 6.5ft.	Very poorly drained	IIIw	86	77
L113B	Reedslake-Le Sueur complex, 1 to 6 percent slopes	0.07	0.1%		> 6.5ft.	Moderately well drained	Ile	98	81
Weighted Average							1.96	90.2	*n 82.2

*n: The aggregation method is "Weighted Average using all components"

*c: Using Capabilities Class Dominant Condition Aggregation Method

Soils data provided by USDA and NRCS.