

# Soils Map

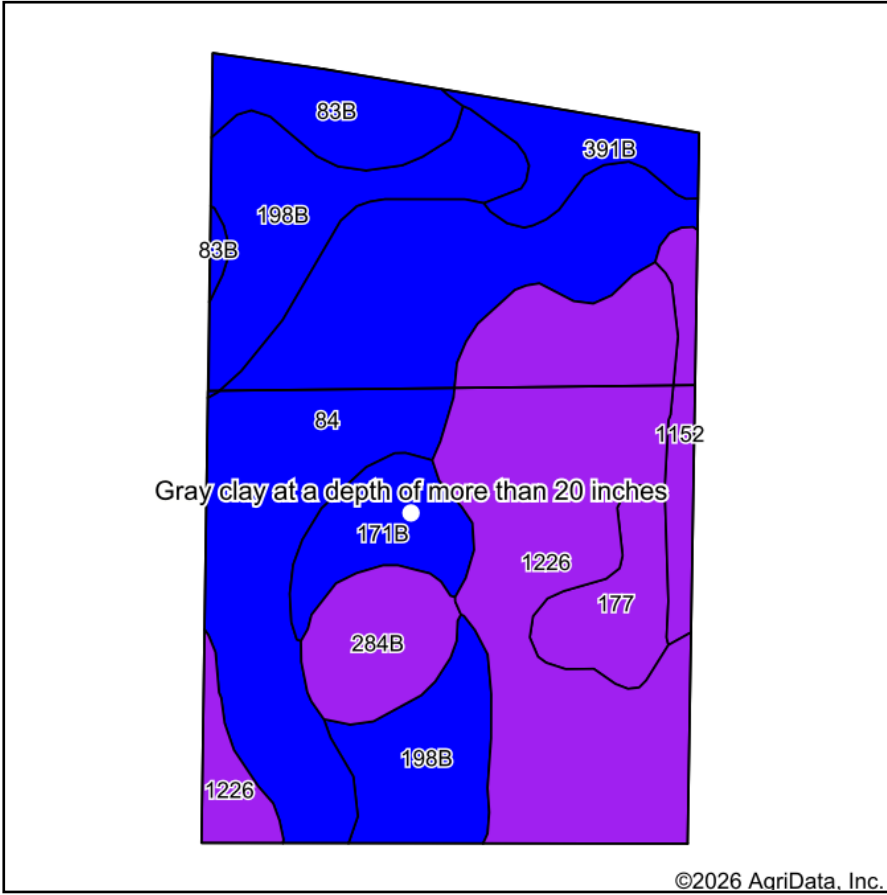

Soils data provided by USDA and NRCS.

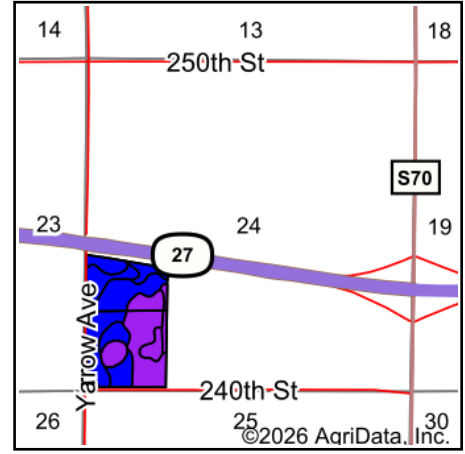

State: **Iowa**  
 County: **Cerro Gordo**  
 Location: **24-96N-19W**  
 Township: **Portland**  
 Acres: **61.08**  
 Date: **4/17/2026**



Maps Provided By:



Area Symbol: IA033, Soil Area Version: 29

Code	Soil Description	Acres	Percent of field	CSR2 Legend	Restrictive Layer	Soil Drainage	Non-Irr Class *c	*j Corn Bu	*i Alfalfa Tons	*j Soybeans Bu	*j Bluegrass Tons	*i Tall Grasses Tons	*i Water-Holding Inch	CSR2**	CSR
84	Clyde silty clay loam, 0 to 3 percent slopes	17.83	29.1%		> 6.5ft.	Poorly drained	llw	224.0	4.7	65.0	4.0	6.7	11.7	88	78
1226	Lawler loam, 0 to 2 percent slopes, rarely flooded	17.66	28.9%		> 6.5ft.	Somewhat poorly drained	lls	80.0	2.1	23.2	1.4	2.4	0.0	59	71
198B	Floyd loam, 1 to 4 percent slopes	9.35	15.3%		> 6.5ft.	Somewhat poorly drained	llw	222.4	5.8	64.5	4.0	6.7	10.8	89	78
83B	Kenyon loam, 2 to 5 percent slopes	3.22	5.3%		> 6.5ft.	Moderately well drained	lle	225.6	6.3	65.4	4.1	6.8	10.1	90	83
284B	Flagler sandy loam, 2 to 5 percent slopes	3.16	5.2%		> 6.5ft.	Somewhat excessively drained	llle	80.0	2.2	23.2	1.4	2.4	5.0	51	37
171B	Bassett loam, 2 to 5 percent slopes	2.97	4.9%		> 6.5ft.	Moderately well drained	lle	212.8	6.0	61.7	3.8	6.4	11.1	85	78

Soils data provided by USDA and NRCS.



Code	Soil Description	Acres	Percent of field	CSR2 Legend	Restrictive Layer	Soil Drainage	Non-Irr Class *c	*j Corn Bu	*j Alfalfa Tons	*j Soybeans Bu	*j Bluegrass Tons	*j Tall Grasses Tons	*j Water-Holding Inch	CSR2**	CSR	
177	Saude loam, 0 to 2 percent slopes	2.65	4.3%		2.3ft. (Strongly contrasting textural stratification)	Well drained	lls	80.0	2.2	23.2	1.4	2.4	6.6	60	63	
391B	Clyde-Floyd complex, 1 to 4 percent slopes	2.49	4.1%		> 6.5ft.	Poorly drained	llw	216.0	4.5	62.6	3.9	6.5	11.2	87	78	
1152	Marshan clay loam, 0 to 2 percent slopes, rarely flooded	1.75	2.9%		> 6.5ft.	Poorly drained	llw	80.0	1.7	23.2	1.4	2.4	0.0	54	67	
<b>Weighted Average</b>								<b>2.05</b>	<b>163.5</b>	<b>3.9</b>	<b>47.4</b>	<b>2.9</b>	<b>4.9</b>	<b>7.1</b>	<b>75.6</b>	<b>73.2</b>

\*\*IA has updated the CSR values for each county to CSR2.

\*j Yield data provided by the ISPAID Database version 8.1.1 developed by IA State University.

\*c: Using Capabilities Class Dominant Condition Aggregation Method

Symbol	Name	Description
DGC	Gray clay at a depth of more than 20 inches	An area of dense gray clay at a depth of more than 20 inches that formed in paleosol weathered from glacial till. Textures included would be clay and silty clay that have clay contents greater than 40 percent. Typically .5 to 2 acres.