

OWNER'S ACKNOWLEDGMENT AND DEDICATION
 I, the owner of the property shown on this plat and designated as JOHNNY Q. GRIFFIN, II 31.12 AC. TRACT in Walker County, Texas, hereby dedicate to the use of the public forever all streets, parks, utility easements and public places thereon shown for the purpose and consideration therein expressed.

NOTARY PUBLIC ACKNOWLEDGMENT
 The State of Texas X
 County of Walker X
 This instrument was acknowledged before me on the 13th day of August, 2008 by Johnny Quincy Griffin, II

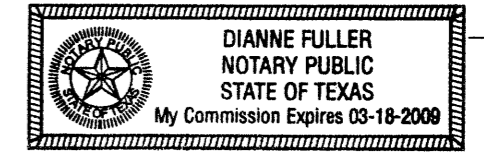

- NOTES:
- A Subdivision of 31.12 acres consisting of a parcel of land described in a Deed to Johnny Quincy Griffin, II recorded in Volume 195, page 533, Official Public Records of Walker County, Texas.
 - The purpose of this plat is to create LOT 1 and UNRESTRICTED RESERVE as shown and to dedicate to the Public the 20 foot wide Utility Easement across LOT 1 as shown.
 - Owner: Johnny Q. Griffin, II
 P.O. Box 1235
 Huntsville, TX. 77342
 - Unless otherwise noted, corners shown hereon are 5/8" iron rods set with 1-3/4" diameter plastic cap stamped "J.S. Moorer RPLS 1572"
 - All public easements denoted on this plat are hereby dedicated to the use of the public forever. Any public utility, including the City of Huntsville, shall have the right of all times of ingress and egress to and from and upon said easements for the purpose of construction, reconstruction, inspection, patrolling, maintaining and adding to or removing all or parts of its respective systems without the necessity at any time of procuring the permission of the property owner. Any public utility, including the City of Huntsville, shall have the right to move and keep moved all or part of any building, fences, trees, shrubs, other growths or improvements that in any way endanger or interfere with the construction, maintenance or efficiency of its respective systems on any of the easements shown on this plat. Neither the City of Huntsville or any public utility shall be responsible for replacing or reimbursing the property owner due to removal or relocation of any obstructions in the public easements.

James L. Hall
 Call 124.38 Ac.
 Vol. 270, p. 722, W.C.O.P.R.

CERTIFICATION BY THE CITY PLANNING OFFICER
 I, the undersigned, Planning Officer of the City of Huntsville, Texas, certify that this plat conforms to the City of Huntsville Comprehensive Plan and that all applicable design criteria and standards of the City of Huntsville, Texas.
 DATED this the 15 day of August, 2008
 Signed: [Signature]
 Planning Officer, City of Huntsville

CERTIFICATION BY THE CITY ENGINEER
 I, the undersigned, City Engineer of the City of Huntsville, Texas, hereby certify that proper engineering consideration has been given to this plat in regard to the design and construction of public improvements and related easements and rights of way.
 DATED this the 15 day of August, 2008
 Signed: [Signature]
 City Engineer, City of Huntsville

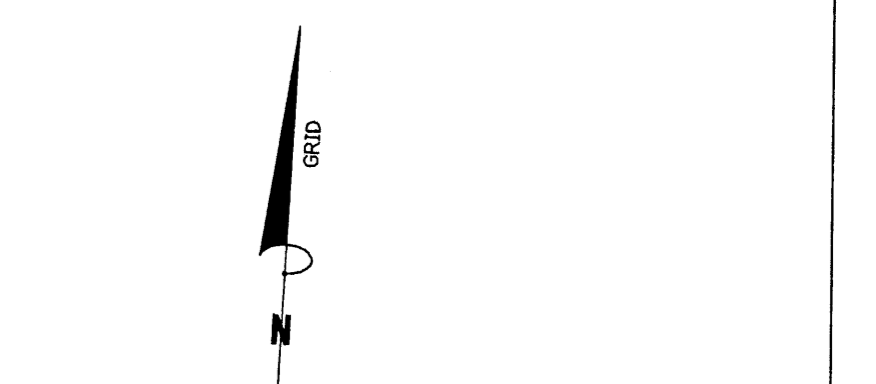

MINOR PLAT OF
JOHNNY Q. GRIFFIN, II 31.12 AC. TRACT

ALEXANDER BROWN SURVEY, A-94
H.D. RIPLEY SURVEY, A-489
WALKER COUNTY, TEXAS

APRIL 2008
 SCALE 1" = 100 FEET

MOORER & WOODS, INC.
 Reg. Prof. Land Surveyors
 P.O. Box 981
 Huntsville, Texas 77342

08033

COORDINATE SYSTEM AND BASIS OF BEARINGS
 1. Coordinates and bearings hereon are referred to the Texas Plane Coordinate System, Central Zone (NAD83) and are based on the position of City of Huntsville Control Monuments 6013 and 6306 having published coordinates of N= 10,238,639.884 ft., E= 3,811,449.271 ft. and N= 10,239,601.385 ft., E= 3,811,029.982 ft. respectively.
 2. Distances hereon are GRID and may be reduced to SURFACE HORIZONTAL by dividing by a combined scale factor of 0.99988.

I, J.S. Moorer, certify that this plat represents a survey made on the ground under my supervision and that all corners and monuments are as shown.
 April 25, 2008
 Signed: [Signature]
 J. S. Moorer
 Reg. Prof. Land Surveyor No. 1572

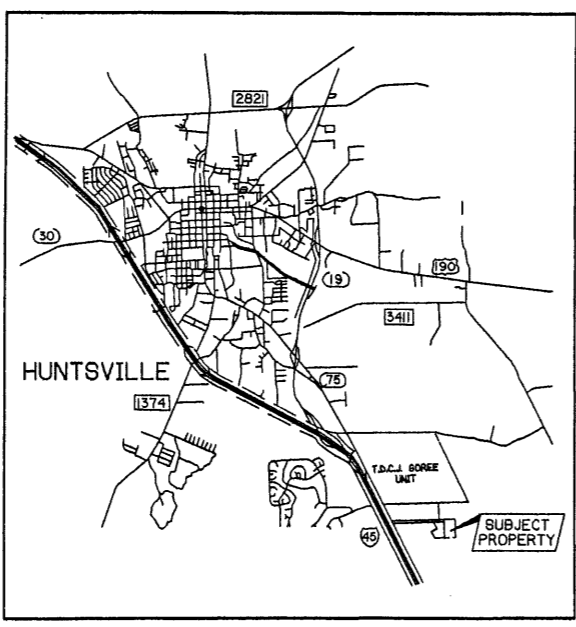

GIBBS BROTHERS--RIPLEY ONE SUBDIVISION
 Plat -- Vol. 3, p. 112, W.C.P.R.

Cymetech, L.L.C.
 Vol. 441, p. 150, W.C.O.P.R.
 TRACT 2
 15.42 AC.

Johnny Quincy Griffin, II
 Call 31.12 Ac.
 Vol. 195, p. 533, W.C.O.P.R.

ALEXANDER BROWN SURVEY
 A - 94

LOT 1
 14.95 ACRES

UNRESTRICTED RESERVE
 16.17 ACRES

CERTIFICATION BY COUNTY CLERK
 THE STATE OF TEXAS X
 COUNTY OF WALKER X
 I, James D. Patton, County Clerk in and for said County, do hereby certify that this plat together with its certificates of authentication was filed for record in my office the 15th day of August, 2008 in the Plat Records of Walker County, Texas in Volume 111, page 141.

James D. Patton, County Clerk
 Walker County, Texas
 By: [Signature]
 Deputy

THIS PLAT COMPLIES WITH SECTION 12.002 OF THE PROPERTY CODE (e)