

User Name: JAHAZIE
 CERTIFICATE OF RECORD
 STATE OF ARKANSAS, COUNTY OF BENTON
 I hereby certify that this instrument was
 filed and Recorded in the Official Records

L202150083 7/6/2021 8:43:07
 Brenda Deshields, Circuit Clerk
 BENTON CO Circuit Clerk & Records

FILING BLOCK

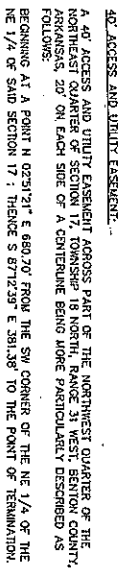

18-08462-000
BROWN, WILLIAM M JR

SURVEY DESCRIPTION PARENT TRACT:

A PART OF THE NORTHWEST QUARTER OF THE NORTHEAST QUARTER OF SECTION 17, TOWNSHIP 18 NORTH, RANGE 31 WEST, BENTON COUNTY, ARKANSAS, BEING MORE PARTICULARLY DESCRIBED AS FOLLOWS:

BEGINNING AT THE SOUTHWEST CORNER OF THE NORTHWEST 1/4 OF THE NORTHWEST 1/4 OF SAID SECTION 17; THENCE S 87°12'45" E 1313.89'; THENCE N 03°08'34" E 660.67'; THENCE N 87°12'39" W 1312.20'; THENCE S 02°52'02" W 660.70'; TO THE POINT OF BEGINNING AND CONTAINING 19.95 ACRES. PROPERTY SUBJECT TO THE RIGHT OF WAY OF REAMS RD AND ANY EASEMENT OF RECORD.

SURVEY DESCRIPTION TRACT 1:

A PART OF THE NORTHWEST QUARTER OF THE NORTHEAST QUARTER OF SECTION 17, TOWNSHIP 16 NORTH, RANGE 31 WEST, BENTON COUNTY, ARKANSAS, BEING MORE PARTICULARLY DESCRIBED AS FOLLOWS:

BEGINNING AT A POINT N 07°12'45" 328.07' FROM THE SOUTHWEST CORNER OF THE NORTHWEST 1/4 OF THE NORTHEAST 1/4 OF SWD SECTION 17, T19N, E 87°12'45" 985.82'; THENCE N 03°08'34" E 660.67'; E 660.67'; S 81°12'39" W 985.82'; THENCE S 03°08'34" W 660.67'; TO THE POINT OF BEGINNING AND CONTAINING 14.95 ACRES. PROPERTY IS SUBJECT TO THE RIGHT OF WAY OF REMAS RD AND ANY EASEMENT OF RECORD.

SURVEY DESCRIPTION TRACT 2:

A PART OF THE NORTHWEST QUARTER OF THE NORTHEAST QUARTER OF SECTION 17, TOWNSHIP 18 NORTH, RANGE 31 WEST, BENTON COUNTY, ARKANSAS, BEING MORE PARTICULARLY DESCRIBED AS FOLLOWS:

BEGINNING AT THE SOUTHWEST CORNER OF THE NORTHEAST 1/4 OF SAID SECTION 17; THENCE N 02°22'02" E 660.70'; THENCE S 87°12'39" E 331.87'; THENCE S 03°03'34" W 660.66'; THENCE N 87°12'45" W 328.07'; TO THE POINT OF BEGINNING AND CONTAINING 5.00 ACRES, PROPERTY SUBJECT TO THE RIGHT OF WAY OF REAS RD. AND ANY EASEMENT OF RECORD.

HIGHELL PLANNING BOARD:

The Planning Board, based on an approval granted to the applicant on 4/27/21 hereby endorses this plan as meeting all of the

requirements of a Tract Split

Planning

OWNER'S CERTIFICATION

As owners, we hereby certify that we have caused the land to be surveyed, divided, plotted, dedicated and access rights reserved as represented on this plat and attachments.

91

STATE OF ARKANSAS
COUNTY OF BENTON

My commission expires July 13 2022

Notary Public

STATE OF TEXAS
ID# 125549129
MY COMM. EXPI. APR 13 2022

WITHIN ANY PRESENTLY ESTABLISHED 100-YEAR FLOODPLAIN AS DETERMINED BY THE FLOOD INSURANCE RATE MAP FOR BENTON COUNTY, ARKANSAS AND INCORPORATED THEREIN.

ON PLATTED AND DESCRIBED SURVEY WAS COMPLETED AND MONUMENTS WERE FOUND OR

0201 SE REAMS RD, HIGHFILL, AR. 72712 PARCEL #22-00262-060

TRACT SPLIT

STATE OF
ARKANSAS
JURY
JUDITH HUGHES

STATE OF MASSACHUSETTS
COUNTY OF WORCESTER

BEFORE ME, the undersigned authority, on this day personally appeared _____, known to me to be the person whose name is subscribed to the foregoing instrument, acknowledged to me that he executed the same for the purposes and consideration therein expressed.

GIVEN UNDER MY HAND AND SEAL OF OFFICE this ____ day of _____, 20__.

Notary Public for the State of Massachusetts

BENTON COUNTY, ARKANSAS

CONFIDENTIAL

DEAL E. JAMES, PLS #985
TON COUNTY SURVEYOR

JOB NUMBER: JS16211A
FILE NAME: JS16211A.DWG

FILE NAME: JS16211A.DWG

FILE NAME: JS16211A.DWG

FILE NAME: JS16211A.DWG