

SANDRA L DARBY (RS)
6003 DUTCHMAN CREEK RD
SOUTHPORT, NC 28461

Assess Year: 2025 Printed: 2025-10-11 12:32

| Values | |
|------------|---------|
| Land: | 187,800 |
| Build: | 200,800 |
| Other: | 900 |
| Total: | 389,500 |
| Heated SF: | 2016 |
| Road: | 632 |
| Class: | 5 |
| MH: | 0 |
| Acres: | 39.1709 |

P1 4414-()-55-
311 DAN RIVER RD
DAN R
PL: 1/117-J I#24-860
FR SUSAN DEVEREAUX MOORE
I#24-860

Topo: ROLLING
Utilities: WELL, SEP SYS
Zoning:
Street: NO PUBLIC ROAD

| Building Info | |
|-------------------------|--------------|
| Cnst: CONVENTIONAL | YrBlt: 2001 |
| Bsnm: | YrRmd: 0000 |
| Fuel: ELECTRIC | YrEff: 2001 |
| Fndt: BRICK | PhysC: G |
| Roof: GABLE | FEDP: 0 |
| Rfmt: COMP SHGLS | DEPO: 0 |
| Wall: DRY WALL | SndVal: 0 |
| Floor: HARDWOOD, CARPET | Rms: 5 BR: 3 |

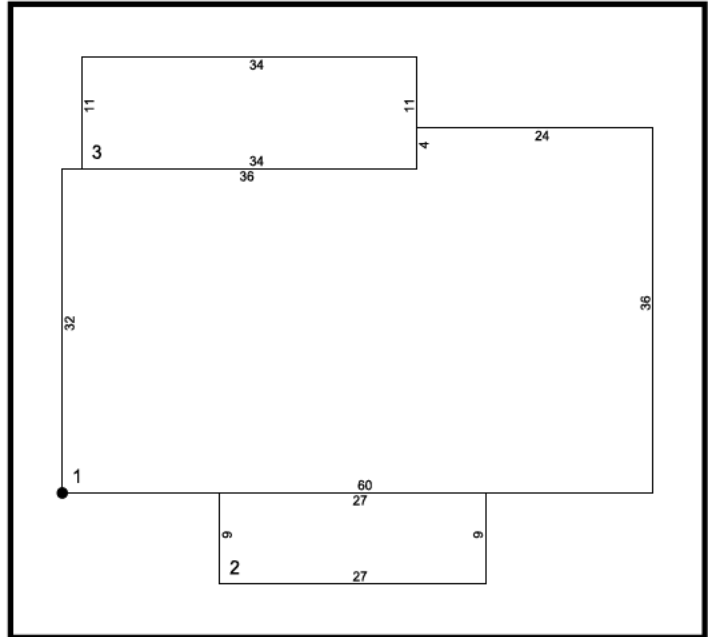

Sales
Date: U 05/30/2024 Tracts: 1
DB/WB: - / -
Instrumt: 24-860
Plat:
Grantor: SUSAN DEVEREAUX MOORE

Reassessment
List: MH Date: 02/07/2020 Info By: E
Review:
Revisit:
Appeal:
Last Reval: 2021

| Land: | Segment | Class | Description | Method | Grade | Acres | Lots | Base Rate | Adjusted Rate | Asmt Value |
|-------|---------|-------|-------------|----------------|-------|---------|------|---------------|---------------|----------------|
| | 1 | 2 | BLDG SITE | ACREAGE METHOD | E | 1.0000 | | 16,000 | 16,000 | 16,000 |
| | 2 | 24 | WOODLAND | ACREAGE METHOD | C | 38.1709 | | 5,000 | 4,500 | 171,769 |
| | | | | | | | | <u>21,000</u> | <u>20,500</u> | <u>187,769</u> |

| Building: | Section | %Cmp | Class | Description | Grade | Finish | HVAC | Cnt | Area | Story | Wall | EffYr | RepCstNew | Asmt Value |
|-----------|----------|------|-------|-----------------|-------|-------------|-----------|-----|------|-------|------|-------|----------------|----------------|
| | 1 | 100 | 1 | SINGLE FAMILY | C+10 | VINYL | HEAT PUMP | 1 | 2016 | 1.00 | 1.00 | 2001 | 142,303 | 129,638 |
| | 2 | 100 | 106 | OPN MAS PORCH | C+10 | | | 1 | 243 | 1.00 | 1.00 | 2001 | 3,969 | 3,616 |
| | 3 | 100 | 112 | WOOD DECK | C+10 | | | 1 | 374 | 1.00 | 1.00 | 2001 | 8,738 | 7,960 |
| | Basement | 100 | | W/OUT | C+10 | UNFINISHED | | | 2016 | | | | 26,611 | 24,243 |
| | Basement | 100 | | W/OUT | C+10 | SEMIFINISHE | | | 864 | | | | 7,603 | 6,926 |
| | Basement | 100 | | W/OUT | C+10 | FINISHED | | | 1152 | | | | 19,008 | 17,316 |
| | Opening | 100 | | FRPL OPENINGS | C | | | 1 | | | | | 1,200 | 1,093 |
| | Chimney | 100 | | 1 STORY MASONRY | C | | | 1 | | | | | 3,000 | 2,733 |
| | Plumbing | 100 | | 3FXBTH | C | | | 2 | | | | | 6,000 | 5,466 |
| | Plumbing | 100 | | 2FXBTH | C | | | 1 | | | | | 2,000 | 1,822 |
| | | | | | | | | | | | | | <u>220,433</u> | <u>200,814</u> |

| Other Features: | Section | %Cmp | Class | Description | Grade | Cond | Comment | Area | Story | BaseRt | BldYr | Asmt Value |
|-----------------|---------|------|-------|-------------|-------|------|---------|------|-------|--------|-------|------------|
| | 1 | 100 | 48 | POLE SHEL | C | -30 | 13x24 | 312 | 1.00 | 4.26 | 2002 | 930 |