

Soils Map

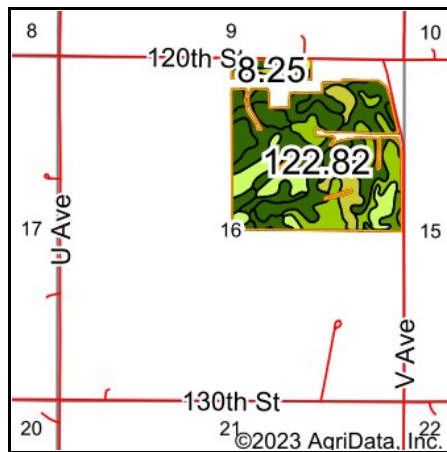

Soils data provided by USDA and NRCS.



State: **Iowa**
 County: **Boone**
 Location: **16-85N-25W**
 Township: **Harrison**
 Acres: **131.07**
 Date: **5/4/2023**



Maps Provided By:

 CUSTOMIZED ONLINE MAPPING
 © AgriData, Inc. 2023 www.AgriDataInc.com



Area Symbol: IA015, Soil Area Version: 30

Code	Soil Description	Acres	Percent of field	CSR2 Legend	Non-Irr Class *c	CSR2**	CSR
107	Webster clay loam, 0 to 2 percent slopes	41.01	31.3%		IIw	86	87
138C	Clarion loam, 6 to 10 percent slopes	13.54	10.3%		IIIe	84	69
62D2	Storden loam, 10 to 16 percent slopes, moderately eroded	12.36	9.4%		IVe	41	38
823B	Ridgeport sandy loam, 2 to 5 percent slopes	8.84	6.7%		IIIe	51	35
639D	Storden-Salida complex, 9 to 14 percent slopes	8.15	6.2%		IVe	29	28
138B	Clarion loam, 2 to 6 percent slopes	7.62	5.8%		IIe	89	84
828B	Zenor sandy loam, 2 to 5 percent slopes	6.88	5.2%		IIIe	52	46
73D	Hawick gravelly sandy loam, 6 to 12 percent slopes	5.36	4.1%		IVs	31	5
135	Coland clay loam, 0 to 2 percent slopes, occasionally flooded	4.94	3.8%		IIw	76	82
55	Nicollet clay loam, 1 to 3 percent slopes	4.29	3.3%		Iw	89	92
62C2	Storden loam, 6 to 10 percent slopes, moderately eroded	3.34	2.5%		IIIe	64	53
27C	Terril loam, 5 to 9 percent slopes	3.24	2.5%		IIIe	85	69
28B	Dickman sandy loam, 2 to 6 percent slopes	3.06	2.3%		IIIe	20	46
829D2	Zenor-Storden complex, 9 to 14 percent slopes, moderately eroded	2.93	2.2%		IVe	20	28
203	Cylinder loam, 0 to 2 percent slopes	2.60	2.0%		IIIs	58	80
507	Canisteo clay loam, 0 to 2 percent slopes	1.76	1.3%		IIw	84	82
828C	Zenor sandy loam, 5 to 9 percent slopes	1.15	0.9%		IIIe	47	31
Weighted Average						2.71	67 63.4

**IA has updated the CSR values for each county to CSR2.

*c: Using Capabilities Class Dominant Condition Aggregation Method