

# Soils Map

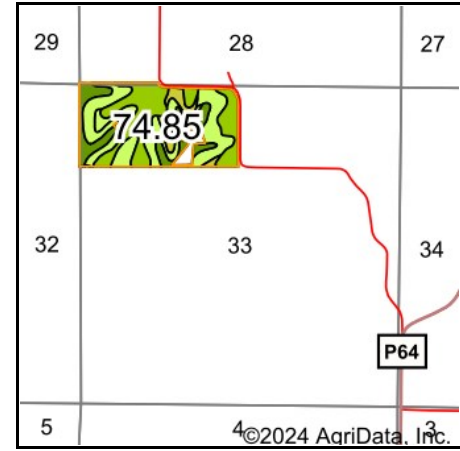

State: **Iowa**  
 County: **Union**  
 Location: **33-71N-28W**  
 Township: **Pleasant**  
 Acres: **74.85**  
 Date: **5/18/2024**

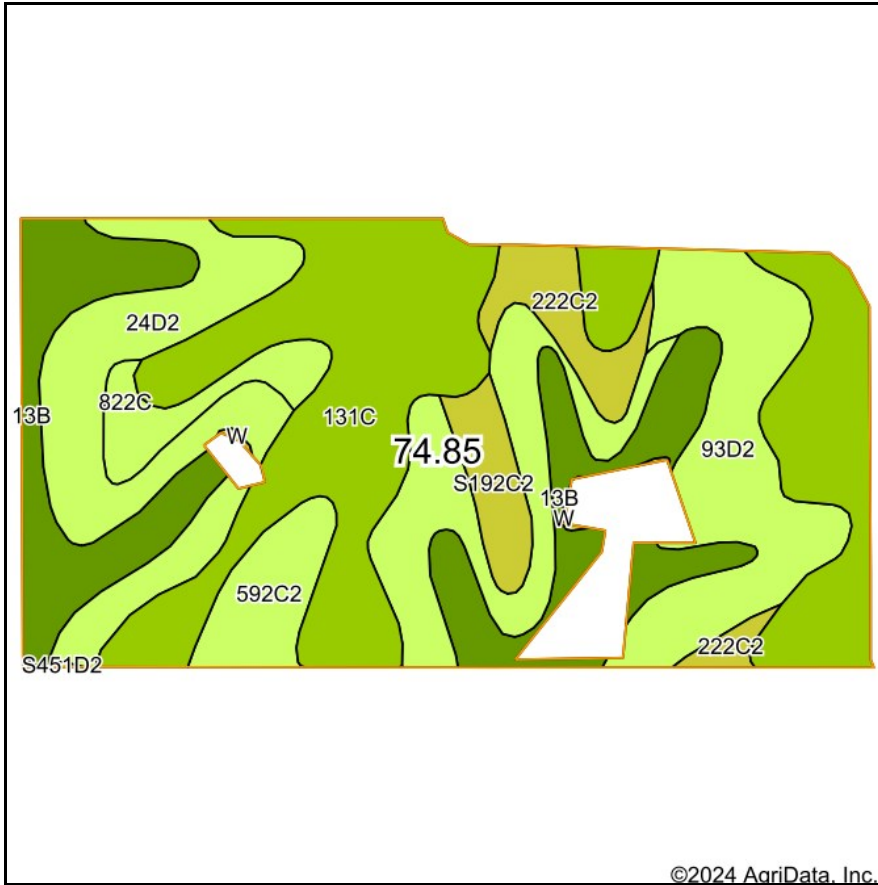

Maps Provided By:



Area Symbol: IA175, Soil Area Version: 26

Code	Soil Description	Acres	Percent of field	CSR2 Legend	Non-Irr Class *c	CSR2**	CSR
131C	Pershing silt loam, 5 to 9 percent slopes	24.68	32.9%		Ille	65	49
24D2	Shelby clay loam, 9 to 14 percent slopes, moderately eroded	17.05	22.8%		Ille	46	48
13B	Nodaway-Vesser silt loams, 2 to 5 percent slopes	12.71	17.0%		Ilw	77	42
93D2	Adair-Shelby clay loams, 9 to 14 percent slopes, moderately eroded	9.50	12.7%		Ive	32	25
222C2	Clarinda silty clay loam, 5 to 9 percent slopes, moderately eroded	3.18	4.2%		IVw	28	25
592C2	Mystic silt loam, 5 to 9 percent slopes, moderately eroded	3.06	4.1%		Ille	34	20
822C	Lamoni silty clay loam, 5 to 9 percent slopes	2.39	3.2%		Ille	42	35
S192C2	Adair clay loam, heavy till, 5 to 9 percent slopes, moderately eroded	2.16	2.9%		Ille	29	
W	Water	0.12	0.2%			0	0
<b>Weighted Average</b>					<b>*-</b>	<b>53.8</b>	<b>*-</b>

\*- Non Irr Class weighted average cannot be calculated on the current soils data due to missing data.

\*c: Using Capabilities Class Dominant Condition Aggregation Method

\*- CSR weighted average cannot be calculated on the current soils data, use prior data version for csr values.

\*- Non Irr Class weighted average cannot be calculated on the current soils data due to missing data.