

**LAND FOR SALE - 281 ACRES - TILLABLE - NEW CASTLE,
INDIANA - HENRY COUNTY**
0000 N Muncie Pike
New Castle, IN 47362

\$4,495,000
281± Acres
Henry County



LAND FOR SALE - 281 ACRES - TILLABLE - NEW CASTLE, INDIANA - HENRY COUNTY

New Castle, IN / Henry County

SUMMARY

Address

0000 N Muncie Pike

City, State Zip

New Castle, IN 47362

County

Henry County

Type

Farms, Recreational Land, Business Opportunity

Latitude / Longitude

40.042932 / -85.322027

Taxes (Annually)

5234

Acreage

281

Price

\$4,495,000

Property Website

<https://indianalandandlifestyle.com/property/land-for-sale-281-acres-tillable-new-castle-indiana-henry-county-henry-indiana/46789/>



MORE INFO ONLINE:

<https://indianalandandlifestyle.com/>

LAND FOR SALE - 281 ACRES - TILLABLE - NEW CASTLE, INDIANA - HENRY COUNTY

New Castle, IN / Henry County

PROPERTY DESCRIPTION

Description

This expansive 281+/- acre farm, comprising three parcels, is a rare opportunity for seasoned farmers and investors seeking tillable land with exceptional potential. Nestled in the heart of Henry County, Indiana, this property boasts incredible soil quality and great crop yields. Property Can be split. Final acres will be contingent on new survey.

Property Highlights:

Total Acreage: Approximately 281 acres +/-

Location: Off N Muncie Pike and E 700 N

Road Frontage: Over 2,200 feet along E 700 N and over 4,500 feet N Muncie Pike

- **Tillable Farmland:** The farm is predominantly composed of rich, tillable soil, making it ideal for various crops
- **Great Soil Quality:** The property's soil quality is exceptional, providing an excellent foundation for continued high yields
- **Convenient Access:** Situated a few miles off Hwy 36 and on N Muncie Pike, this farm offers easy access for equipment, transportation, and distribution.

Soil References

Soil Code	Soil Name	Total Acres	% of Field	NCCPI
Ma	Martisco muck, drained, loamy substratum	108.2	40%	73.2
Mx	Millgrove loam	104.2	38.5%	76.9
EdA	Eldean silt loam, 0 to 2 percent slopes	29.4	10.9%	66.3
Sk	Sleeth silt loam, 0 to 2 percent slopes	14.8	5.5%	87.5
Wb	Washtenaw silt loam	5.7	2.1%	83.9
LhD3	Losantville clay loam, 12 to 18 percent slopes, severely eroded	4.6	1.7%	31.5
LeE2	Losantville silt loam, 18 to 30 percent slopes, eroded	3.4	1.2%	14.4
LsE2	Losantville silt loam, stony subsoil, 18 to 30 percent slopes, eroded	0.3	0.1%	15.1
Total		270.6		73.4 avg

Investment Opportunity: Whether you're an experienced farmer looking to expand your operations or an astute investor seeking a valuable asset, this farm presents an enticing opportunity. With a solid track record of productivity and prime location, the potential for income and growth is substantial.

Location: Henry County, Indiana, is known for its fertile farmland.

For more information call or text Land Specialist Caleb Low at [317-691-0462](tel:317-691-0462) or Elizabeth Trennepohl at [616-690-3194](tel:616-690-3194).



LAND FOR SALE - 281 ACRES - TILLABLE - NEW CASTLE, INDIANA - HENRY COUNTY
New Castle, IN / Henry County



Locator Map

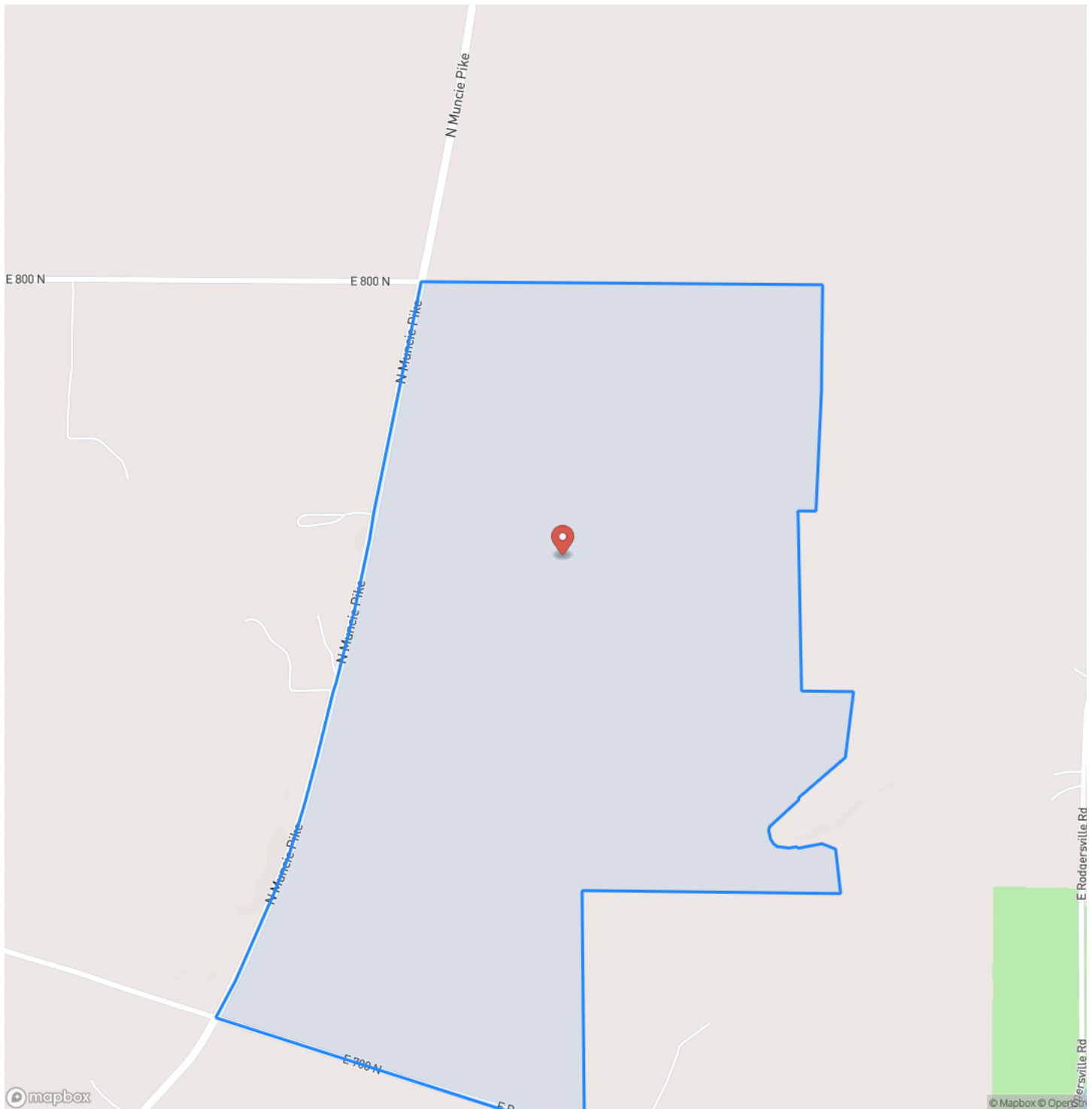

LAND FOR SALE - 281 ACRES - TILLABLE - NEW CASTLE, INDIANA - HENRY COUNTY
New Castle, IN / Henry County

Locator Map

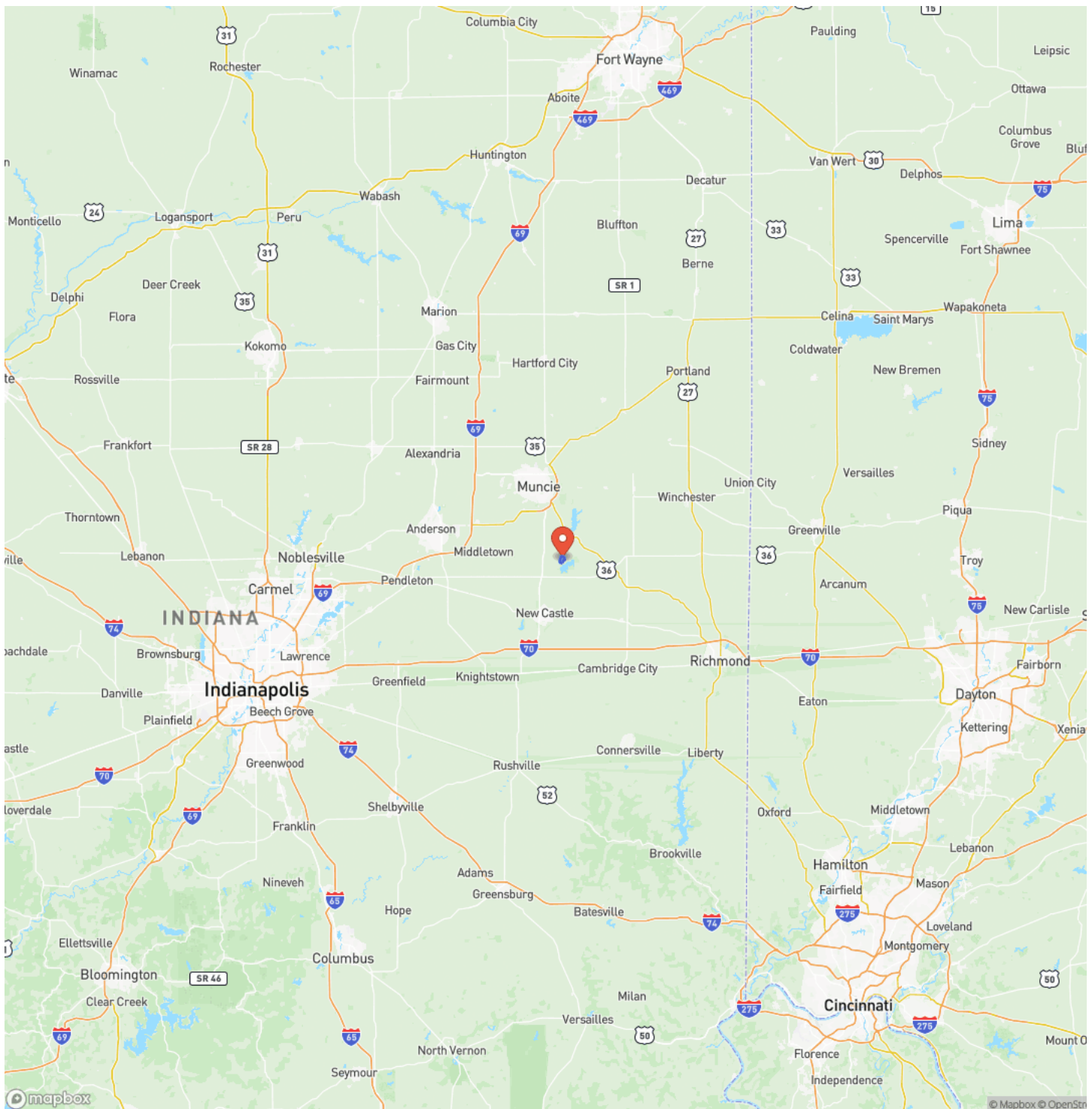

Satellite Map



New Castle, IN / Henry County

For more information contact:



Caleb Low

(317) 691-0462

(317) 691-0462

clow@mossyoakproperties.com

4965 S Morristown Pike

Greenfield, IN 46140

This image shows a blank sheet of white paper with horizontal ruling lines. The lines are evenly spaced and run across the width of the page. There are no margins, text, or other markings on the paper.



MORE INFO ONLINE:

<https://indianalandandlifestyle.com/>

This image shows a blank sheet of white paper with horizontal ruling lines. The lines are evenly spaced and run across the width of the page. There are no margins, text, or other markings on the paper.



<https://indianalandandlifestyle.com/>

DISCLAIMERS

Information in this brochure is provided solely for information purposes and does not constitute an offer to sell or advertise real estate outside the states in which broker or agent licensed. The information presented has been obtained from sources deemed to be reliable, but is not guaranteed or warranted by the agent, broker, or the sellers of these properties. This offering is subject to errors, omissions, prior sale, price change, correction or withdrawal from the market without notice. All references to age, square footage, income, expenses, acreage, carrying capacity, and land classification, etc. are approximate. Prospective buyers are chargeable with and expected to conduct their own independent investigation of the information and the property and to rely only on those results. Sellers reserve the right to accept or reject any and all offers without liability to any buyer or cooperating broker.

Maps are provided for illustration purposes only, the accuracy is not warranted. Parcels on interactive maps are not adjusted to match aerial backgrounds. This information is for reference purposes only and is not a legal document. Data maps contain errors. The seller and seller's agent are making known to all potential buyers that there may be variations between the location of the existing fence lines and the legal description of the deeded property. Seller and seller's agent make no warranties with regard to the location of the fence lines in relationship to the deeded property lines, nor does the Seller make any warranties or representations with regard to the specific acreage contained within the fenced property lines. Seller is selling the property in an "as is" condition, which includes the location of the fences as they exist. Boundaries shown on the accompanying maps are approximate, based on county parcel data. The maps are not to scale. The accuracy of the maps is not guaranteed. Prospective buyers are encouraged to verify fence lines, deeded property lines and acreages using a licensed surveyor at their own expense.



Mossy Oak Properties Indiana Land and Lifestyle

PO Box 10

Clinton, IN 47842

(765) 505-4155

<https://indianalandandlifestyle.com/>



MORE INFO ONLINE:

<https://indianalandandlifestyle.com/>