

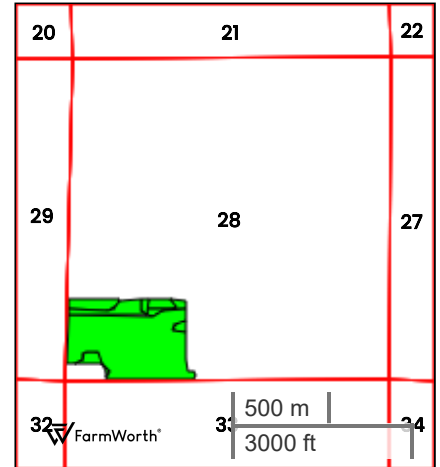

TRACT 13  
TILLABLE SOILS

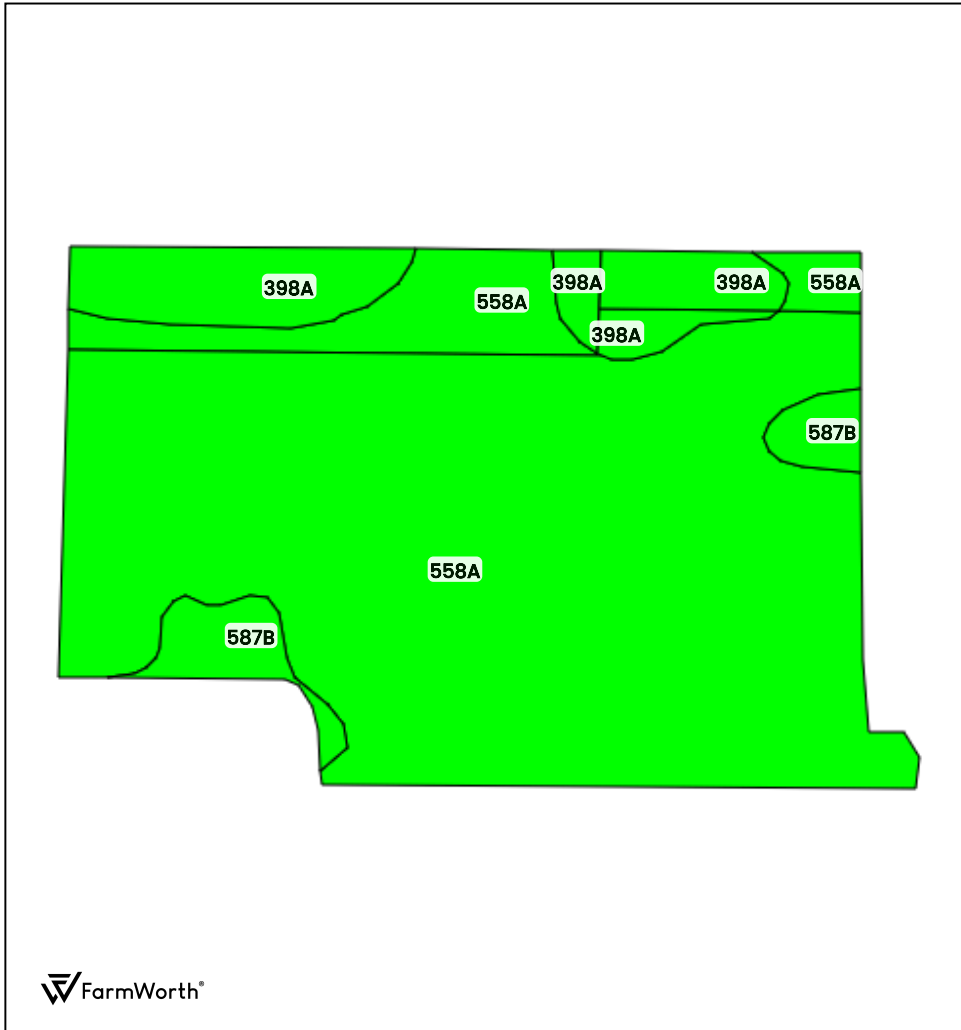

County: **Juneau County, WI**  
 Location: **28-17N-3E**  
 Township: **Clearfield**  
 Acres: **54.94**  
 Date: **03/25/2026**



FarmWorth, LLC makes no warranties, express or implied, regarding the accuracy of any information provided through FarmWorth.com. User is solely responsible for independently verifying all information prior to use and waives any claims against FarmWorth, LLC arising from inaccuracies in such information.

| Code            | Description                                       | Acres | % of field | Overall NCCPI | Soil Class (Non-Irr) | Drainage Class          |
|-----------------|---|-------|------------|---------------|----------------------|-------------------------|
| 558A            | Wyeville loamy sand, 0 to 3 percent slopes        | 46.62 | 84.86 %    | 51            | 3                    | Somewhat poorly drained |
| 398A            | Neenah silt loam, 0 to 3 percent slopes           | 5.90  | 10.74 %    | 62            | 2                    | Somewhat poorly drained |
| 587B            | Tintson sand, lake terrace, 1 to 6 percent slopes | 2.42  | 4.40 %     | 34            | 3                    | Moderately well drained |
| <b>Average:</b> |   |       |            | <b>51.4</b>   |                      |                         |

Soils data provided by USDA and NRCS.