

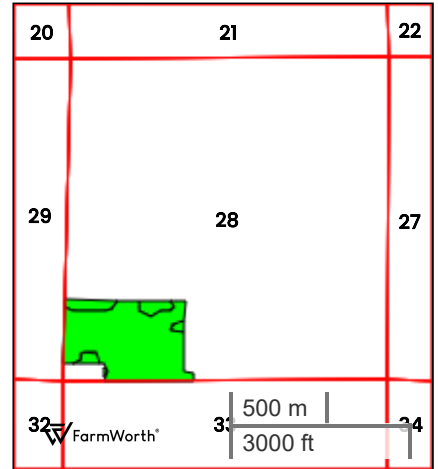

TRACT 13  
TOTAL SOILS

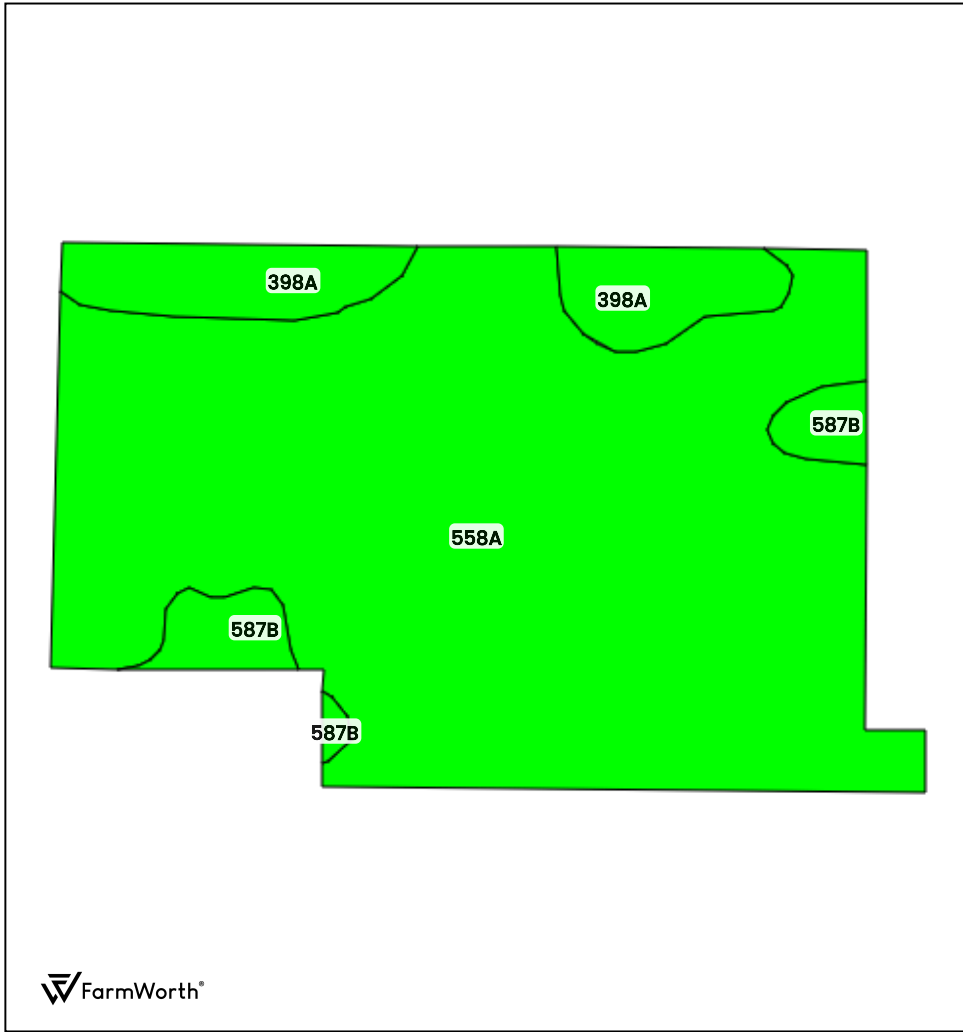

County: **Juneau County, WI**  
 Location: **28-17N-3E**  
 Township: **Clearfield**  
 Acres: **55.93**  
 Date: **03/25/2026**



FarmWorth, LLC makes no warranties, express or implied, regarding the accuracy of any information provided through FarmWorth.com. User is solely responsible for independently verifying all information prior to use and waives any claims against FarmWorth, LLC arising from inaccuracies in such information.

Code	Description	Acres	% of field	Overall NCCPI	Soil Class (Non-Irr)	Drainage Class
558A	Wyeville loamy sand, 0 to 3 percent slopes	47.92	85.68 %	51	3	Somewhat poorly drained
398A	Neenah silt loam, 0 to 3 percent slopes	5.64	10.08 %	62	2	Somewhat poorly drained
587B	Tintson sand, lake terrace, 1 to 6 percent slopes	2.37	4.24 %	34	3	Moderately well drained
<b>Average:</b>				<b>51.4</b>		

Soils data provided by USDA and NRCS.