

# Soils Map

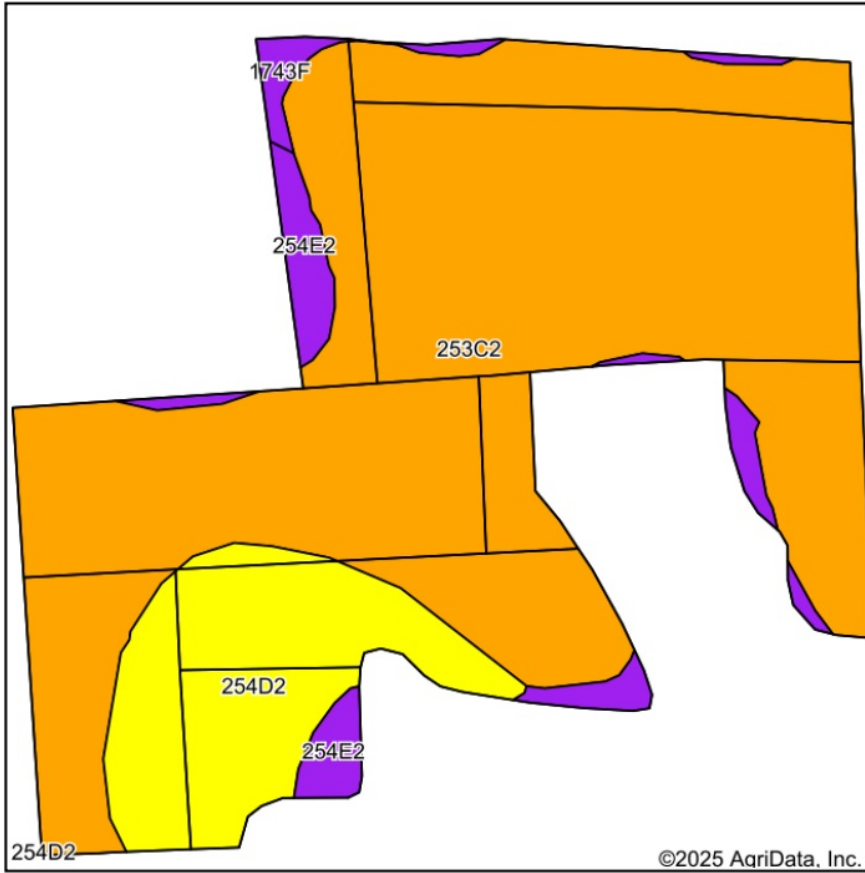

Soils data provided by USDA and NRCS.

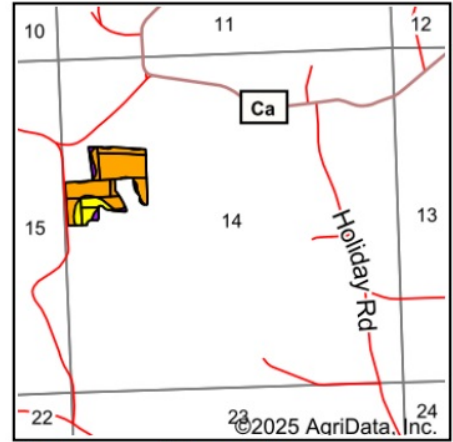

State: **Wisconsin**  
 County: **Monroe**  
 Location: **14-17N-1W**  
 Township: **Tomah**  
 Acres: **23.26**  
 Date: **5/27/2025**

Maps Provided By:



Area Symbol: WI081, Soil Area Version: 20

Code	Soil Description	Acres	Percent of field	Non-Irr Class Legend	Non-Irr Class *c	Alfalfa hay Tons	Bluegrass white clover Tons	Corn Bu	Corn silage Tons	Oats Bu	Orchardgrass alsike Tons	Orchardgrass red clover Tons	Red clover hay Tons	Soybeans Bu	Timothy alsike Tons	*r N O
253C2	Greenridge silt loam, 4 to 12 percent slopes, moderately eroded	18.09	77.7%		IIIe	5	3.6	125	18	75	4.4	4.6	4	44	4.2	
254D2	Norden silt loam, 12 to 20 percent slopes, moderately eroded	3.69	15.9%		IVe											
254E2	Norden silt loam, 20 to 30 percent slopes, moderately eroded	1.18	5.1%		VIe											
1743F	Council-Elevasil-Norden complex, 20 to 45 percent slopes, rocky	0.30	1.3%		VIIIs											
Weighted Average					3.36	3.9	2.8	97.2	14	58.3	3.4	3.6	3.1	34.2	3.3	

\*n: The aggregation method is "Weighted Average using all components"

\*c: Using Capabilities Class Dominant Condition Aggregation Method

Soils data provided by USDA and NRCS.