

Soils Map

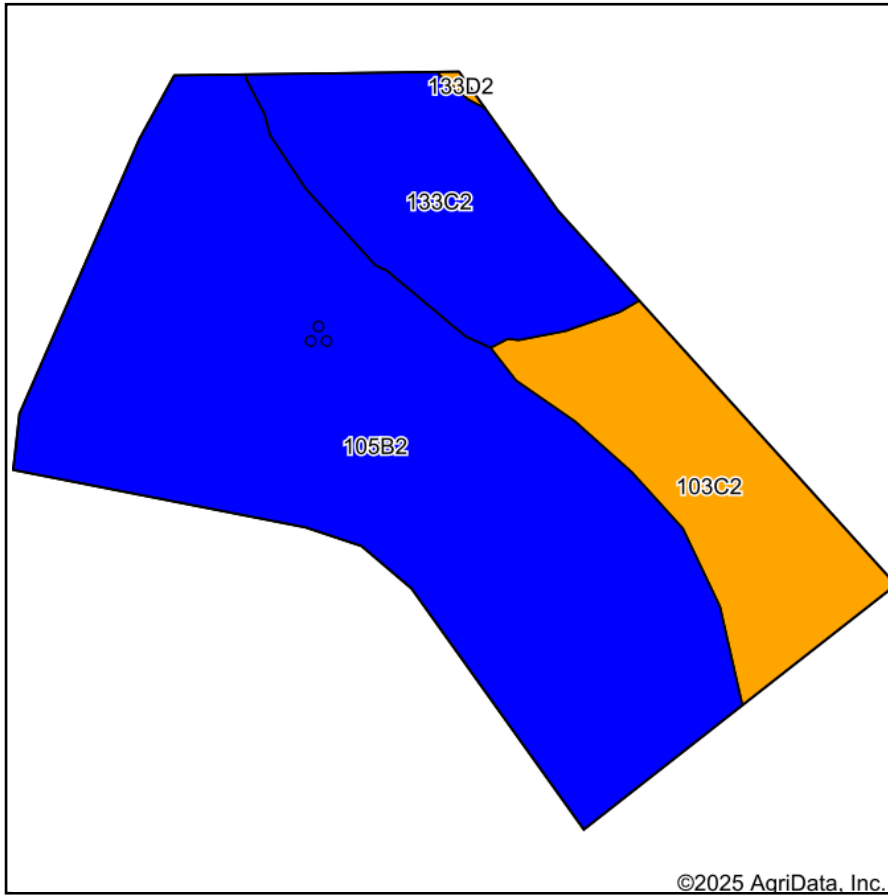

Soils data provided by USDA and NRCS.

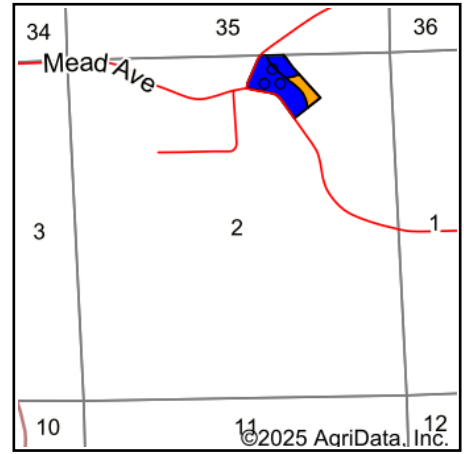

State: **Wisconsin**
 County: **Monroe**
 Location: **2-15N-2W**
 Township: **Sheldon**
 Acres: **14.06**
 Date: **8/27/2025**

Maps Provided By:

 CUSTOMIZED ONLINE MAPPING
 © AgriData, Inc. 2023 www.AgriDataInc.com



Area Symbol: WI081, Soil Area Version: 20

Code	Soil Description	Acres	Percent of field	Non-Irr Class Legend	Restrictive Layer	Soil Drainage	Non-Irr Class *c	*n NCCPI Overall
105B2	Wildale silt loam, 2 to 6 percent slopes, moderately eroded	9.33	66.4%		1.2ft. (Abrupt textural change)	Well drained	Ile	54
133C2	Valton silt loam, 6 to 12 percent slopes, moderately eroded	2.39	17.0%		> 6.5ft.	Well drained	Ile	70
103C2	Wildale channery silt loam, 6 to 12 percent slopes, moderately eroded	2.34	16.6%		1.2ft. (Abrupt textural change)	Well drained	IIIle	51
Weighted Average							2.17	*n 56.2

*n: The aggregation method is "Weighted Average using all components"

*c: Using Capabilities Class Dominant Condition Aggregation Method

	Symbol	Name	Description
	GRA	Gravelly spot	An area where the surface texture is gravelly (15% coarse fragments or more) and the surrounding map unit surface layer texture is non-gravelly (15% coarse fragments). Typically 0.25 to 3 acres.

Soils data provided by USDA and NRCS.