

Soils Map

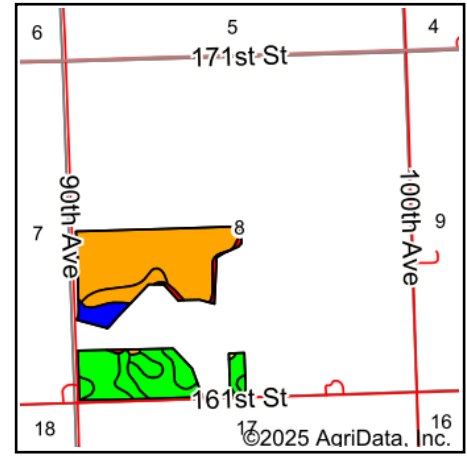
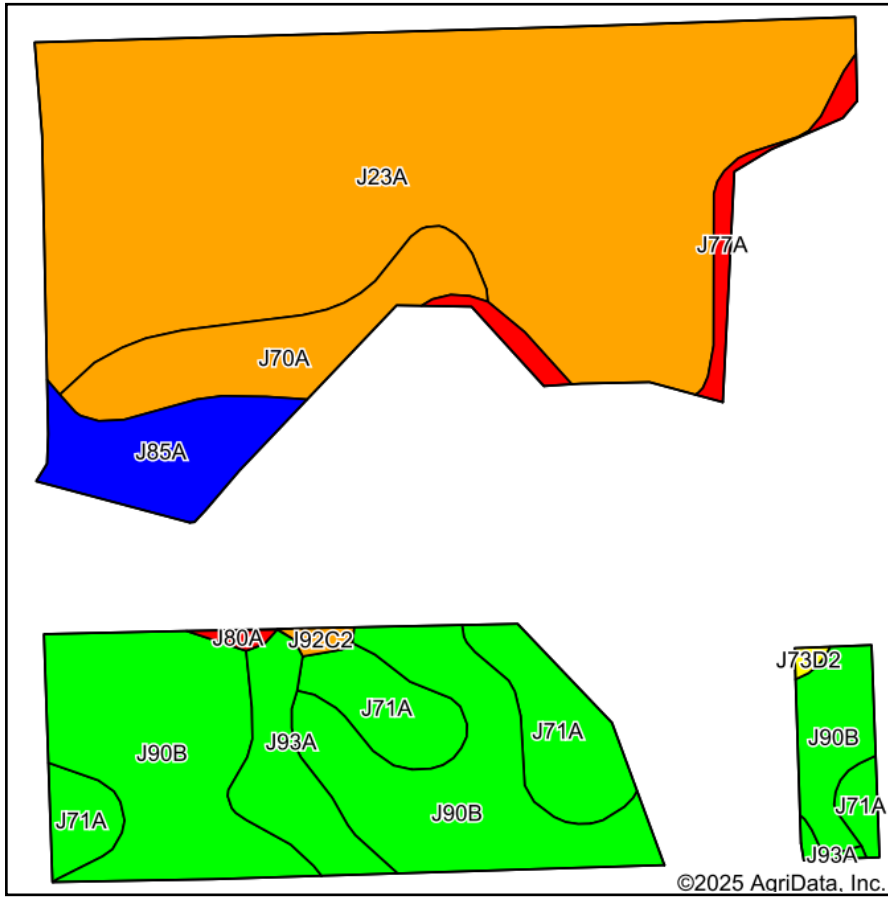

State: **Minnesota**
 County: **Pipestone**
 Location: **8-107N-45W**
 Township: **Grange**
 Acres: **95.17**
 Date: **6/3/2025**

Maps Provided By:

 CUSTOMIZED ONLINE MAPPING
 © AgriData, Inc. 2023 www.AgriDataInc.com



Area Symbol: MN117, Soil Area Version: 24

Code	Soil Description	Acres	Percent of field	PI Legend	Non-Irr Class *c	Productivity Index
J23A	Lamoure silty clay loam, 0 to 2 percent slopes, occasionally flooded	48.08	50.5%		IIw	78
J90B	Kranzburg-Brookings silty clay loams, 1 to 6 percent slopes	21.79	22.9%		IIe	93
J71A	Brookings silty clay loam, 0 to 2 percent slopes	8.46	8.9%		Iw	98
J70A	Brandt silty clay loam, 0 to 2 percent slopes	6.09	6.4%		Is	80
J85A	Trosky silty clay loam, 0 to 2 percent slopes	4.66	4.9%		IIw	83
J93A	Hidewood-Badger complex, 0 to 2 percent slopes	3.53	3.7%		IIw	92
J77A	Lamoure silty clay loam, 0 to 2 percent slopes, frequently flooded	1.83	1.9%		Vw	20
J92C2	Buse-Vienna complex, 6 to 12 percent slopes, moderately eroded	0.33	0.3%		IIIe	76
J80A	Lamoure-La Prairie complex, channeled, 0 to 2 percent slopes, frequently flooded	0.24	0.3%		Vw	20
J73D2	Buse clay loam, 12 to 18 percent slopes, moderately eroded	0.16	0.2%		IVe	63
Weighted Average					1.92	82.8

*c: Using Capabilities Class Dominant Condition Aggregation Method