

Soils Map

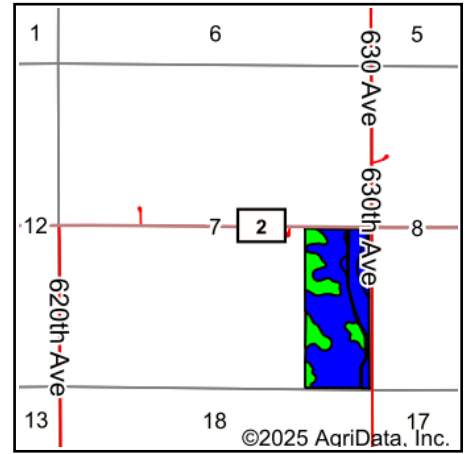
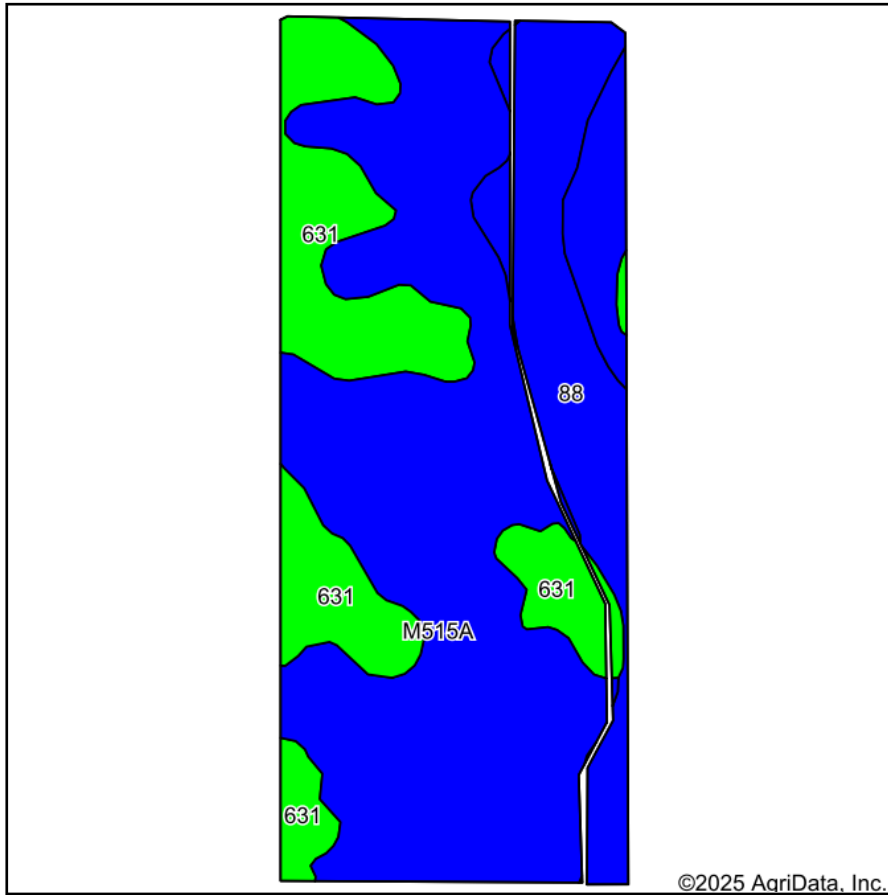

State: **Minnesota**
 County: **Mower**
 Location: **7-103N-16W**
 Township: **Dexter**
 Acres: **62.1**
 Date: **9/5/2025**

Maps Provided By:

 CUSTOMIZED ONLINE MAPPING
 © AgriData, Inc. 2023 www.AgriDataInc.com



Area Symbol: MN099, Soil Area Version: 20

Code	Soil Description	Acres	Percent of field	PI Legend	Restrictive Layer	Soil Drainage	Non-Irr Class *c	Productivity Index	*n NCCPI Overall
M515A	Tripoli clay loam, 0 to 2 percent slopes	37.18	59.8%		> 6.5ft.	Poorly drained	IIw	87	68
631	Oran silt loam, 1 to 4 percent slopes	14.20	22.9%		> 6.5ft.	Somewhat poorly drained	Iw	95	79
88	Clyde silty clay loam, 0 to 3 percent slopes	10.72	17.3%		> 6.5ft.	Poorly drained	IIw	86	90
Weighted Average							1.77	88.7	*n 74.3

*n: The aggregation method is "Weighted Average using all components"

*c: Using Capabilities Class Dominant Condition Aggregation Method