

Soils Map

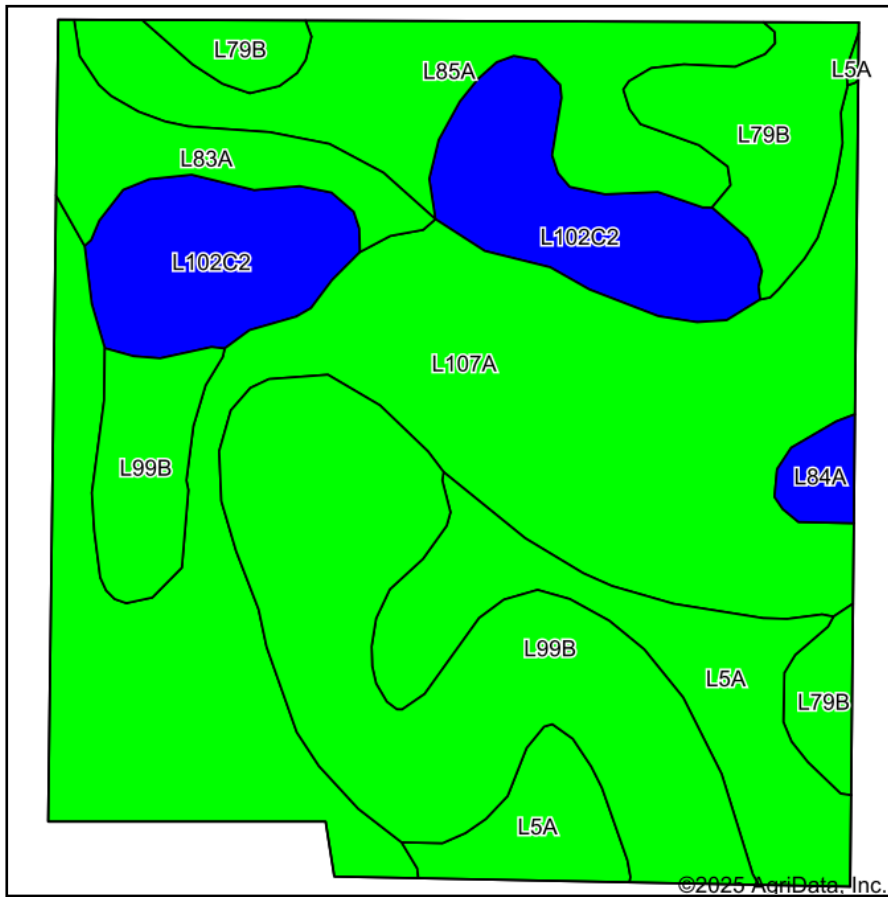

Soils data provided by USDA and NRCS.

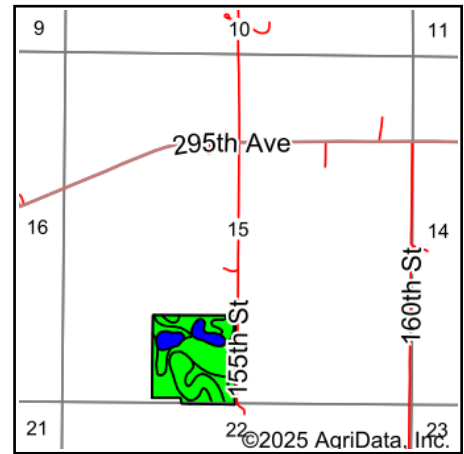

State: **Minnesota**
 County: **Waseca**
 Location: **15-106N-22W**
 Township: **Otisco**
 Acres: **38.02**
 Date: **9/5/2025**

Maps Provided By:

 CUSTOMIZED ONLINE MAPPING
 © AgriData, Inc. 2023 www.AgriDataInc.com



Area Symbol: MN161, Soil Area Version: 19									
Code	Soil Description	Acres	Percent of field	PI Legend	Restrictive Layer	Soil Drainage	Non-Irr Class *c	Productivity Index	*n NCCPI Overall
L107A	Canisteo-Glencoe complex, 0 to 2 percent slopes	13.03	34.3%		> 6.5ft.	Poorly drained	IIw	91	81
L99B	Clarion-Swanlake complex, 2 to 6 percent slopes	8.01	21.1%		> 6.5ft.	Moderately well drained	Ile	92	82
L102C2	Clarion-Storden complex, 6 to 10 percent slopes, moderately eroded	4.50	11.8%		> 6.5ft.	Well drained	IIIle	87	71
L5A	Delft, overwash-Delft complex, 1 to 4 percent slopes	4.14	10.9%		> 6.5ft.	Poorly drained	IIw	96	85
L85A	Nicollet clay loam, 1 to 3 percent slopes	3.65	9.6%		> 6.5ft.	Somewhat poorly drained	Iw	99	81
L79B	Clarion loam, 2 to 6 percent slopes	2.79	7.3%		> 6.5ft.	Moderately well drained	Ile	95	83
L83A	Webster clay loam, 0 to 2 percent slopes	1.53	4.0%		> 6.5ft.	Poorly drained	IIw	93	83
L84A	Glencoe clay loam, 0 to 1 percent slopes	0.37	1.0%		> 6.5ft.	Very poorly drained	IIIw	86	77
Weighted Average							2.03	92.4	*n 80.7

*n: The aggregation method is "Weighted Average using all components"

*c: Using Capabilities Class Dominant Condition Aggregation Method

Soils data provided by USDA and NRCS.