

Soils Map

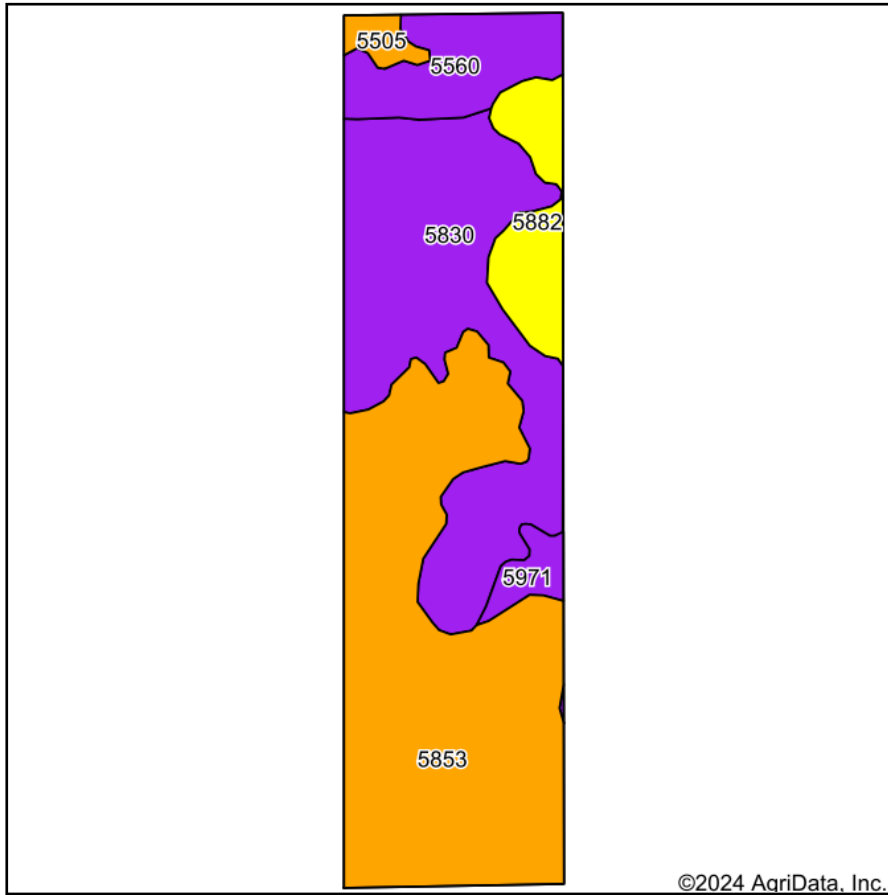

Soils data provided by USDA and NRCS.

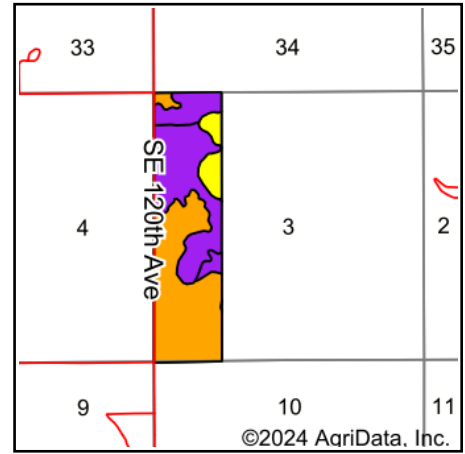

State: **Kansas**
 County: **Stafford**
 Location: **3-25S-11W**
 Township: **York**
 Acres: **161.07**
 Date: **6/12/2024**



Maps Provided By:



Area Symbol: KS185, Soil Area Version: 20

Code	Soil Description	Acres	Percent of field	Non-Irr Class Legend	Non-Irr Class	Irr Class	*n NCCPI Corn	*n NCCPI Small Grains	*n NCCPI Soybeans
5853	Albion sandy loam, 1 to 3 percent slopes	75.45	46.8%		IIIe	IIIe	42	41	39
5830	Ninnescah fine sandy loam, occasionally flooded	53.15	33.0%		Vw		29	27	37
5560	Kanza-Ninnescah sandy loams, frequently flooded	14.48	9.0%		Vw		26	25	28
5882	Dillhut-Plev complex, 0 to 2 percent slopes	11.85	7.4%		IVw	IIIe	30	30	26
5971	Tivin fine sand, 10 to 30 percent slopes	3.59	2.2%		Vle		17	19	16
5505	Abbyville-Kisiwa complex, occasionally flooded	2.55	1.6%		IIIIs	IIIIs	10	19	16
Weighted Average					3.98	*-	*n 34.3	*n 33.3	*n 35.5

*n: The aggregation method is "Weighted Average using all components"

*- Irr Class weighted average cannot be calculated on the current soils data due to missing data.