

Soils Map

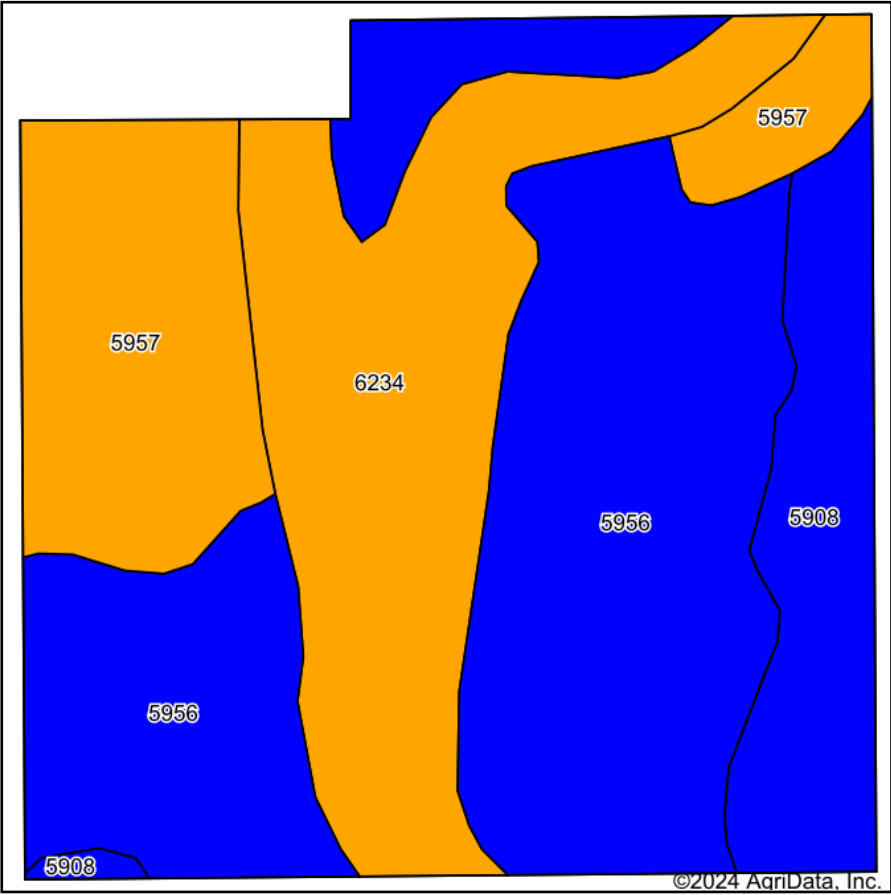

Soils data provided by USDA and NRCS.

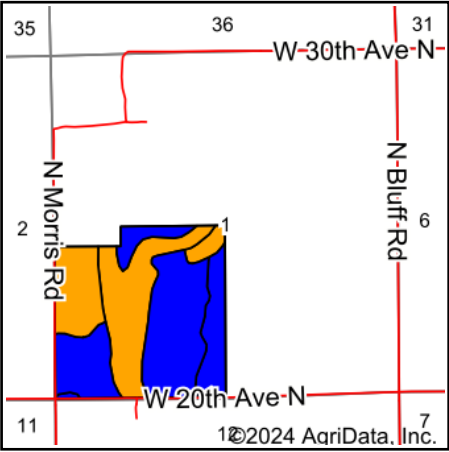

State: **Kansas**
 County: **Sumner**
 Location: **1-32S-4W**
 Township: **Dixon**
 Acres: **152.19**
 Date: **3/30/2024**



Maps Provided By:



Area Symbol: KS191, Soil Area Version: 20

Code	Soil Description	Acres	Percent of field	Non-Irr Class Legend	Non-Irr Class	Irr Class	Alfalfa hay Tons	Alfalfa hay Irrigated Tons	Corn Bu	Corn Irrigated Bu	Grain sorghum Bu	Grain sorghum Irrigated Bu	Smooth bromegrass AUM	Smooth bromegrass Irrigated AUM	Winter wheat Bu	*n NCC Over
5956	Shellabarger sandy loam, 1 to 3 percent slopes	69.42	45.6%		Ile	Ile										
6234	Crisfield sandy loam, rarely flooded	38.81	25.5%		IIIs		3				45				23	
5957	Shellabarger sandy loam, 3 to 6 percent slopes	26.22	17.2%		IIIe		2	6	54	139	45	104	5	9	32	
5908	Nalim loam, 0 to 1 percent slopes	17.74	11.7%		IIc	I										
Weighted Average					2.43	*-	1.1	1	9.3	23.9	19.2	17.9	0.9	1.6	11.4	*n

*n: The aggregation method is "Weighted Average using all components"

*- Irr Class weighted average cannot be calculated on the current soils data due to missing data.