

Soils Map

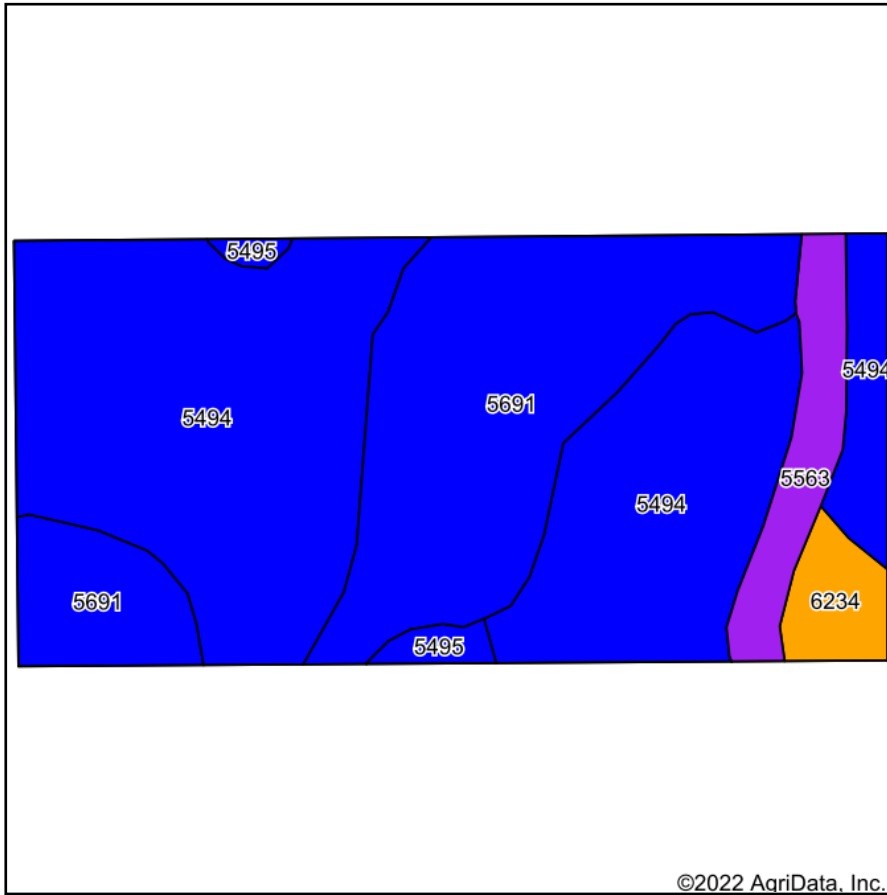

Soils data provided by USDA and NRCS.

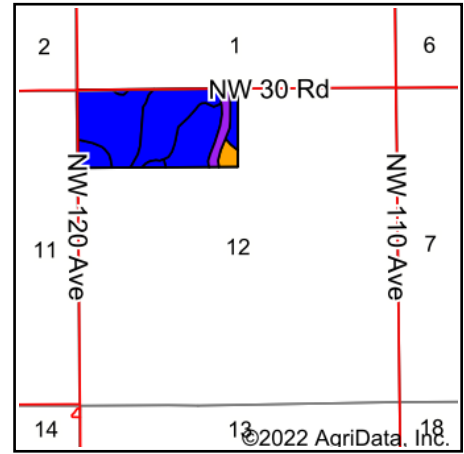

State: **Kansas**
 County: **Harper**
 Location: **12-33S-9W**
 Township: **Township No. 1**
 Acres: **80.98**
 Date: **4/4/2022**



Maps Provided By:



Area Symbol: KS077, Soil Area Version: 18

Code	Soil Description	Acres	Percent of field	Non-Irr Class Legend	Non-Irr Class *c	*n NCCPI Overall	*n NCCPI Corn	*n NCCPI Small Grains	*n NCCPI Soybeans
5494	Woodward-Quinlan loams, 0 to 1 percent slopes	45.52	56.2%		Ile	22	22	20	22
5691	Zenda fine sandy loam, occasionally flooded	26.93	33.3%		Ilw	61	47	41	61
5563	Kingman clay loam, occasionally flooded	4.64	5.7%		Vw	52	38	34	52
6234	Crisfield sandy loam, rarely flooded	2.64	3.3%		Ills	37	37	34	32
5495	Woodward-Quinlan loams, 1 to 3 percent slopes	1.25	1.5%		Ile	22	22	20	22
Weighted Average					2.20	*n 37.2	*n 31.7	*n 28.2	*n 37

*n: The aggregation method is "Weighted Average using all components"

*c: Using Capabilities Class Dominant Condition Aggregation Method

Soils data provided by USDA and NRCS.