

# Soils Map

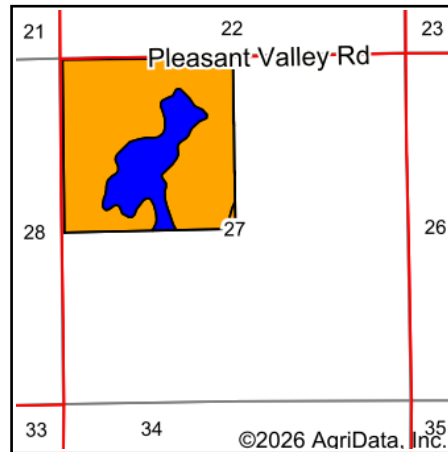

State: **Kansas**  
 County: **Reno**  
 Location: **27-25S-5W**  
 Township: **Haven**  
 Acres: **159.01**  
 Date: **3/30/2026**

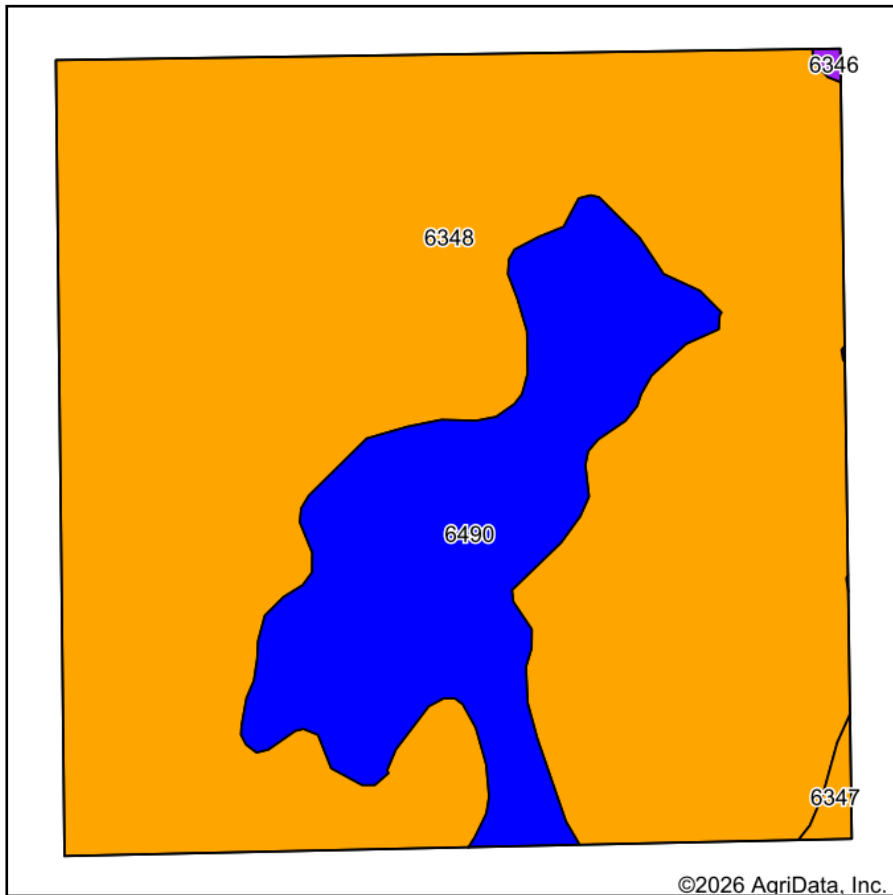

Maps Provided By:



Soils data provided by USDA and NRCS.

©2026 AgriData, Inc.

© AgriData, Inc. 2025

www.AgriDataInc.com

Area Symbol: KS155, Soil Area Version: 22

Code	Soil Description	Acres	Percent of field	Non-Irr Class Legend	Non-Irr Class	Irr Class	*n NCCPI Overall
6348	Jamash-Piedmont clay loams, 1 to 3 percent slopes	127.27	80.0%		III s	III s	35
6490	Zellmont and Poxmash sandy loams, 0 to 3 percent slopes	30.78	19.4%		Ile	Ile	47
6347	Jamash-Piedmont clay loams, 0 to 1 percent slopes	0.77	0.5%		III s	III s	36
6346	Jamash clay loam, 0 to 8 percent slopes	0.19	0.1%		VI s		32
<b>Weighted Average</b>					<b>2.81</b>	<b>*-</b>	<b>*n 37.3</b>

\*n: The aggregation method is "Weighted Average using all components"

\*- Irr Class weighted average cannot be calculated on the current soils data due to missing data.