

Soils Map

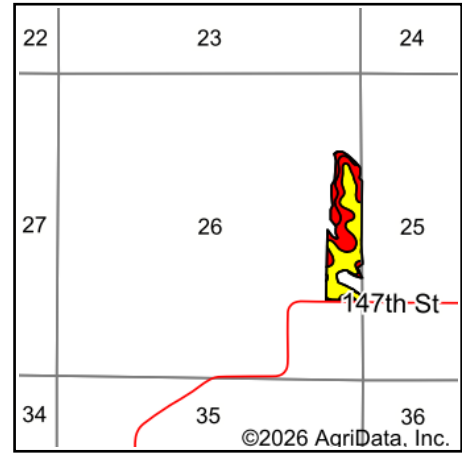

State: **Iowa**
 County: **Monroe**
 Location: **26-73N-19W**
 Township: **Cedar**
 Acres: **28.38**
 Date: **6/12/2026**

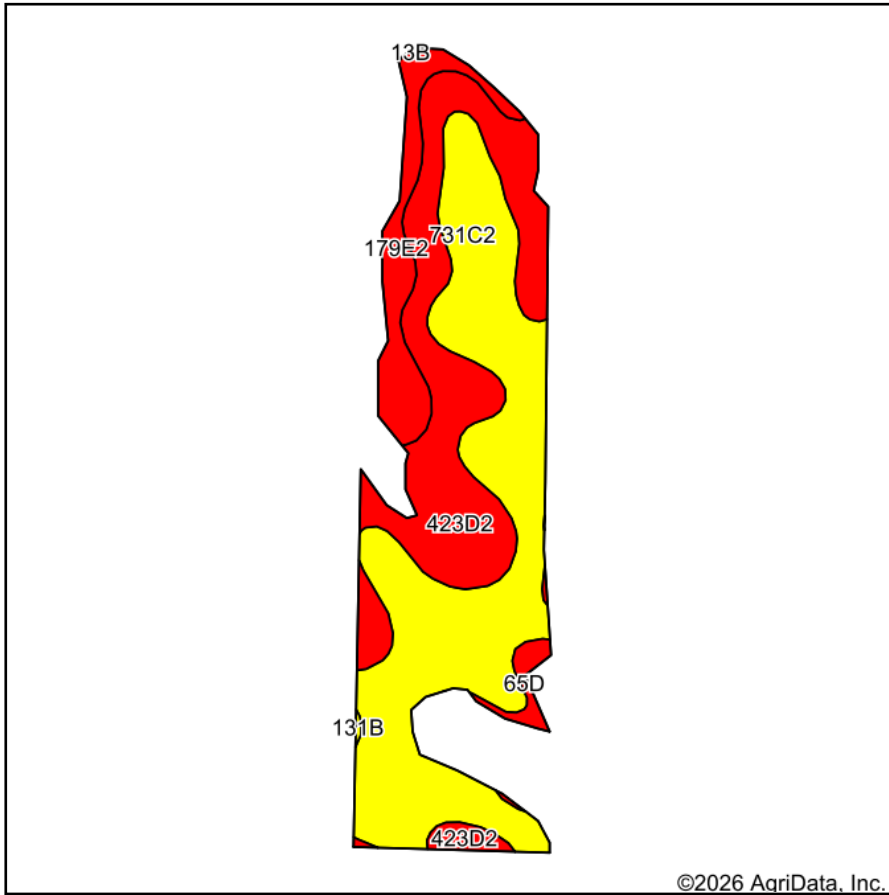

Soils data provided by USDA and NRCS.

Area Symbol: IA135, Soil Area Version: 33

Code	Soil Description	Acres	Percent of field	CSR2 Legend	Restrictive Layer	Soil Drainage	Non-Irr Class *c	*i Corn Bu	*i Alfalfa Tons	*i Soybeans Bu	*i Bluegrass Tons	*i Tall Grasses Tons	*i Water-Holding Inch	CSR2**	CSR	*n NCC Over	
731C2	Pershing silty clay loam, 5 to 9 percent slopes, moderately eroded	15.45	54.5%	Yellow	> 6.5ft.	Somewhat poorly drained	IIIe	80.0	2.1	23.2	1.4	2.4	11.8	62	45		
423D2	Bucknell silty clay loam, 9 to 14 percent slopes, moderately eroded	9.68	34.1%	Red	0.7ft. (Abrupt textural change)	Somewhat poorly drained	IVe	97.6	2.5	28.3	1.8	2.9	9.4	6	13		
179E2	Gara loam, 14 to 18 percent slopes, moderately eroded	2.71	9.5%	Red	> 6.5ft.	Well drained	VIe	139.2	3.9	40.4	2.5	4.2	10.7	26	33		
65D	Lindley loam, 9 to 14 percent slopes	0.54	1.9%	Red	> 6.5ft.	Well drained	IVe	163.2	4.6	47.3	2.9	4.9	9.4	43	40		
Weighted Average								3.65	93.2	2.5	27	1.7	2.8	10.8	39.1	32.8	*n

**IA has updated the CSR values for each county to CSR2.

*i Yield data provided by the ISPAID Database version 8.1.1 developed by IA State University.

*n: The aggregation method is "Weighted Average using all components"

*c: Using Capabilities Class Dominant Condition Aggregation Method

Soils data provided by USDA and NRCS.