

Soils Map

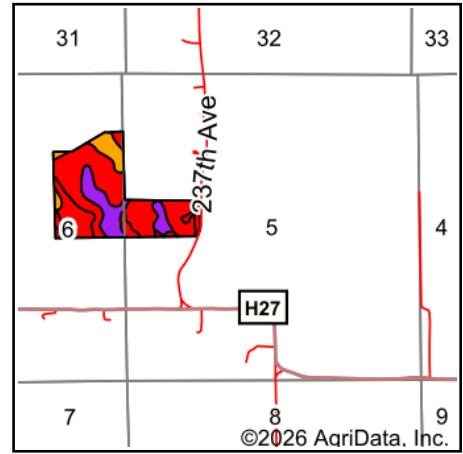

State: **Iowa**
 County: **Wapello**
 Location: **5-72N-15W**
 Township: **Polk**
 Acres: **72.18**
 Date: **4/30/2026**

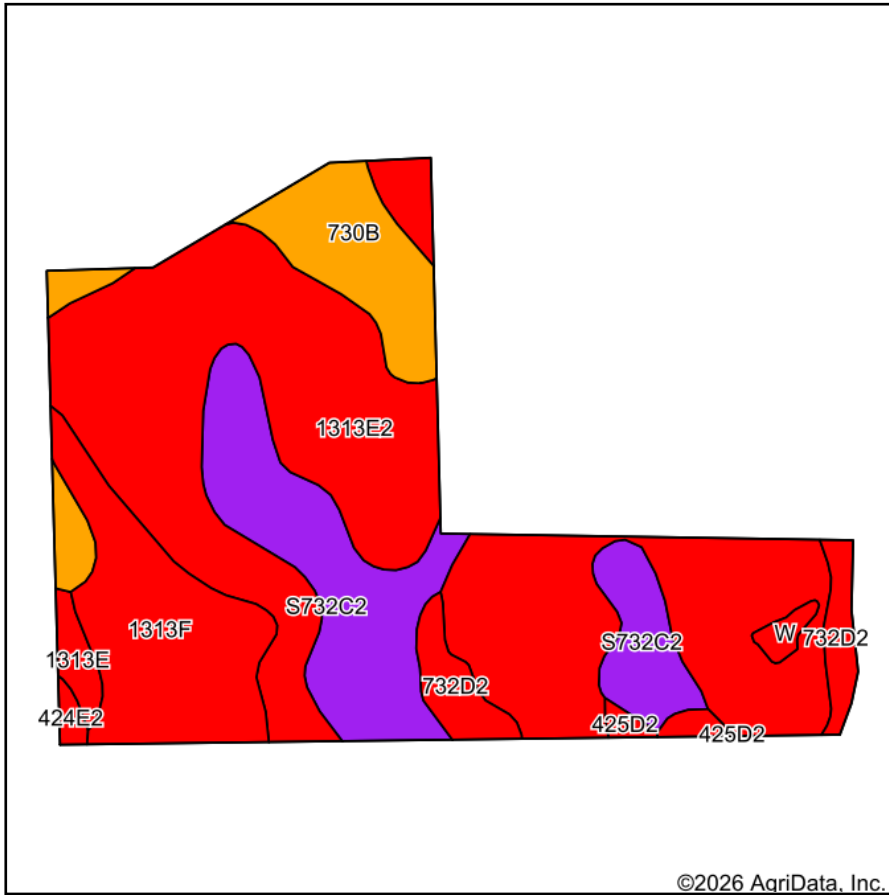

Soils data provided by USDA and NRCS.

Area Symbol: IA179, Soil Area Version: 34

Code	Soil Description	Acres	Percent of field	CSR2 Legend	Restrictive Layer	Soil Drainage	Non-Irr Class *c	*j Corn Bu	*j Alfalfa Tons	*j Soybeans Bu	*j Bluegrass Tons	*j Tall Grasses Tons	*j Water-Holding Inch	CSR2**	CSR	*N C
1313E2	Munterville silt loam, 9 to 18 percent slopes, moderately eroded	38.37	53.0%		6.2ft. (Paralithic bedrock)	Moderately well drained	Vle	80.0	2.2	23.2	1.4	2.4	0.0	22	5	
S732C2	Weller silty clay loam, 5 to 9 percent slopes, moderately eroded	12.75	17.7%		> 6.5ft.	Moderately well drained	Ille	0.0	0.0	0.0	0.0	0.0	0.0	59		
1313F	Munterville silt loam, 18 to 40 percent slopes	9.08	12.6%		6.2ft. (Paralithic bedrock)	Moderately well drained	Vlle	80.0	2.2	23.2	1.4	2.4	0.0	5	5	
730B	Nodaway-Cantril complex, 2 to 5 percent slopes	6.65	9.2%		> 6.5ft.	Moderately well drained	Ilw	209.6	5.4	60.8	3.8	6.3	11.4	80	63	

Soils data provided by USDA and NRCS.



Code	Soil Description	Acres	Percent of field	CSR2 Legend	Restrictive Layer	Soil Drainage	Non-Irr Class *c	*i Corn Bu	*i Alfalfa Tons	*i Soybeans Bu	*i Bluegrass Tons	*i Tall Grasses Tons	*i Water-Holding Inch	CSR2**	CSR	*n	
732D2	Weller silty clay loam, 9 to 14 percent slopes, moderately eroded	3.30	4.6%		> 6.5ft.	Moderately well drained	Ive	80.0	2.2	23.2	1.4	2.4	10.6	34	15		
1313E	Munterville silt loam, 9 to 18 percent slopes	0.91	1.3%		6.2ft. (Paralithic bedrock)	Moderately well drained	Vlle	80.0	2.2	23.2	1.4	2.4	0.0	30	10		
W	Water	0.47	0.7%		> 6.5ft.			0.0	0.0	0.0	0.0	0.0	0.0	0	0		
424E2	Lindley-Keswick loams, 14 to 18 percent slopes, moderately eroded	0.35	0.5%		0.8ft. (Abrupt textural change)	Well drained	Vle	108.8	3.0	31.6	2.0	3.3	9.0	24	5		
425D2	Keswick loam, 9 to 14 percent slopes, moderately eroded	0.30	0.4%		0.8ft. (Abrupt textural change)	Somewhat poorly drained	Ive	88.0	2.5	25.5	1.6	2.6	8.8	9	5		
Weighted Average								*-	77.5	2.1	22.5	1.4	2.3	1.6	32.2	*-	

**IA has updated the CSR values for each county to CSR2.

*- CSR weighted average cannot be calculated on the current soils data, use prior data version for csr values.*i Yield data provided by the ISPAID Database version 8.1.1 developed by IA State University.

*n: The aggregation method is "Weighted Average using all components"

*c: Using Capabilities Class Dominant Condition Aggregation Method

*- Non Irr Class weighted average cannot be calculated on the current soils data due to missing data.