

GRID NORTH PER GPS OBSERVATION
MISSOURI EAST ZONE
SEC. 17 T32N R3W 5TH PM

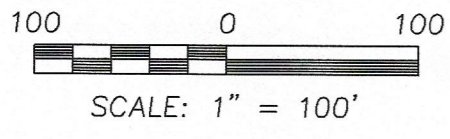

LEGEND

- - Set 1/2" IP. (LS-2014000195)
- - Find Iron Pin / Pipe
- ◆ - Find Aluminum Monument
- ◇ - Find Conc. Monument
- ⊕ - Fence Corner

LINE TABLE

| LINE | BEARING | DISTANCE |
|------|---------------|----------|
| L1 | N 08°43'52" W | 59.51' |
| L2 | N 16°35'06" W | 15.55' |
| L3 | N 18°05'06" W | 156.34' |
| L4 | N 05°48'32" W | 90.34' |
| L5 | N 05°48'32" W | 104.33' |
| L6 | N 08°43'52" W | 67.19' |

CURVE TABLE

| CURVE | RADIUS | ARC LENGTH | CHORD LENGTH | CHORD BEARING |
|-------|---------|------------|--------------|---------------|
| C1 | 271.72' | 76.05' | 75.80' | N 00°41'12" W |
| C2 | 526.70' | 136.04' | 135.66' | N 00°00'53" W |
| C3 | 658.34' | 158.69' | 158.30' | N 11°10'35" W |
| C4 | 698.34' | 168.33' | 167.92' | N 11°10'35" W |
| C5 | 566.70' | 145.80' | 145.40' | N 00°00'51" E |
| C6 | 231.72' | 64.83' | 64.62' | N 00°41'16" W |

Tract 1 Description:

A Part of the West 1/2 of the SE 1/4 of Section 17, Township 32 North, Range 3 West, of the 5th P.M., Dent County, Missouri, described as follows: Commencing at the SE corner of the West 1/2 of the SE 1/4 of Section 17, Thence, N 00°12'08" E 1090.79 feet, along the East line of the West 1/2 of the SE 1/4 of Section 17 to an iron pin and the point of beginning, Thence, leaving the said East line, N 85°34'00" W 908.93 feet to an iron pin on the East Right of Way of Dent County Road 5615, Thence, along the said East Right of Way, N 16°35'06" W 911 feet, Thence, N 15°40'15" W 467.19 feet to an iron pin, Thence, leaving the said East Right of Way, S 85°34'00" E 1039.70 feet to an iron pin on the East line of the SE 1/4 of Section 17, Thence, S 00°12'08" W 448.45 feet, along the said East line, to the point of beginning. Bearings based on Grid North. Description per Survey M-2411, dated April 2, 2026, by Michelle Elwood, PLS. Containing 10.00 acres, more or less.

Tract 2 Description:

A Part of the West 1/2 of the SE 1/4 of Section 17, Township 32 North, Range 3 West, of the 5th P.M., Dent County, Missouri, described as follows: Commencing at the SE corner of the West 1/2 of the SE 1/4 of Section 17, Thence, N 00°12'08" E 481.49 feet, along the East line of the West 1/2 of the SE 1/4 of Section 17 to an iron pin and the point of beginning, Thence, leaving the said East line, N 85°34'00" W 720.41 feet to an iron pin on the East Right of Way of Dent County Road 5615, Thence, along the said East Right of Way, N 16°35'06" W 650.95 feet to an iron pin, Thence, leaving the said East Right of Way, S 85°34'00" E 908.93 feet to an iron pin on the East line of the West 1/2 of the SE 1/4 of Section 17, Thence, S 00°12'08" W 609.30 feet, along the said East line, to the point of beginning. Bearings based on Grid North. Description per Survey M-2411, dated April 2, 2026, by Michelle Elwood, PLS. Containing 11.37 acres, more or less.

Tract 3 Description:

A Part of the SW 1/4 of the SE 1/4 of Section 17 and part of the NW 1/4 of the NE 1/4 of Section 20, Township 32 North, Range 3 West, of the 5th P.M., Dent County, Missouri, described as follows: Beginning at the SE corner of the West 1/2 of the SE 1/4 of Section 17, Thence, S 01°11'33" W 524.1 feet, along the East line of the NE 1/4 of Section 20 to an iron pin, Thence, leaving the said East line, S 59°06'03" W 354.04 feet to a fence corner, Thence, N 55°53'10" W 58.51 feet to a fence corner, Thence, N 74°59'40" W 185.10 feet to an iron pin on the East Right of Way of Dent County Road 5615, Thence, along the said East Right of Way, N 05°48'32" W 90.34 feet, Thence, N 07°41'29" W 467.73 feet, Thence, N 04°16'15" W 293.61 feet, Thence, along a curve, 168.33 feet in length, with a radius of 698.34 feet and a chord of N 11°10'35" W 167.92 feet, Thence, N 18°05'06" W 158.69 feet to an iron pin, Thence, leaving the said East Right of Way, S 85°34'00" E 720.41 feet to an iron pin on the East line of the West 1/2 of the SE 1/4 of Section 17, Thence, S 00°12'08" W 481.49 feet, along the said East line, to the point of beginning. Bearings based on Grid North. Description per Survey M-2411, dated April 2, 2026, by Michelle Elwood, PLS. Containing 15.90 acres, more or less.

Tract 4 Description:

A Part of the NW 1/4 of the NE 1/4 of Section 20, Township 32 North, Range 3 West, of the 5th P.M., Dent County, Missouri, described as follows: Beginning at the SE corner of the NW 1/4 of the NE 1/4 of Section 20, Thence, N 87°51'03" W 524.50 feet, along the South line of the NW 1/4 of the NE 1/4 of Section 20 to an iron pin on the East Right of Way of Dent County Road 5615, Thence, along the said East Right of Way, N 08°43'52" W 67.19 feet, Thence, along a curve, 64.83 feet in length, with a radius of 231.72 feet and a chord of N 00°41'16" W 64.62 feet, Thence, N 07°23'04" E 232.02 feet, Thence, along a curve, 145.80 feet in length, with a radius of 566.70 feet and a chord of N 00°00'51" E 145.40 feet, Thence, N 05°48'32" W 104.33 feet to an iron pin, Thence, leaving the said East Right of Way, S 74°59'40" E 185.10 feet to a fence corner, Thence, S 55°53'10" E 58.51 feet to a fence corner, Thence, N 59°06'03" E 354.04 feet to an iron pin on the East line of the NW 1/4 of the NE 1/4 of Section 20, Thence, S 01°11'33" W 731.20 feet, along the said East line, to the point of beginning. Bearings based on Grid North. Description per Survey M-2411, dated April 2, 2026, by Michelle Elwood, PLS. Containing 7.35 acres, more or less.

Tract 5 Description:

A Part of the NW 1/4 of the NE 1/4 of Section 20, Township 32 North, Range 3 West, of the 5th P.M., Dent County, Missouri, described as follows: Beginning at the SW corner of the NW 1/4 of the NE 1/4 of Section 20, Thence, N 00°47'47" E 932.50 feet, along the West line of the NW 1/4 of the NE 1/4 of Section 20 to an iron pin and the point of beginning, Thence, continuing N 00°47'47" E 374.68 feet to an aluminum monument, Thence, N 01°07'24" E 480.98 feet, along the West line of the SW 1/4 of the SE 1/4 of Section 17 to an iron pin, Thence, leaving the said West line, S 85°34'00" E 593.34 feet to an iron pin on the West Right of Way of Dent County Road 5615, Thence, along the said West Right of Way, S 16°35'06" E 155.55 feet, Thence, S 18°04'54" E 157.20 feet, Thence, along a curve, 158.69 feet in length, with a radius of 658.34 feet and a chord of S 11°10'35" E 158.30 feet, Thence, S 04°16'15" E 294.80 feet, Thence, S 07°41'29" E 256.20 feet to an iron pin, Thence, leaving the said West Right of Way, N 85°34'00" W 748.59 feet to the point of beginning. Bearings based on Grid North. Description per Survey M-2411, dated April 2, 2026, by Michelle Elwood, PLS. Containing 16.50 acres, more or less.

Tract 6 Description:

A Part of the SW 1/4 of the SE 1/4 of Section 17 and part of the NW 1/4 of the NE 1/4 of Section 20, Township 32 North, Range 3 West, of the 5th P.M., Dent County, Missouri, described as follows: Commencing at the SW corner of the NW 1/4 of the NE 1/4 of Section 20, Thence, N 00°47'47" E 932.50 feet, along the West line of the NW 1/4 of the NE 1/4 of Section 20 to an iron pin and the point of beginning, Thence, continuing N 00°47'47" E 374.68 feet to an aluminum monument, Thence, N 01°07'24" E 480.98 feet, along the West line of the SW 1/4 of the SE 1/4 of Section 17 to an iron pin, Thence, leaving the said West line, S 85°34'00" E 593.34 feet to an iron pin on the West Right of Way of Dent County Road 5615, Thence, along the said West Right of Way, S 16°35'06" E 155.55 feet, Thence, S 18°04'54" E 157.20 feet, Thence, along a curve, 158.69 feet in length, with a radius of 658.34 feet and a chord of S 11°10'35" E 158.30 feet, Thence, S 04°16'15" E 294.80 feet, Thence, S 07°41'29" E 256.20 feet to an iron pin, Thence, leaving the said West Right of Way, N 85°34'00" W 748.59 feet to the point of beginning. Bearings based on Grid North. Description per Survey M-2411, dated April 2, 2026, by Michelle Elwood, PLS. Containing 13.49 acres, more or less.

NOTES:

1. Except as specifically stated or shown on this plat, this survey does not purport to reflect any of the following which may be applicable to the subject real estate: easements; building setback lines; restrictive covenants; subdivision restrictions; zoning or other land-use regulations; and any other facts which an accurate and current title search may disclose.
2. This survey was executed in accordance with the current Missouri Minimum Standards for Property Boundary Surveys (2 CSR 90-60).
3. Survey classified Rural (2 CSR 90-60.04).
4. Date of field work: March 2024.
5. This plat represents a survey of the Parcels shown. Parcels are parts of land described in Document 2011-2608, Dent County Records, Missouri.

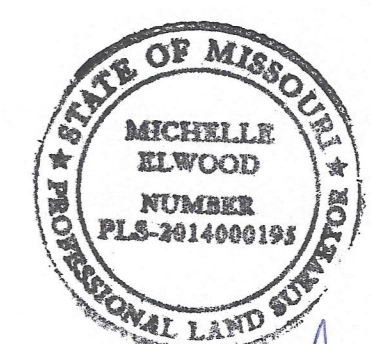

Michelle Elwood
April 2, 2026

SE Cor. NW 1/4,
NE 1/4, Sec 20
Find Conc. Mon. (Dist.)
MLS Doc. 600-01890

SURVEYOR'S DECLARATION

I, Michelle Elwood, Missouri Professional Land Surveyor, No. 2014000195, declare that Russell & Amber Morris have requested a survey to be made under my direct supervision and the results shown on this plat are represented correctly to the best of my professional knowledge.

MO PLS No. 2014000195

| | |
|---------------------------------------------------------------------------------------------------------------------------------------------------------------------------|-----------------------------|
| Michelle L. Elwood, PLS | |
| 1901 South Main Street Salem, Missouri 65560 Phone (573) 453-2881 | |
| Survey Plat | DRAWN BY: BMK |
| Part of the W 1/2 of the SE 1/4 of Section 17 and Part of the NW 1/4 of the NE 1/4 of Section 20 Township 32 North, Range 3 West, 5th P.M. Dent County, Missouri | CHECKED BY: MLE |
| | DATE: April 2, 2026 |
| Russell & Amber Morris Bunker, Missouri | SURVEY NO. M-2411 |

