

# Ohio County, KY PVA

## Summary

**Parcel Number** 121-49  
**Account Number** 29075  
**Location Address** STATE RT 85  
**Description** HOUSE/ LOT  
 (Note: Not to be used on legal documents)  
**Class** Residential  
**Tax District** 00 County

[View Map](#)



## Owners

**Primary Owner**  
 PORTER GEORGE K  
 887 CENTRAL GROVE RD  
 CENTERTOWN, KY 42328

## Valuation

	2026	2025	2024	2023
+ Land Value	\$43,000	\$43,000	\$43,000	\$43,000
+ Improvement Value	\$0	\$0	\$0	\$0
+ Ag Improvement Value	\$0	\$0	\$0	\$0
= Total Taxable Value	\$43,000	\$43,000	\$43,000	\$43,000
- Exemption Value	(\$43,000)	(\$43,000)	\$0	\$0
= Net Taxable Value	\$0	\$0	\$43,000	\$43,000
+ Land FCV	\$0	\$0	\$0	\$0
+ Improvement FCV	\$0	\$0	\$0	\$0
+ Ag Improvement FCV	\$0	\$0	\$0	\$0
= Total FCV	\$0	\$0	\$0	\$0
Exemption	HX	HX		
Farm Acres	0.00	0.00	0.00	0.00
Fire Protection Acres	0.00	0.00	0.00	0.00

## Sales

Sale Date	Sale Price	Sale Type	Book-Page	Grantee	Grantor
4/25/2016	\$0	Close Relative Sale	020-705	PORTER GEORGE K	PORTER GRACE & GLENN

## Taxes

	2025	2024	2023	2022	2021	2020	2019
Tax	\$0.00	\$0.00	\$0.00	\$0.00	\$282.60	\$281.34	\$276.12

## Improvement Information

Building Number	1	Kitchens	0
Description	SINGLE FAMILY	Dining Rooms	0
Residence Type	Single Family	Living Rooms	0
Comm Type		Family Rooms	0
Mobile Home Type		Bedrooms	4
Year Built	1947	Full Baths	2
Effective Age	0	Half Baths	0
Ave. Wall Height	0	Other Rooms	0
Structure	1 1/2 Story	Total Rooms	0
Number of Stories	0	Living Sq Ft	1,912
Exterior	Vinyl	Fireplaces/Water	0/0
Foundation	Concrete Block	Supplemental Heat	Wood
Construction Type		Mobile Home Model	
Construction Quality	Custom	Mobile Home Manufacturer	
Building Condition	Good/Average	MH Skirt Foundation	
Roof Type	Gable	Heat	No
Roof Cover	Comp.Shingles	Heat Source	Bottled Gas
Roof Pitch		Heat Type	Forced Air
Basement Type	None	Air Conditioning	No
Basement Finish		AC/Type	Central
Basement Size		Special Improvements	No
Basement Sq Ft	0	Fire Alarm	No
Garage/Carport	Garage	Sprinklers	No
Garage Size	2 Car	Porch/Deck	None
Garage Type	Detached	Porch Sq Ft	144
Garage Exterior	Other	Deck Sq Ft	0
Width	0	Concrete Sq Ft	0
Length	0	Farm Bldg Type	
Garage Sq Ft	728	Value	\$0.00
Pool	None	Driveway	Paved/Asphalt
Pool Size	0	Fence	0
Tennis Courts	None		

Building Number	2	Kitchens	0
Description		Dining Rooms	0
Residence Type		Living Rooms	0
Comm Type		Family Rooms	0
Mobile Home Type		Bedrooms	0
Year Built	0	Full Baths	0
Effective Age	0	Half Baths	0
Ave. Wall Height	0	Other Rooms	0
Structure		Total Rooms	0
Number of Stories	0	Living Sq Ft	0
Exterior		Fireplaces/Water	0/0
Foundation		Supplemental Heat	
Construction Type		Mobile Home Model	
Construction Quality		Mobile Home Manufacturer	
Building Condition		MH Skirt Foundation	
Roof Type		Heat	No
Roof Cover		Heat Source	
Roof Pitch		Heat Type	
Basement Type		Air Conditioning	No
Basement Finish		AC/Type	
Basement Size		Special Improvements	No
Basement Sq Ft	0	Fire Alarm	No
Garage/Carport		Sprinklers	No
Garage Size		Porch/Deck	
Garage Type		Porch Sq Ft	0
Garage Exterior		Deck Sq Ft	0
Width	0	Concrete Sq Ft	0
Length	0	Farm Bldg Type	
Garage Sq Ft	0	Value	\$0.00
Pool		Driveway	Paved/Asphalt
Pool Size	0	Fence	0
Tennis Courts			

### Land Characteristics

[For more information regarding the Flood Zone in Ohio County \(CLICK HERE\)](#)

Condition	Good	Topography	Level
Plat Book/Page		Drainage	
Subdivision		Flood Hazard	None
Lot		Zoning	
Block		Electric	No
Acres	0.00	Water	Yes
Front	0	Gas	No
Depth	0	Sewer	Yes
Lot Size	0x0	Road	2 Lane
Lot Sq Ft	0	Sidewalks	No
Shape		Information Source	

### Sketches

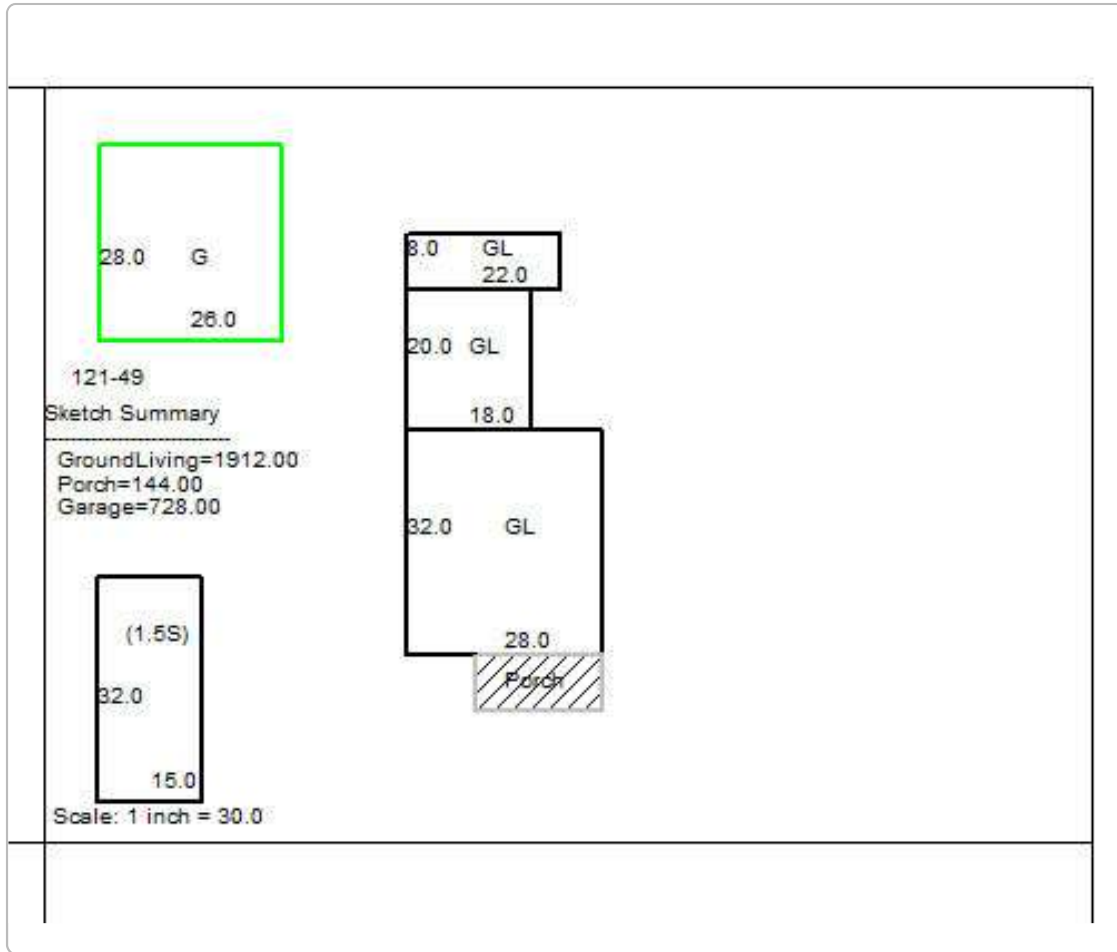

### Recent Sales in Area

**Sale date range:**

From:

To:



**Distance:**

**Units:**

## Map



## Photos



No data available for the following modules: Deeds.

Under Kentucky State Law, these records are public information. Display of this information on the Internet is specifically authorized according to KRS 171.410. If you believe any data provided is inaccurate, or if you have any comments about this site, we would like to hear from you. While the Office of the Property Valuation Administrator has attempted to ensure that the data contained in this file is accurate and reflects the property's characteristics, the PVA makes no warranties, expressed  
| [User Privacy Policy](#) | [GDPR Privacy Notice](#)  
[Last Data Upload: 5/4/2026, 5:07:32 PM](#)

Contact Us

Developed by  
 **SCHNEIDER**  
GEOSPATIAL