

Christian County, KY PVA

Summary

Parcel Number 096-01-00-214.00
Property Address 116 ANDERSON ST S
Description 116 S ANDERSON ST
(Note: Not to be used on legal documents)
Class RESIDENTIAL (10)
Homestead No
Tax District 02-Crofton
Deed Book/Page 812-172



[View Map](#)

Owner

BARNETT RICHARD B & MARY K
 571 DRIPPING SPRINGS RD
 CROFTON, KY 42217

Forms

[Mailing Address Change Form](#)

[Data Correction Form](#)

Valuation

Assessed Year	2026	2025
	Working Tax Roll	Certified Tax Roll
Total Assessed Value	\$50,000.00	\$40,000.00
Farm Fair Cash Value		
Farm Taxable Value		
Exemption	Homestead: No	Homestead: No

Sales Information

Sale Date	Sale Price	Deed Book	Deed Page	Grantee	Grantor	Sale Type
2/21/2024	\$1	812	172	BARNETT RICHARD B & MARY K	BARNETT RENTAL PROPERTIES LLC	Affiliated Organizations (R)
8/24/2018	\$1	747	221	BARNETT RENTAL PROPERTIES LLC	BARNETT RICHARD B	Affiliated Organizations (R)

Land Information

[For more information regarding the Flood Zone in Christian County \(CLICK HERE\)](#)

Condition		Topography	Not Used
Plat Book/Page		Drainage	
Subdivision		Flood Hazard	
Lot		Zoning	Residential
Block		Electric	No
Acres	0.00	Water	No
Front	0	Gas	No
Depth	0	Sewer	No
Lot Size	0x0	Road	2 Lane
Lot Sq Ft	0	Sidewalks	No
Shape		Information Source	

Improvement Information

Description HOUSE Single Family BARNETT RICHARD B & MARY K
Type Single Family
Year Built 0
Foundation Concrete Block
Basement BT-None, None
Exterior Vinyl
Bedrooms 2
Full Baths 1
Half Baths 0
Roof Cover RF-Asphalt Shingles
Condition None
Fireplace Yes

Heat Natural Gas
AC Central
Living Sqft 1388
Basement Sqft 0
Garage Sqft 0
Porch Sqft 0
Patio Sqft 0
Basement Finish BT-None, None
Structure 1 Story
Garage
Total Sqft 1388
Length 0
Width 0

Photos



Sketches

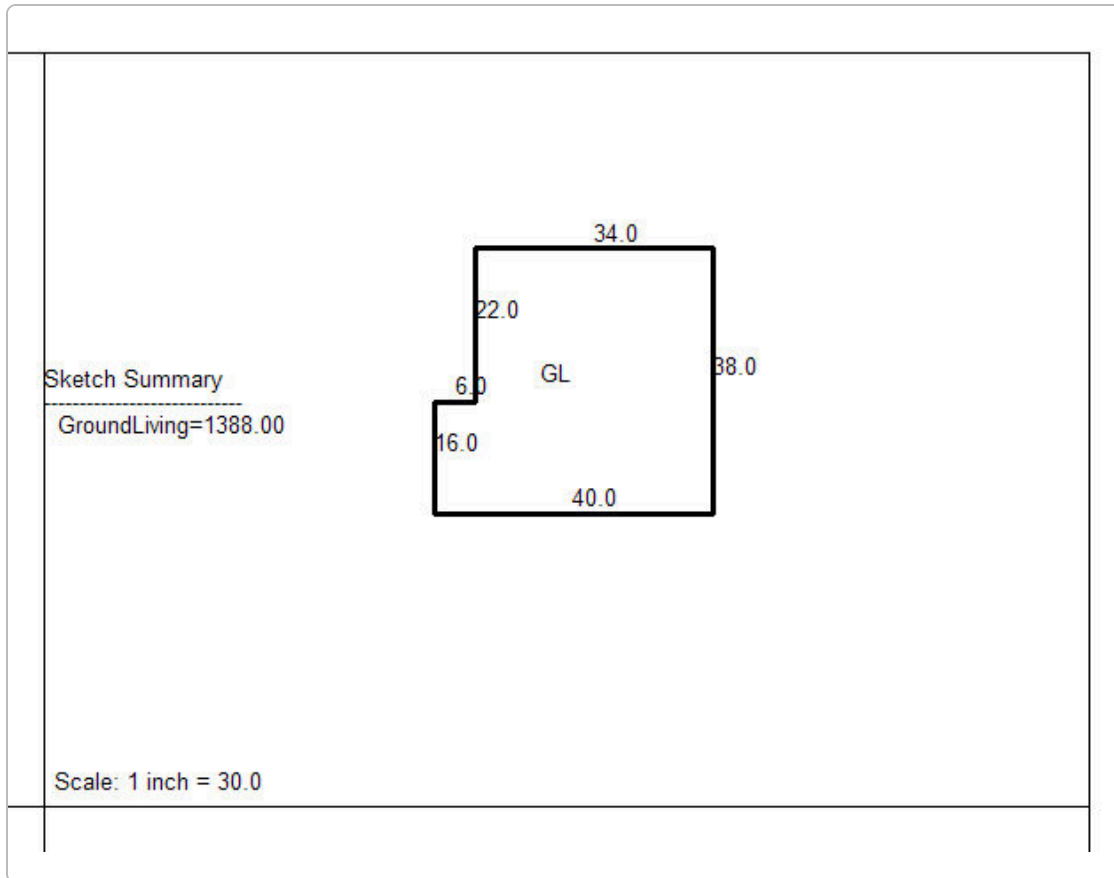

The Christian County Assessor's Office makes every effort to produce the most accurate information possible. No warranties, expressed or implied, are provided for the data herein, its use or interpretation.

| [User Privacy Policy](#) | [GDPR Privacy Notice](#)
[Last Data Upload: 5/28/2026, 4:03:23 AM](#)

Contact Us

Developed by
 **SCHNEIDER**
G E O S P A T I A L