

1640 Priceville Road, Gilbert, Lexington County, South Carolina, United States, 29054

Total area: 3585 sq. ft
Gross living area: 2856 sq. ft

Finished area: 2856 sq. ft
Non-standard finished area: 0 sq. ft

Level 1



Total area: 2163 sq. ft
Gross living area: 2163 sq. ft

Finished area: 2163 sq. ft
Non-standard finished area: 0 sq. ft

1640 Priceville Road, Gilbert, Lexington County, South Carolina, United States, 29054

Total area: 3585 sq. ft
Gross living area: 2856 sq. ft

Finished area: 2856 sq. ft
Non-standard finished area: 0 sq. ft

Level 1

Space	Area (sq. ft)	Calculation <small>Coordinate Polygon Area Algorithm using inches</small>
Finished Area • Living area • Finished Area	2163	$\begin{aligned} & -((461.2 + 496.6) * (427.9 - 463.7) + (496.6 + 496.6) * (463.7 - 538.9) + (496.6 + 705.4) * (538.9 - \\ & 538.9) + (705.4 + 705.4) * (538.9 - 476.8) + (705.4 + 858.3) * (476.8 - 476.8) + (858.3 + 858.3) * \\ & (476.8 - 909.1) + (858.3 + 713.4) * (909.1 - 909.1) + (713.4 + 713.4) * (909.1 - 924) + (713.4 + \\ & 557.4) * (924 - 924) + (557.4 + 557.4) * (924 - 892.1) + (557.4 + 479.5) * (892.1 - 892.1) + (479.5 \\ & + 479.5) * (892.1 - 924) + (479.5 + 339) * (924 - 924) + (339 + 339) * (924 - 909.1) + (339 + \\ & 112.1) * (909.1 - 909.1) + (112.1 + 112.1) * (909.1 - 806.3) + (112.1 + -0.1) * (806.3 - 806.3) + \\ & (-0.1 + -0.1) * (806.3 - 629.7) + (-0.1 + 5.6) * (629.7 - 629.7) + (5.6 + 130.6) * (629.7 - 629.7) + \\ & (130.6 + 130.6) * (629.7 - 629.6) + (130.6 + 5.9) * (629.6 - 629.6) + (5.9 + 5.9) * (629.6 - 623.6) + \\ & (5.9 + 339) * (623.6 - 623.6) + (339 + 339) * (623.6 - 519.2) + (339 + 288.9) * (519.2 - 519.2) + \\ & (288.9 + 288.9) * (519.2 - 427.9) + (288.9 + 461.2) * (427.9 - 427.9)) * 0.5 * 0.00694 \end{aligned}$
GARAGE • Attached Garage	1216	$\begin{aligned} & -((339 + 339) * (353.9 - 427.9) + (339 + 288.9) * (427.9 - 427.9) + (288.9 + 288.9) * (427.9 - \\ & 519.2) + (288.9 + 339) * (519.2 - 519.2) + (339 + 339) * (519.2 - 623.6) + (339 + 5.9) * (623.6 - \\ & 623.6) + (5.9 + 5.9) * (623.6 - 353.9) + (5.9 + 339) * (353.9 - 353.9)) * 0.5 * 0.00694 + -((339 + \\ & 339) * (78 - 347.9) + (339 + 5.9) * (347.9 - 347.9) + (5.9 + 5.9) * (347.9 - 78) + (5.9 + 339) * (78 - \\ & 78)) * 0.5 * 0.00694 \end{aligned}$

1640 Priceville Road, Gilbert, Lexington County, South Carolina, United States, 29054

Total area: 3585 sq. ft
Gross living area: 2856 sq. ft

Finished area: 2856 sq. ft
Non-standard finished area: 0 sq. ft

Level 2

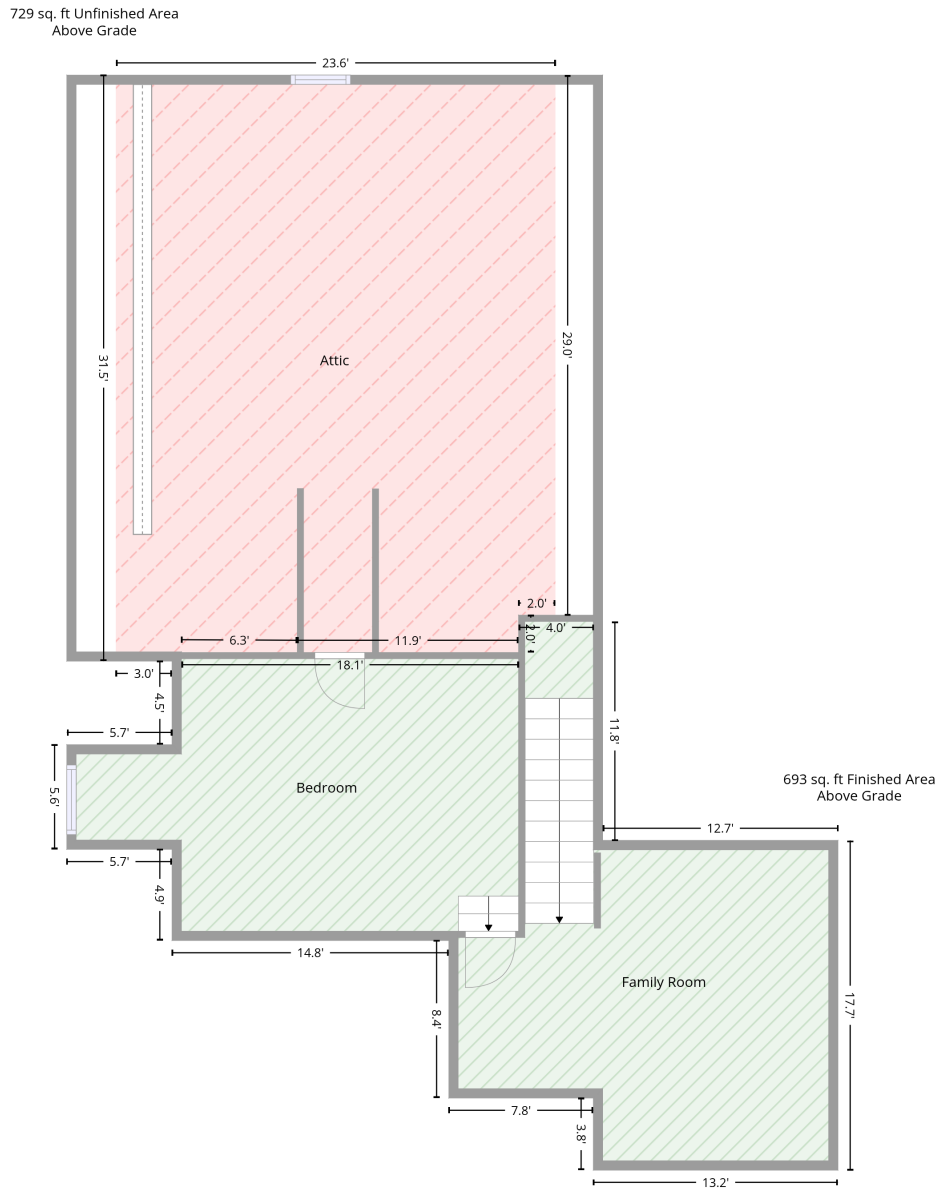

Total area: 1422 sq. ft
Gross living area: 693 sq. ft

Finished area: 693 sq. ft
Non-standard finished area: 0 sq. ft

1640 Priceville Road, Gilbert, Lexington County, South Carolina, United States, 29054

Total area: 3585 sq. ft
Gross living area: 2856 sq. ft

Finished area: 2856 sq. ft
Non-standard finished area: 0 sq. ft

Level 2

Space	Area (sq. ft)	Calculation <small>Coordinate Polygon Area Algorithm using inches</small>
Finished Area <ul style="list-style-type: none">• Living area• Finished Area	693	$-((339 + 339) * (420 - 424) + (339 + 345) * (424 - 424) + (345 + 345) * (424 - 565.1) + (345 + 496.6) * (565.1 - 565.1) + (496.6 + 496.6) * (565.1 - 777.6) + (496.6 + 339) * (777.6 - 777.6) + (339 + 339) * (777.6 - 731.1) + (339 + 246) * (731.1 - 731.1) + (246 + 246) * (731.1 - 629.6) + (246 + 67.7) * (629.6 - 629.6) + (67.7 + 67.7) * (629.6 - 570.9) + (67.7 + -0.1) * (570.9 - 570.9) + (-0.1 + -0.1) * (570.9 - 503.4) + (-0.1 + 67.7) * (503.4 - 503.4) + (67.7 + 67.7) * (503.4 - 449.6) + (67.7 + 73.7) * (449.6 - 443.6) + (73.7 + 73.7) * (443.6 - 444) + (73.7 + 290.9) * (444 - 444) + (290.9 + 290.9) * (444 - 420) + (290.9 + 339) * (420 - 420)) * 0.5 * 0.00694$
ATTIC <ul style="list-style-type: none">• Non-living area• Unfinished Area	729	$-((314.6 + 314.6) * (72 - 420) + (314.6 + 290.9) * (420 - 420) + (290.9 + 290.9) * (420 - 444) + (290.9 + 148.4) * (444 - 444) + (148.4 + 73.7) * (444 - 443.7) + (73.7 + 73.5) * (443.7 - 443.6) + (73.5 + 67.7) * (443.6 - 449.6) + (67.7 + 31.5) * (449.6 - 449.6) + (31.5 + 31.5) * (449.6 - 72) + (31.5 + 314.6) * (72 - 72)) * 0.5 * 0.00694$

1640 Priceville Road, Gilbert, Lexington County, South Carolina, United States, 29054

Total area: 3585 sq. ft
Gross living area: 2856 sq. ft

Finished area: 2856 sq. ft
Non-standard finished area: 0 sq. ft

Property UPD

Data	Value
Structure	1
Unit	1
Level Number	1
Below Grade	false
Level Low Ceiling	false
ADU Indicator	false
Total Area	2163
Finished Area	2163
Non-Standard Finished Area	0
Structure	1
Unit	1
Level Number	2
Below Grade	false
Level Low Ceiling	false
ADU Indicator	false
Total Area	1422
Finished Area	693
Non-Standard Finished Area	0