

14 AC | Norfolk Lake  
Tracts 1 & 2, Rocky Ridge Road  
Mountain Home, AR 72653

**\$169,000**  
14± Acres  
Baxter County

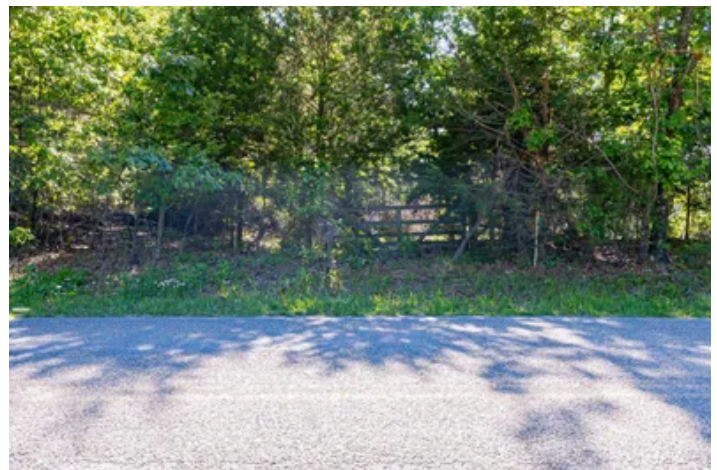
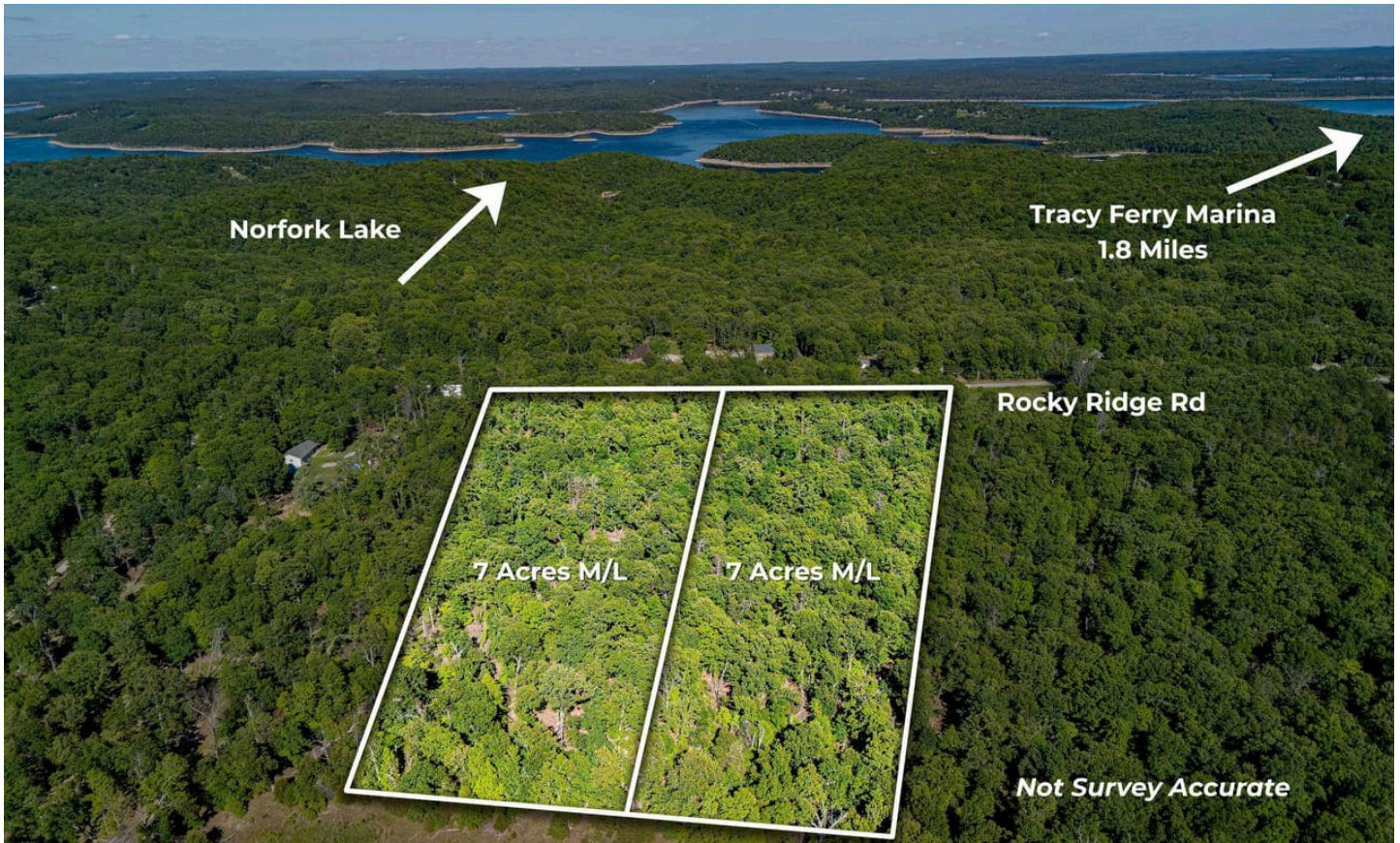

**14 AC | Norfolk Lake**  
**Mountain Home, AR / Baxter County**

---

**SUMMARY**

**Address**

Tracts 1 & 2, Rocky Ridge Road

**City, State Zip**

Mountain Home, AR 72653

**County**

Baxter County

**Type**

Undeveloped Land

**Latitude / Longitude**

36.323094 / -92.282419

**Acreage**

14

**Price**

\$169,000

**Property Website**

<https://www.mossoakproperties.com/property/14-ac-norfolk-lake-baxter-arkansas/106198/>



**PROPERTY DESCRIPTION**

**Wooded 14-acre m/l property ready for you to make it your own! Roughly 600 ft of paved county road frontage/access, this versatile tract offers multiple potential building sites with plenty of privacy and room to spread out.**

Enjoy abundant wildlife and peaceful country surroundings while still being conveniently located just minutes from Norfolk Lake, Tracy Ferry Marina & boat launch, and only 10 minutes from Mountain Home and the world-famous Norfolk River.

**No building restrictions, giving you flexibility for your dream home, cabin, or getaway retreat. Mobile homes not allowed.**

Property is also being offered in 7-acre tracts for \$89,000 each.

14 AC | Norfolk Lake  
Mountain Home, AR / Baxter County



## Locator Map

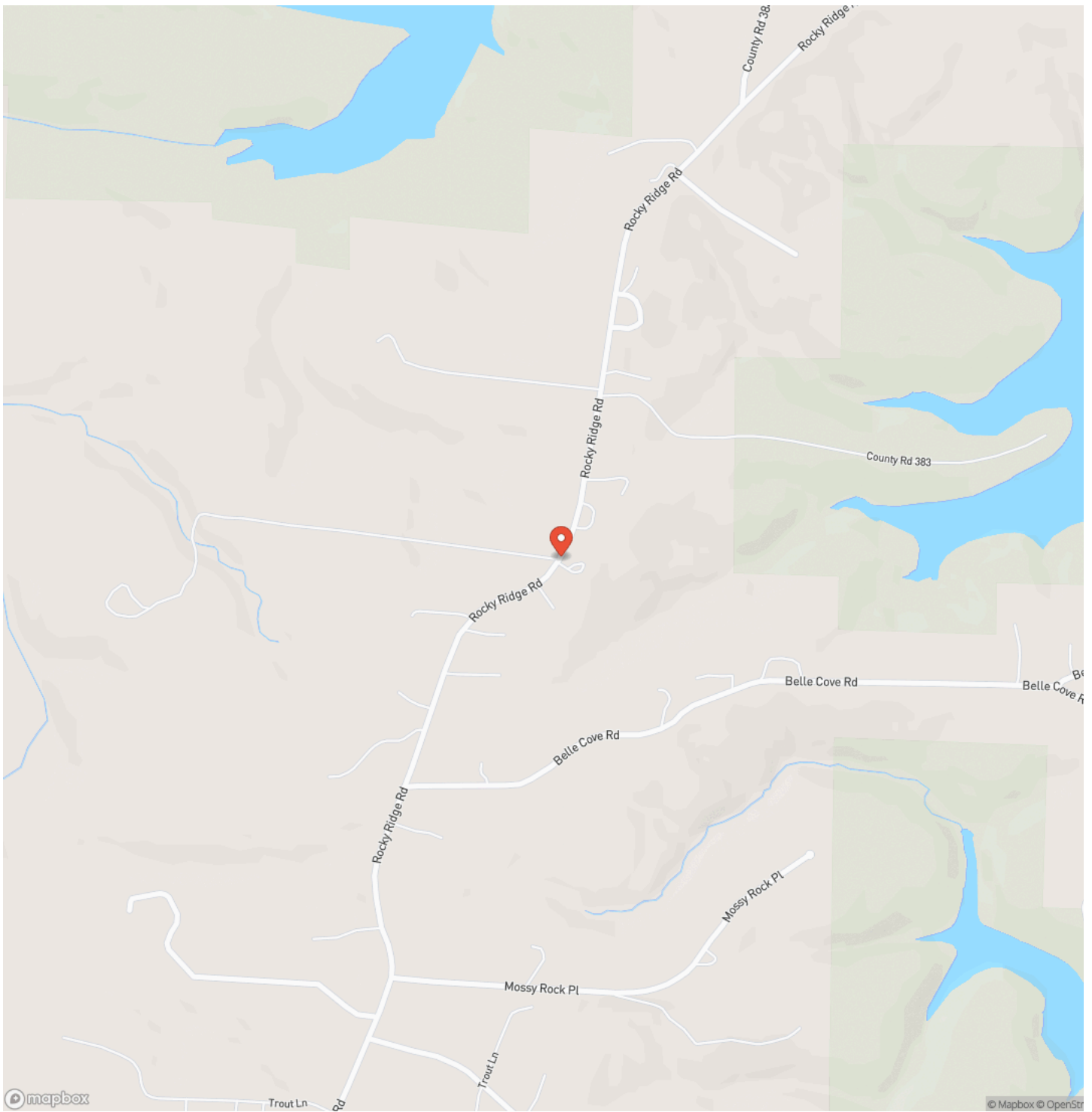

# Locator Map

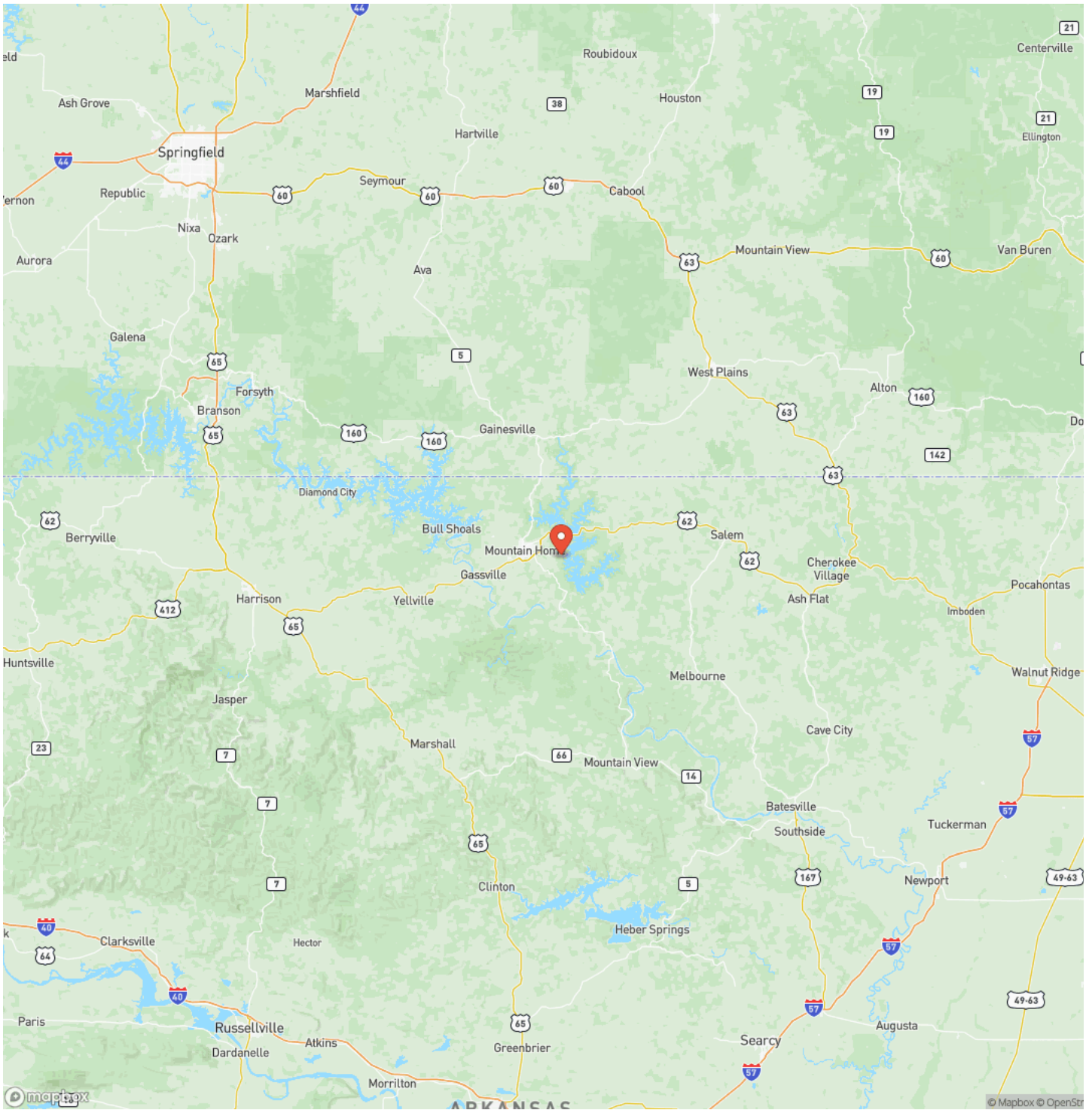

## Satellite Map







## **DISCLAIMERS**

Information in this brochure is provided solely for information purposes and does not constitute an offer to sell or advertise real estate outside the states in which broker or agent licensed. The information presented has been obtained from sources deemed to be reliable, but is not guaranteed or warranted by the agent, broker, or the sellers of these properties. This offering is subject to errors, omissions, prior sale, price change, correction or withdrawal from the market without notice. All references to age, square footage, income, expenses, acreage, carrying capacity, and land classification, etc. are approximate. Prospective buyers are chargeable with and expected to conduct their own independent investigation of the information and the property and to rely only on those results. Sellers reserve the right to accept or reject any and all offers without liability to any buyer or cooperating broker.

Maps are provided for illustration purposes only, the accuracy is not warranted. Parcels on interactive maps are not adjusted to match aerial backgrounds. This information is for reference purposes only and is not a legal document. Data maps contain errors. The seller and seller's agent are making known to all potential buyers that there may be variations between the location of the existing fence lines and the legal description of the deeded property. Seller and seller's agent make no warranties with regard to the location of the fence lines in relationship to the deeded property lines, nor does the Seller make any warranties or representations with regard to the specific acreage contained within the fenced property lines. Seller is selling the property in an "as is" condition, which includes the location of the fences as they exist. Boundaries shown on the accompanying maps are approximate, based on county parcel data. The maps are not to scale. The accuracy of the maps is not guaranteed. Prospective buyers are encouraged to verify fence lines, deeded property lines and acreages using a licensed surveyor at their own expense.

---

**Mossy Oak Properties Field, Farm, and Homes**

1200 Fort Street

Barling, AR 72923

(479) 480-7000

<https://www.mossyoakproperties.com/>

---

