

Soils Map

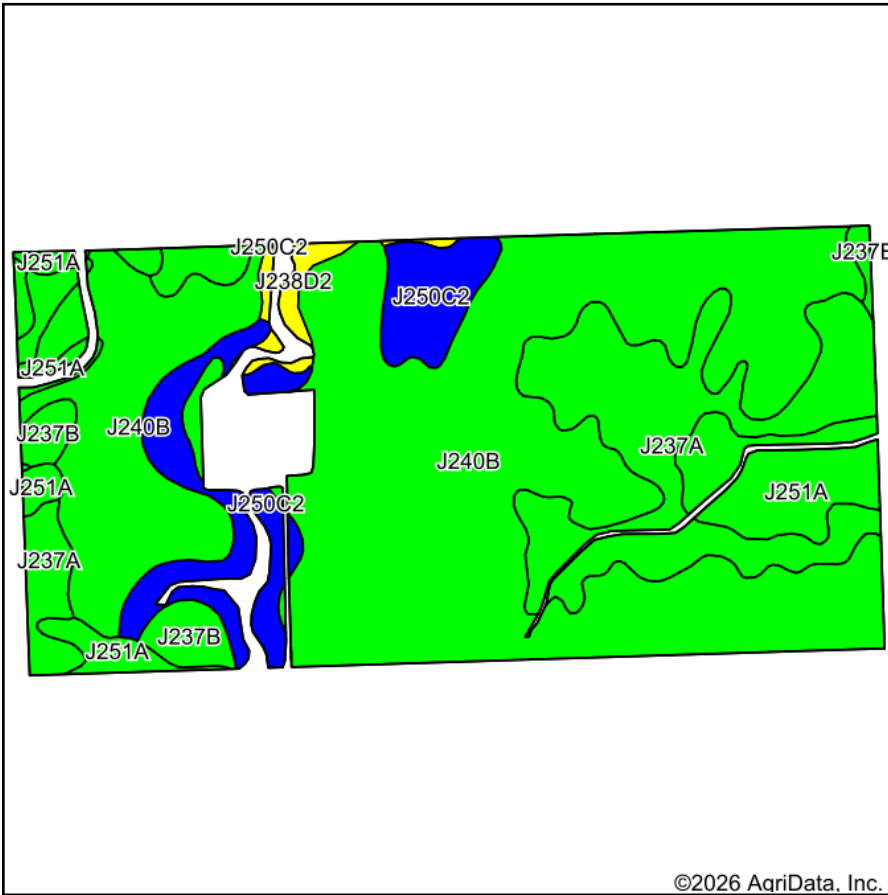

Soils data provided by USDA and NRCS.

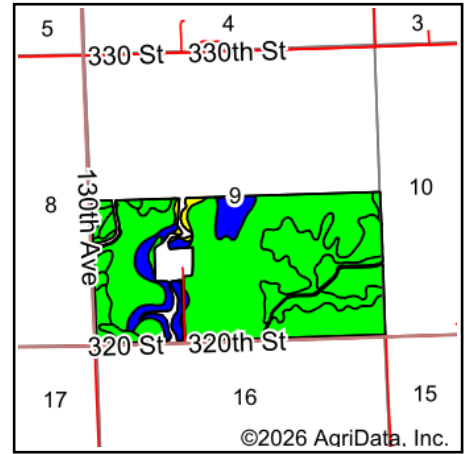



State: **Minnesota**
 County: **Lyon**
 Location: **9-112N-43W**
 Township: **Nordland**
 Acres: **296.64**
 Date: **3/4/2026**

Maps Provided By:

 CUSTOMIZED ONLINE MAPPING
 © AgriData, Inc. 2025 www.AgriDataInc.com

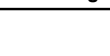

Area Symbol: MN083, Soil Area Version: 22

Code	Soil Description	Acres	Percent of field	PI Legend	Non-Irr Class *c	Productivity Index
J240B	Forman, occasional saturation-Aastad loams, 1 to 6 percent slopes	177.17	59.7%		Ile	94
J237A	Brensall-Tress complex, 0 to 2 percent slopes	52.60	17.7%		Iw	95
J250C2	Forman-Buse complex, 6 to 12 percent slopes, moderately eroded	26.58	9.0%		IIIe	81
J251A	Parnell silty clay loam, firm till, 0 to 2 percent slopes	23.60	8.0%		IIw	94
J237B	Brensall-Tress complex 1 to 4 percent slopes	12.74	4.3%		Ile	95
J238D2	Buse, firm till-Wilno complex, 12 to 18 percent slopes	3.95	1.3%		IVe	63
Weighted Average					1.94	92.6

*c: Using Capabilities Class Dominant Condition Aggregation Method