

# Soils Map

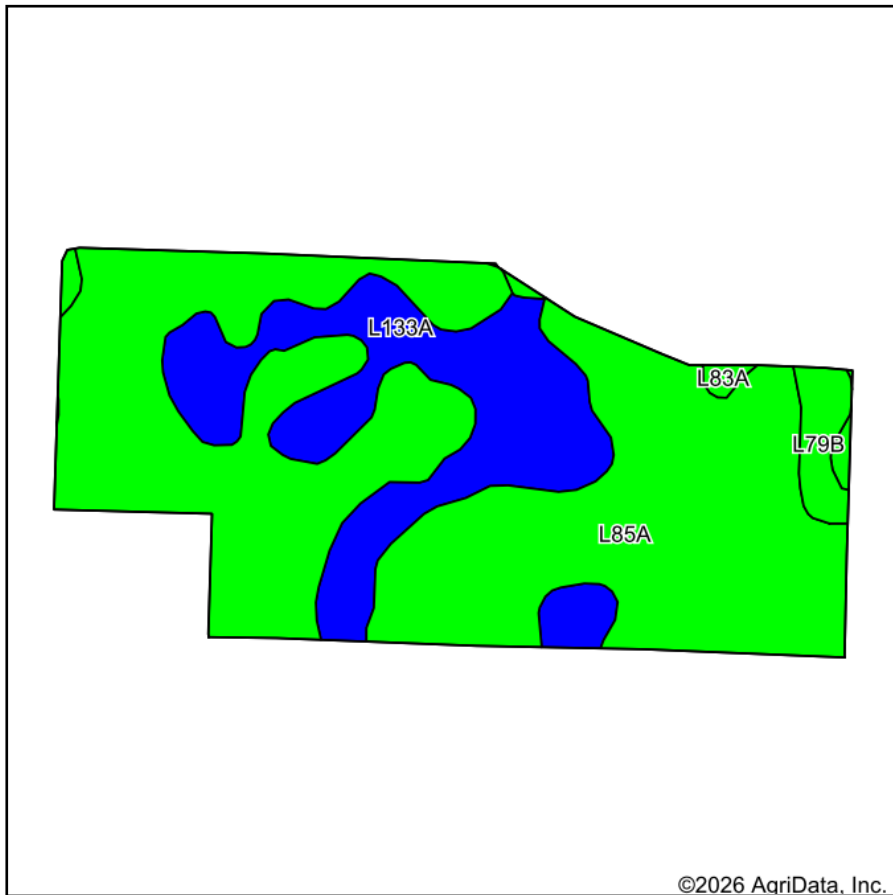

Soils data provided by USDA and NRCS.

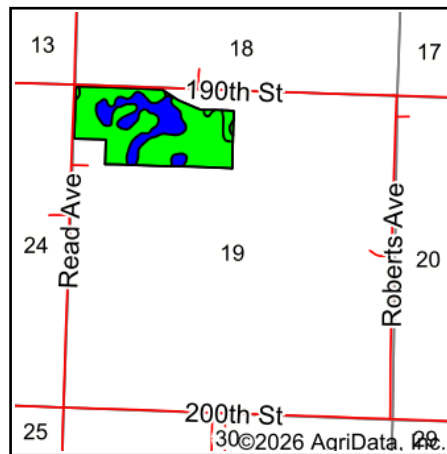





State: **Minnesota**  
 County: **Nobles**  
 Location: **19-103N-39W**  
 Township: **Hersey**  
 Acres: **63.9**  
 Date: **4/27/2026**

Maps Provided By:  
  
 CUSTOMIZED ONLINE MAPPING  
 © AgriData, Inc. 2025 www.AgriDataInc.com



Area Symbol: MN105, Soil Area Version: 24

Code	Soil Description	Acres	Percent of field	PI Legend	Non-Irr Class *c	Productivity Index
L85A	Nicollet clay loam, 1 to 3 percent slopes	45.95	71.9%		lw	99
L133A	Waldorf silty clay loam, 0 to 2 percent slopes	15.42	24.1%		llw	85
L79B	Clarion loam, 2 to 6 percent slopes	1.64	2.6%		lle	95
L83A	Webster clay loam, 0 to 2 percent slopes	0.89	1.4%		llw	93
<b>Weighted Average</b>					<b>1.28</b>	<b>95.4</b>

\*c: Using Capabilities Class Dominant Condition Aggregation Method