

# Soils Map

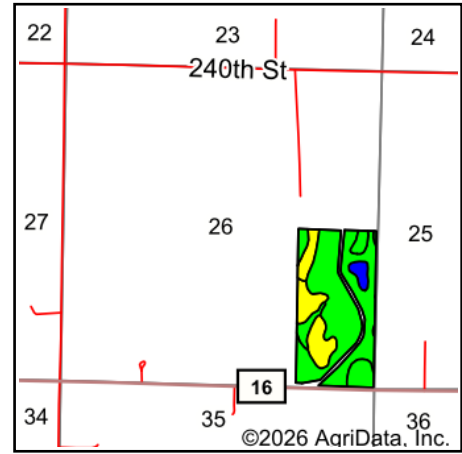

State: **Minnesota**  
 County: **Redwood**  
 Location: **26-111N-35W**  
 Township: **Three Lakes**  
 Acres: **74.16**  
 Date: **4/2/2026**







Maps Provided By:  
  
 CUSTOMIZED ONLINE MAPPING  
 © AgriData, Inc. 2025 www.AgriDataInc.com



Soils data provided by USDA and NRCS.

©2026 AgriData, Inc.

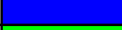
Area Symbol: MN127, Soil Area Version: 24

Code	Soil Description	Acres	Percent of field	PI Legend	Non-Irr Class *c	Productivity Index
86	Canisteo clay loam, 0 to 2 percent slopes	48.43	65.3%		IIw	93
999C2	Storden-Estherville-Ves loams, 6 to 12 percent slopes, eroded	9.76	13.2%		IIIe	63
999B2	Ves-Estherville-Storden complex, 3 to 6 percent slopes, eroded	4.84	6.5%		Ile	69
L201A	Normania loam, 1 to 3 percent slopes	4.13	5.6%		Ie	99
L83A	Webster clay loam, 0 to 2 percent slopes	2.73	3.7%		IIw	93
L84A	Glencoe clay loam, 0 to 1 percent slopes	2.48	3.3%		IIIw	86
423	Seaforth loam, 1 to 3 percent slopes	1.79	2.4%		IIIs	95
<b>Weighted Average</b>					<b>2.11</b>	<b>87.6</b>

\*c: Using Capabilities Class Dominant Condition Aggregation Method

Soils data provided by USDA and NRCS.