

Building Sketch (Page - 1)

Borrower	David & Kathleen Walsh						
Property Address	302 Green Rd						
City	Malvern	County	Hot Spring	State	AR	Zip Code	72104
Lender/Client	Coleman County State Bank						

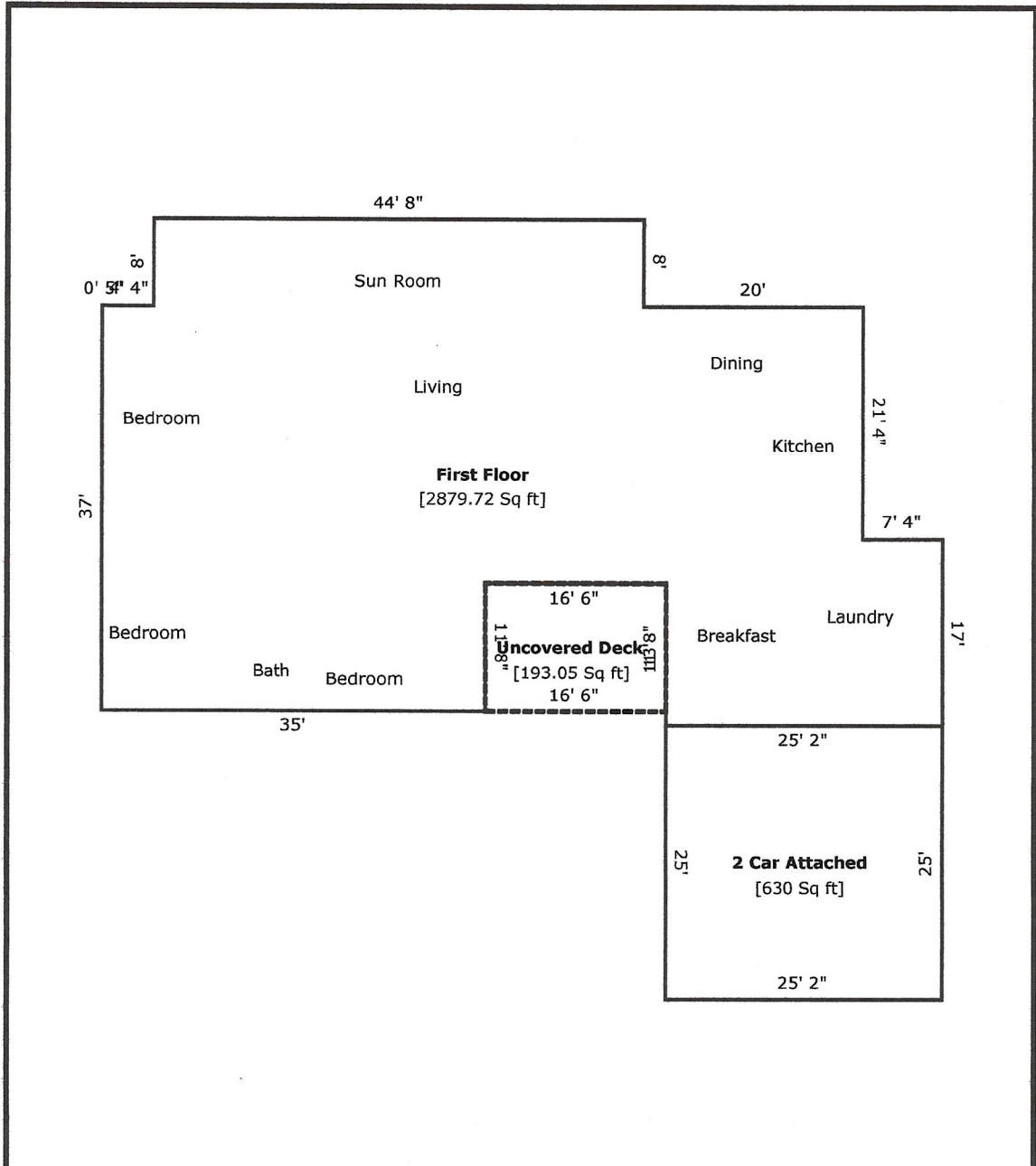

TOTAL Sketch by a la mode, inc.		Area Calculations Summary	
Living Area		Calculation Details	
First Floor	2879.72 Sq ft	44.7 × 8	= 357.6
		37 × 35	= 1295
		25.3 × 16.5	= 417.45
		17.9 × 21.3	= 381.27
		17 × 25.2	= 428.4
Total Living Area (Rounded):	2880 Sq ft		
Non-living Area			
Uncovered Deck	193.05 Sq ft	11.7 × 16.5	= 193.05
2 Car Attached	630 Sq ft	25 × 25.2	= 630

Building Sketch (Page - 2)

Borrower	David & Kathleen Walsh				
Property Address	302 Green Rd				
City	Malvern	County	Hot Spring	State	AR Zip Code 72104
Lender/Client	Coleman County State Bank				

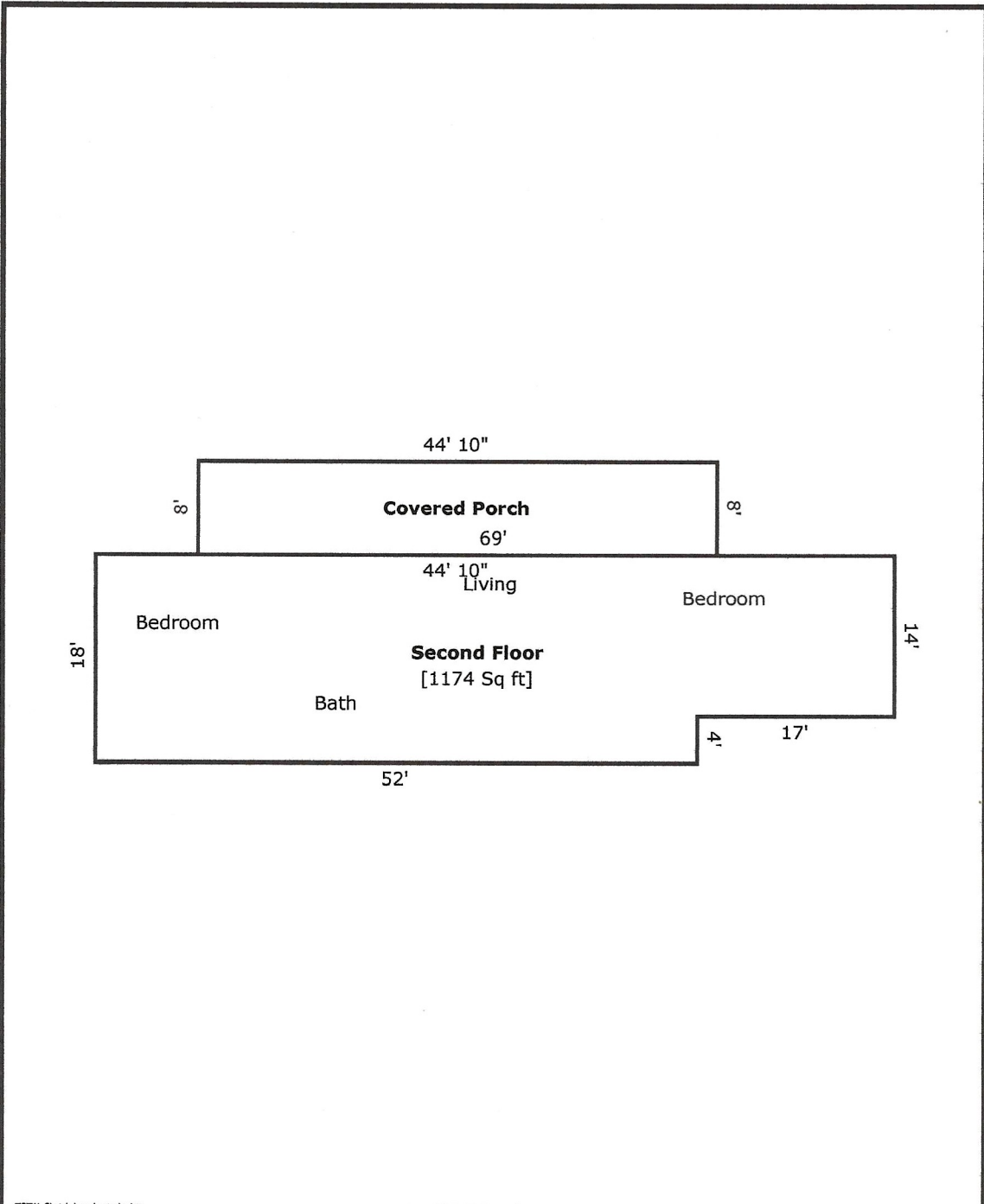

TOTAL Sketch by a la mode, inc.

Area Calculations Summary		
Living Area		Calculation Details
Second Floor	1174 Sq ft	14 x 17 = 238 52 x 18 = 936
Total Living Area (Rounded):	1174 Sq ft	
Non-living Area		
Covered Porch	358.4 Sq ft	44.8 x 8 = 358.4